

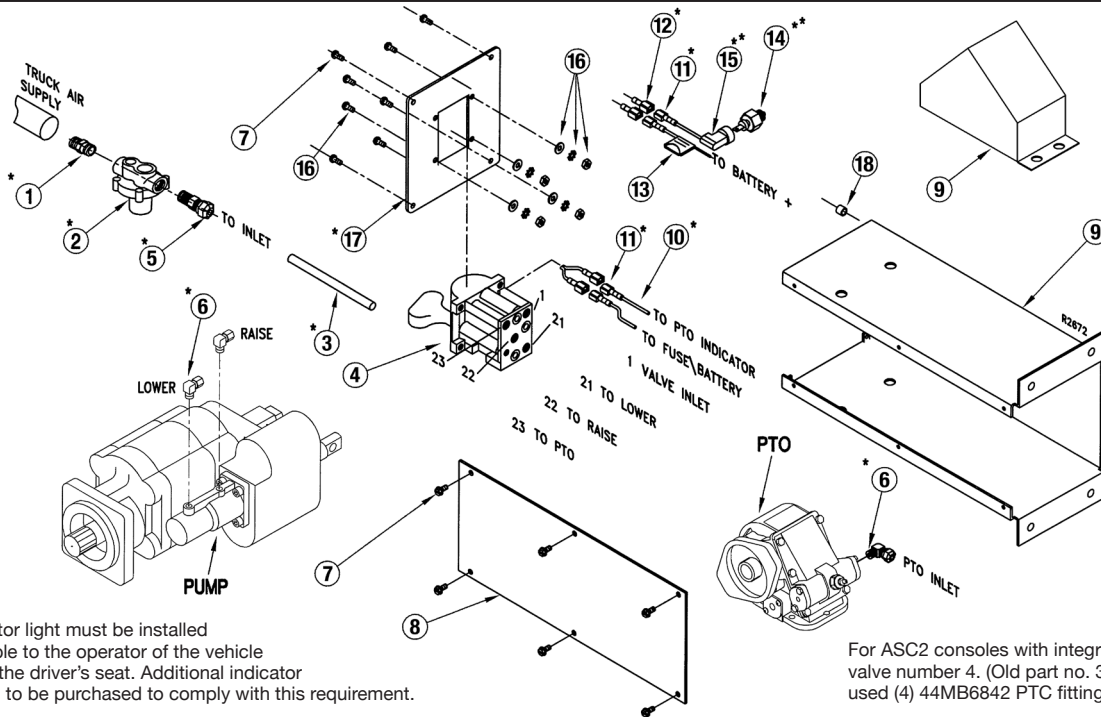

**Muncie®
Power
Products**

ASC SERIES DUMP PUMP CONSOLE

PARTS LIST AND SERVICE MANUAL



The PTO indicator light must be installed so that it is visible to the operator of the vehicle while seated in the driver's seat. Additional indicator lights may need to be purchased to comply with this requirement.

For ASC2 consoles with integral air fittings in air valve number 4. (Old part no. 35T38825-xxxx used (4) 44MB6842 PTC fitting (not shown).

PARTS LIST AND DESCRIPTION

ITEM	QTY	PART NO.	DESCRIPTION
1*	1	44MB2164	Nipple
2*	1	31M15759	Pressure Protection Valve
3*	1	45M44430	Tubing 30 ft.
Air valve is described in the last 4 characters in the air console kit No.			
4a	1	35T40821-AXDX	PTO Auto KO, center detent
4b	1	35T40821-MXDX	PTO Man KO, center detent
4c	1	35T40821-AXDD	PTO Auto KO, center & lower detent
4d	1	35T40821-MXDD	PTO Man KO, center & lower detent
4e	1	35T40821-ADDD	PTO Auto KO, 3 Pos. detent
4f	1	35T40821-MDDD	PTO Man KO, 3 Pos. detent
5*	1	44MB6844PTC	Tube fitting, push to connect
6*	3	44MB6942PTC	Tube fitting elbow, push to connect
7	4	19T36355	Self Tap Screw, AC1-C, D, E, F, G, H, & J
7	6	19T36355	Self Tap Screw, AC1-A & B
7	4	19M08075	Self Tap Screw, AC1-A, B, C, D, E, F, G, & H
Console housings & cover plates dependent upon air console kit no.			
8a & b	1	57T36654	Cover Plate (5 × 12) AC1-A & B
8c	1	57T38844-8	Cover Plate (3 × 8 in.) AC1-C
8d	1	57T38844-13	Cover Plate (3 × 13 in.) AC1-D
8e	1	57T38843-8	Cover Plate (10 × 8 in.) AC1-E
8f	1	57T38843-13	Cover Plate (10 × 13 in.) AC1-F
8g	1	57T38843-4	Cover Plate (10 × 4 in.) AC1-G
8h	1	57T38844-4	Cover Plate (3 × 4 in.) AC1-H
Note: Console housings will vary in shape and size from actual drawing			

ITEM	QTY	PART NO.	DESCRIPTION
9a & b	1	57T36653	Console Housing (5 × 5) AC1-A&B
9c	1	57T38870-8	Console Housing (3sq × 8 in.) AC1-C
9d	1	57T38870-13	Console Housing (3sq × 13 in.) AC1-D
9e	1	57T38882-8	Console Housing (10 × 8 in.) AC1-E
9f	1	57T38882-13	Console Housing (10 × 13 in.) AC1-F
9g	1	57T38882-4	Console Housing (10 × 4 in.) AC1-G
9h	1	57T38870-4	Console Housing (3 × 4 in.) AC1-H
9j	1	57T39260	Console Housing (Angle Mnt.) AC1-J
10*	12	37M18000	18 Ga. Wire/ft.
11*	3	PM514A	Terminal
12*	3	PM513A	Spade Terminal
13	1	33T36299	Fuse Assembly
14**	1	NA	PTO Indicator Switch
15**	1	NA	Booted Connector
16	1	36MK1007	Bolt Kit (not used with AC1-C&D)
Faceplates dependent upon air console kit number			
17a	1	36T38892	Faceplate-centered (5 × 5) AC1-A
17b	1	36T38891	Faceplate-offset (5 × 5) AC1-B
17c & d	1	36T38987	Faceplate (3 × 3) AC1-C, D, & X
17e & f	1	36T38890	Faceplate (3 × 10) AC1-E & F
18	2	23T38894	Spacer-Nylon, AC1-E, F, G, & H
N.S.*	2	08470	Cable Tie
N.S.*	5	1416AC	Grommet
N.S.	1	36T38893	Decal AC1-J
* In ASC2 air installation kit 48T40826. (Old ASC1 Air Kit was 48T38898) ** Shipped with PTO			

ASC INSTALLATION INSTRUCTION TIPS ARE ON REVERSE SIDE.

ASC INSTALLATION INSTRUCTION TIPS

- Install the air shift controller up through the underside of the faceplate.
- Make all electrical and pneumatic connections before installing side panel.
- The side panel will face away from the driver's seat for easy removal.
- Do not tighten faceplate screws completely until side panel is installed and all six mounting screws are tightened.
- Mounting bolts to secure the console to the vehicle cab floor not provided.
- When drilling the faceplate for accessory components, layout pattern using a paper template (not provided) or the actual part to be installed.



**Muncie®
Power
Products**

A Member of the Interpump Group

SP02-02 (Rev. 09-22)

201 East Jackson Street, Muncie, Indiana 47305
800-367-7867 • Fax: 765-284-6991 • info@munciepower.com

Specifications are subject to change without notice. Visit www.munciepower.com
for warranties and literature. All rights reserved. © Muncie Power Products, Inc. (2007)