

SS66 SPLIT SHAFT

POWER TAKE-OFF



Two outputs for auxiliary power

SS66 Series split shaft PTOs are used to provide two 6-bolt PTO apertures where none exist on the main transmission or where space limitations restrict access to the second transmission opening. Split shafts are designed to use the main vehicle driveshaft as their input and provide multiple outputs for auxiliary power equipment. When engaged, the main driveshaft is disconnected from the rear axle. The SS66 Series is typically used on chassis ranging up to Class 5.



KEY FEATURES

- Installs in the drive shaft between the transmission and the rear axle
- Throughput torque 2,900 lbs.ft. (400 KGM)
- Compact design with aluminum casting keeps weight to a minimum
- SAE 6-bolt openings to access one or two side-mounted PTOs to drive heavy-duty auxiliary equipment
- Wide selection of PTOs available. PTO series, ratios, and outputs can be different for each side. PTOs must be ordered separately. Refer to the Muncie Power Products application page MUNC-01 located in the Muncie Power QR Catalog.
- Auxiliary power can be transmitted while vehicle is in motion
- Main drive to the rear axle is controlled by air or cable, independently of PTO operation

MODEL NUMBER CONSTRUCTION

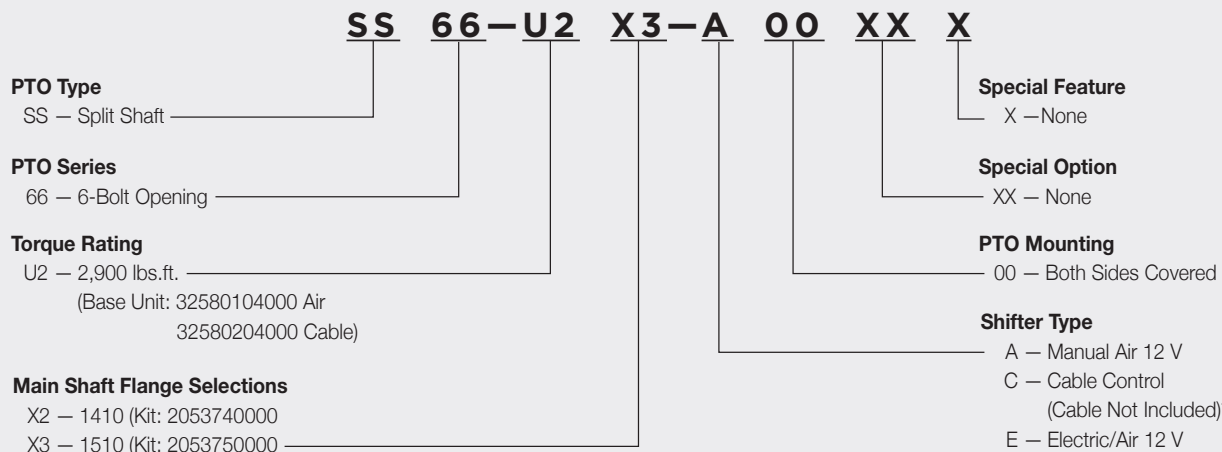

Approximate Weight: 20 lbs. (9.1 Kg.) w/o PTOs

Note:

* Order Control Cable separately 55 Series, 2" Travel, Bulkhead Mount. Example: KB55-BM-2-XXX
Optional elastic element mounting bracket 2991970000, sold separately.
Optional activation light switch kit, 194KSP17000.

DIMENSIONS

(WITH SPICE 1410-1500
DIN 20 FLANGE FITTED)

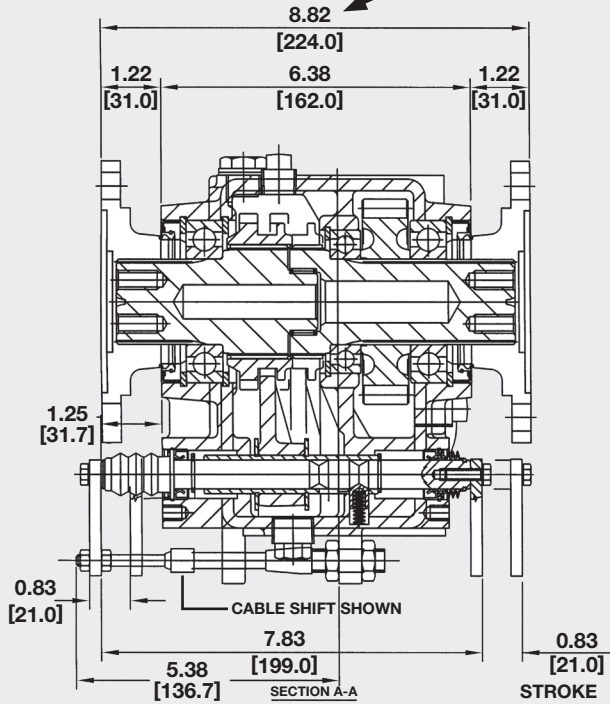

FRONT OF VEHICLE

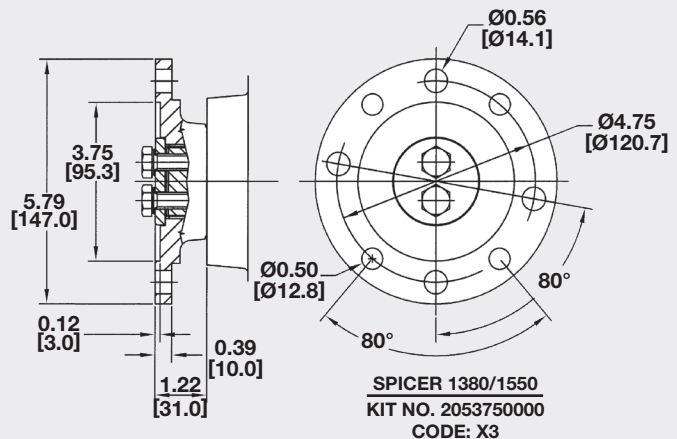
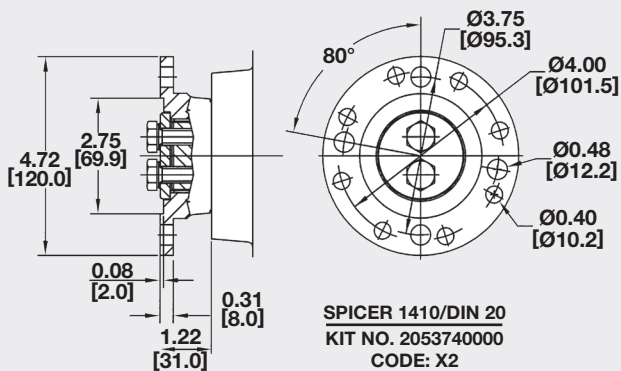
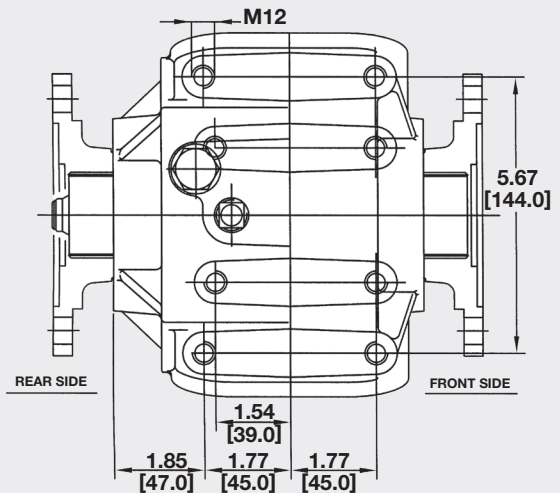
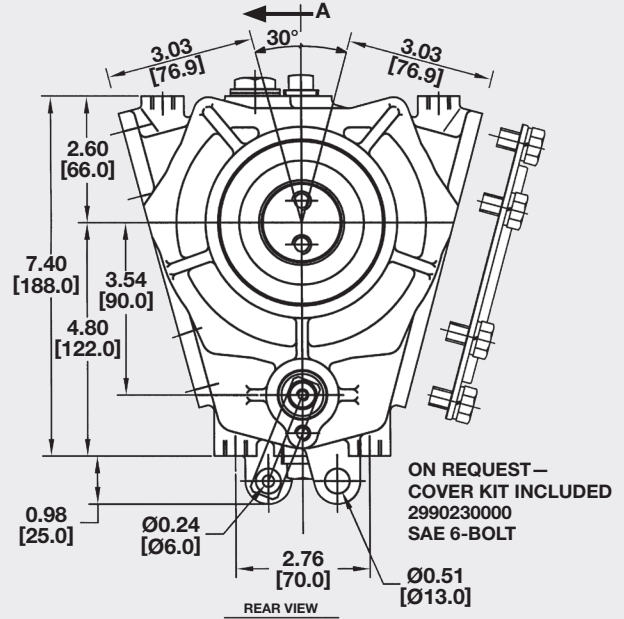
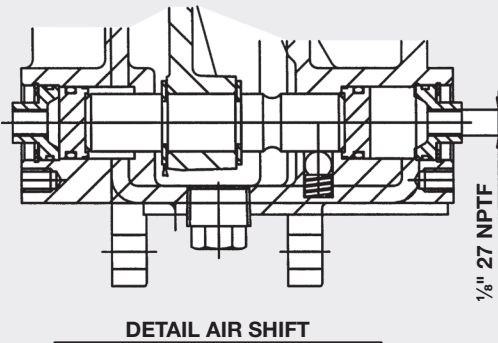

A Member of the Interpump Group

MP01-01 (Rev. 01-22)

201 East Jackson Street, Muncie, Indiana 47305
800-367-7867 • Fax: 765-284-6991 • info@munciepower.com

Specifications are subject to change without notice. Visit www.munciepower.com
for warranties and literature. All rights reserved. © Muncie Power Products, Inc. (2013)