

MUNCIE®

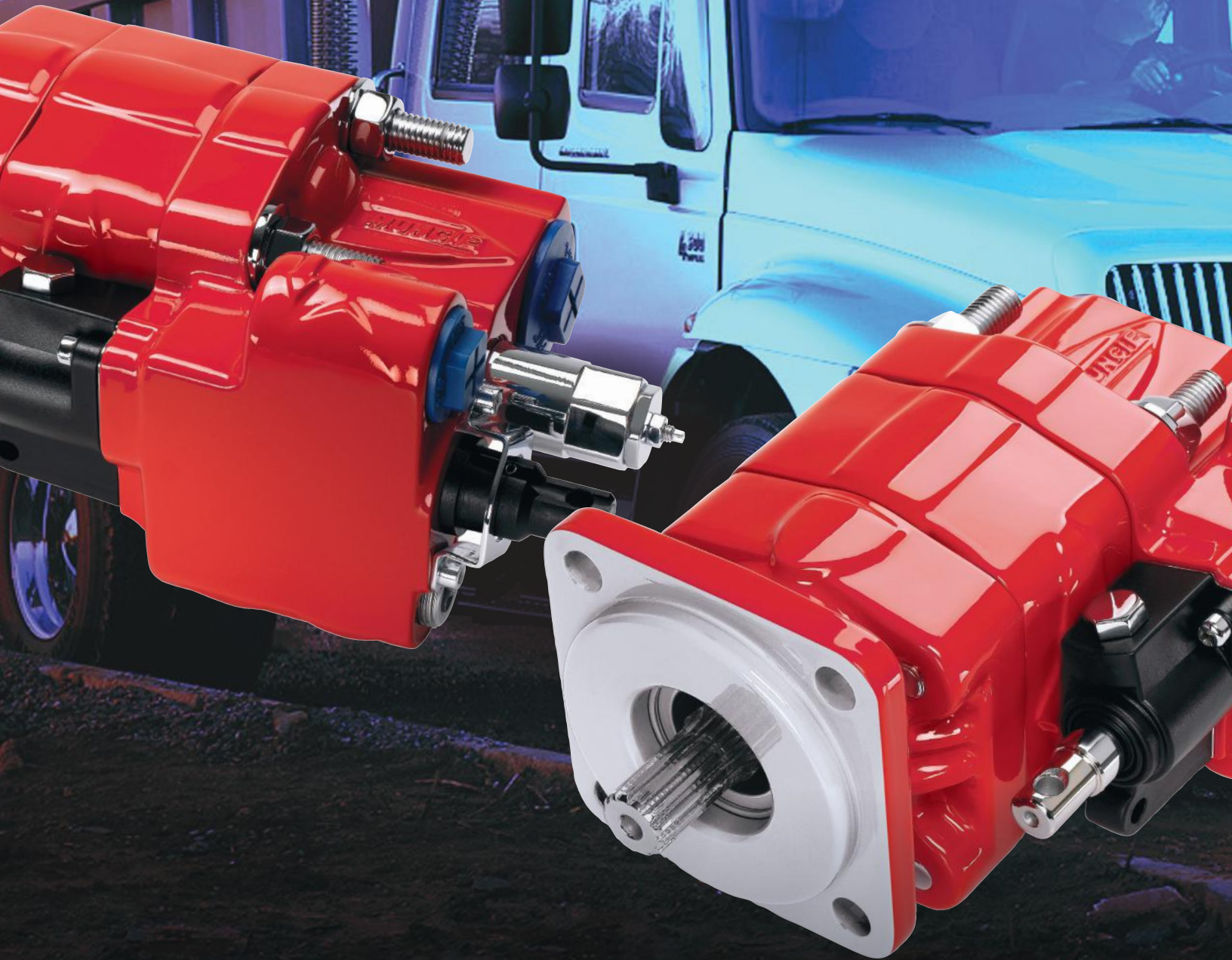

S SERIES

HOIST PUMPS

S SERIES HOIST PUMPS

The Muncie S Series of hoist pumps are designed for those small to medium duty size dump bodies. The integral pump and valve combination provides optimum control in a small lightweight package versus separate components.

Why use a 3-line Hoist System?

Many small hoists function quite adequately with a 2-line system. However, a 3-line system includes a separate line to return hydraulic oil from the cylinder directly to the reservoir instead of passing over the pump relief back to pump inlet.

The separate 3rd line is the best choice because the 3-line allows faster down cycles and ultimately runs cooler.

FEATURES:

- 6, 11, & 15 GPM SIZES
- PTO DIRECT MOUNT OR TWIN SHAFT REMOTE
- SINGLE OR DOUBLE ACTING VERSIONS
- PRESSURES TO 3000 PSI (207 BAR)
- SPEEDS TO 2500 RPM
- INTEGRAL VALVE FOR 2 OR 3 LINE SYSTEM
- ANTI PULL OUT SAFETY CAP
- BUILT IN SCREW ADJUST RELIEF VALVE WITH LOAD CHECK
- LONG ASSEMBLY STUDS FOR SUPPORT BRACKETS
- PORT I.D. CAP PLUGS AND CASTING STAMP
- OPTIONAL AIR OR CABLE SHIFTING
- INTERCHANGES WITH PARKER, PERMCO, AND OTHERS



MUNCIE S SERIES HOIST PUMPS

MODEL NUMBER CONSTRUCTION

S 2 L D 1* - 06 - 01 R P R B - 10

PUMP SERIES S

HOISTS/PORTING

- Single Acting, No Sleeve 2
- Single Acting, With Sleeve 3
- Double Acting, No Sleeve** 4
- Double Acting, With Sleeve** 5

LEVER SHIFT L

DETENT D*

SPRING RETURN S

DESIGN NO.

1 (single acting only)

GPM (LPM) @ 1000 RPM

	SA	DA
06 (23)	6 (23)	6 (23)
11 (42)	11 (42)	11 (42)
15 (57)	15 (57)	15 (57)

SHAFT SIZE & TYPE

	SA	DA
1" Rd. w/1/4" St. Key (25.4 w/6.35 Key)	01	1
7/8" - 13 Tooth Splined	02	2

PORT RELIEF

10—1000 PSI (69 BAR)
(D.A. Only)

ROTATION

- B—Bi-Rotation (01, R mount only)
- L—Counter Clockwise ←
- R—Clockwise ← (B mount only)

PORT LOCATION

R—Rear

PORT TYPE

P—Pipe Thread

TYPE OF MOUNTING

- B—SAE "B" - 4-Bolt
- R—Remote

* Not available on double acting version.

** Not available as Design No. 1

MOUNTING DIMENSION SINGLE ACTING

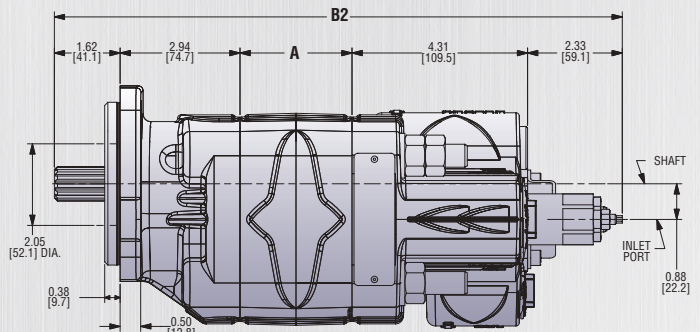
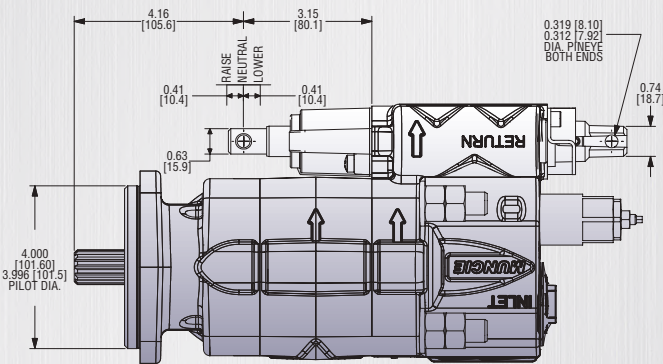
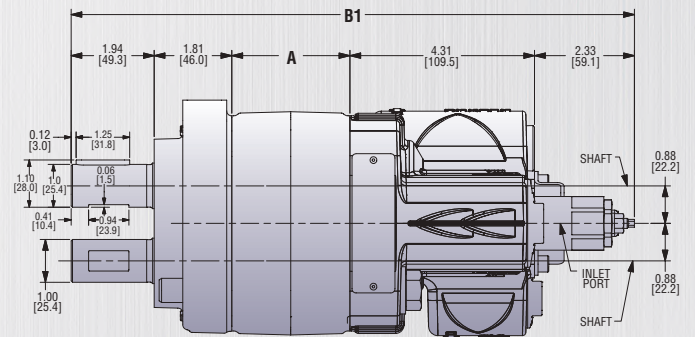
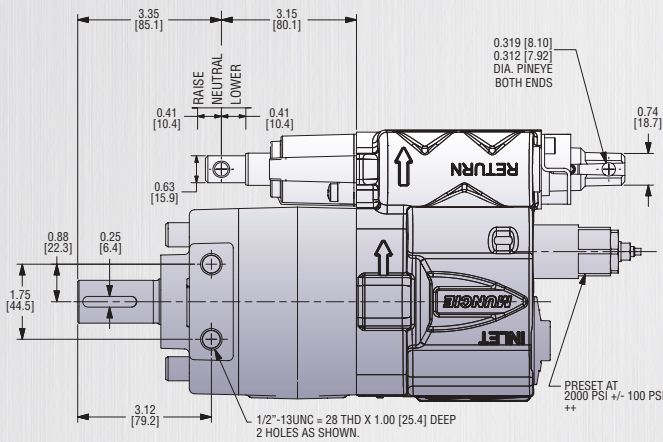

OVERALL LENGTHS

PUMP SIZE	DISPL. CU. IN. (CC)	DIM A IN (MM)	DIM B1 IN (MM)	DIM B2 IN (MM)	WEIGHT LB (KG)	MAX PSI (BAR)
6	1.47 (24)	1.50 (38.1)	11.32 (287.5)	12.12 (307.8)	32 (14.8)	3000 (207)**
11	2.46(40)	2.25 (57.2)	12.07 (306.6)	12.88 (327.2)	35 (15.9)	3000 (207)**
15	3.94(65)	2.75 (69.9)	12.57 (319.3)	13.38 (339.9)	38 (17.2)	2500 (172)

** Requires high pressure relief PS-1231VH for settings above 2500 PSI

Notes: DO NOT USE TEFLON TAPE ON PORTS.

Optional Air Shift Cylinder (ACM-400 or 402).

Optional Conversion Sleeve for 3-Line Hookup - Muncie Part No. AA1257.

Tank return line must be below oil level at all times.

Maximum inlet vacuum is 5 in. hg. (-17 BAR).

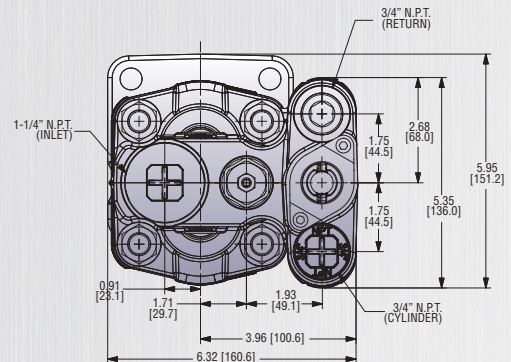

Muncie Power Products, Inc.

MOUNTING DIMENSION DOUBLE ACTING

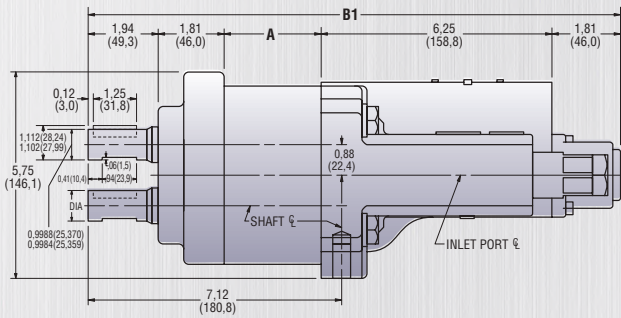
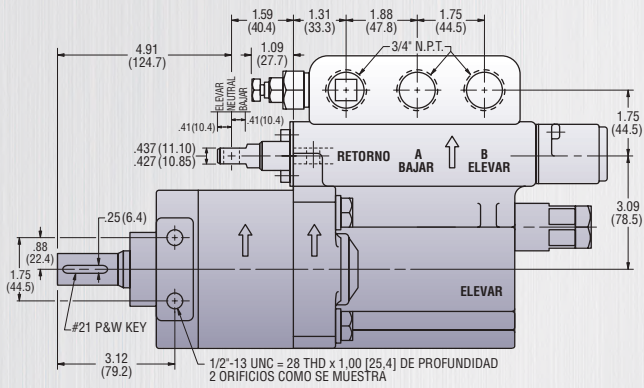

EXAMPLE PART NO.: S*LS*-1RPRB-10

- * - Hoist porting code 4.5
- * - Pump sizes 6, 11 or 15

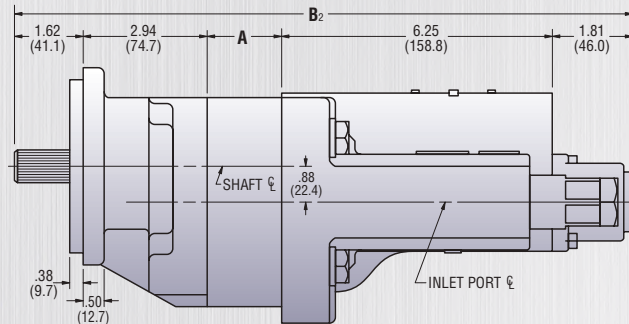
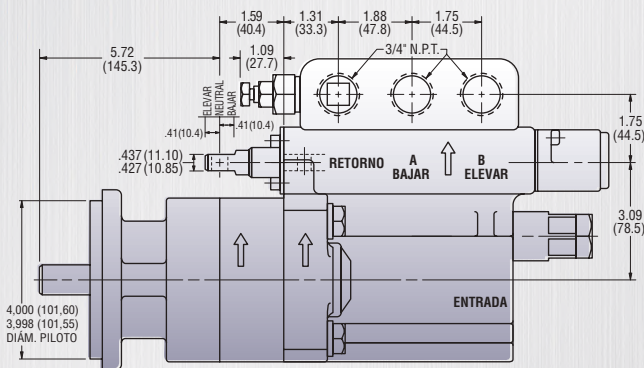

EXAMPLE PART NO.: S*LS*-2BPR*-10

- * - Hoist porting code 4.5
- * - Pump sizes 6, 11 or 15
- * - L or R

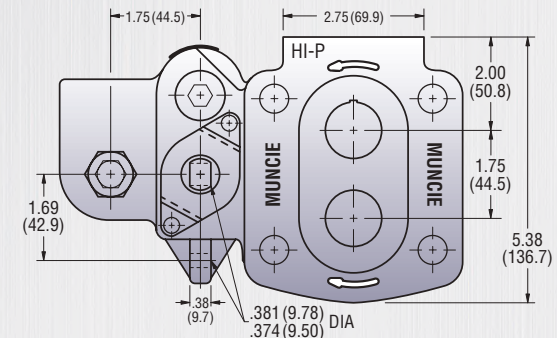
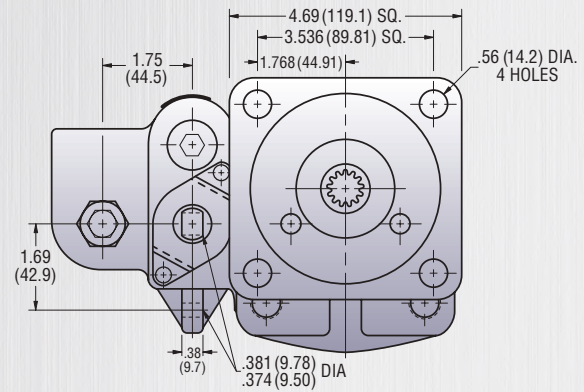
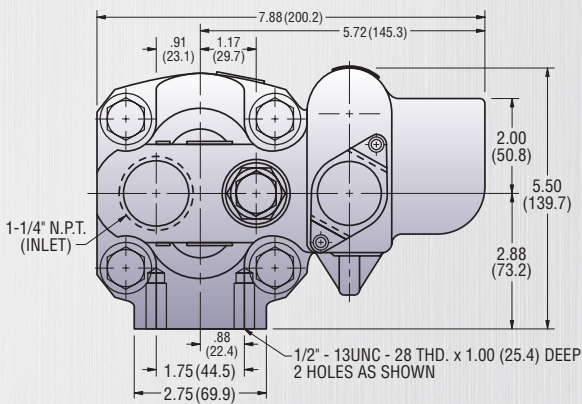

OVERALL LENGTHS

PUMP SIZE	DISPL. CU. IN. (CC)	DIM A IN (MM)	DIM B1 IN (MM)	DIM B2 IN (MM)	WEIGHT LB (KG)	MAX PSI (BAR)
6	1.47 (24)	1.50 (38.1)	13.31 (338.1)	14.12 (358.6)	48 (21.8)	3000 (207)**
11	2.46(40)	2.25 (57.2)	14.06 (357.1)	14.88 (378.0)	50 (22.7)	3000 (207)**
15	3.94(65)	2.75 (69.9)	14.56 (319.3)	15.38 (390.7)	52 (23.6)	2500 (172)

**Requires high pressure relief PS-1231VH for settings above 2500 PSI

Notes: DO NOT USE TEFLON TAPE ON PORTS.

- Optional Air Shift Cylinder (ACM-401).
- Optional Conversion Sleeve for 3-Line Hookup – Muncie Part No. AA1257.
- Tank return line must be below oil level at all times.
- Maximum inlet vacuum is 5 in. hg. (-17 BAR).
- ++ Units built Nov. 2002 and later have a screw adjustable main relief valve.



Muncie Power Products, Inc.

S SERIES PUMP CONSTRUCTION

Zinc plating on other exposed hardware components

Steel relief valve screen

Highest grade fasteners in the industry with anti-corrosion coating protection and rolled threads

Bronze pressure balanced wear plates with Teflon[®] coating

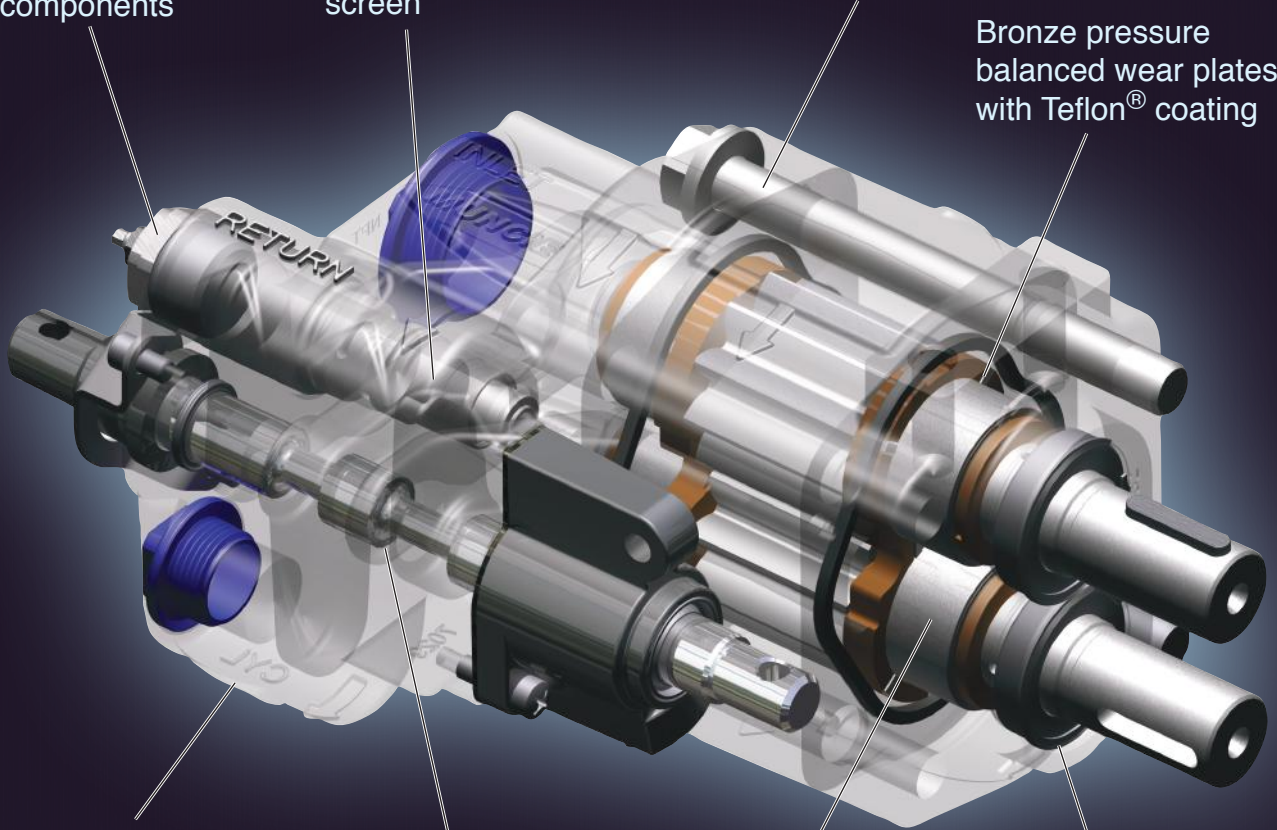

3-Piece Cast iron construction

Hard chrome spool with Low Leakage fit

Premium heavy-duty Roller bearings

High pressure shaft seals with retainer



S SERIES PUMP WARRANTY

The Muncie Cast Iron/Roller Bearing Pump Series "S" is warranted against any defect in material and workmanship which existed at the time of sale by Muncie, according to the following provisions, subject to the requirements that the Pump must be used only in accordance with catalogue and package instructions, and the warranty card must be filled out and returned to Muncie within ten days after the pump is installed.

The Pump is warranted for a period of one year from date of installation. If during the warranty period the Pump fails to operate to Muncie's specifications due to a defect in any part in material or workmanship that existed at the time of sale by Muncie, the defective part will be repaired or replaced, at Muncie's election, at no charge, if the defective part is returned to Muncie with transportation prepaid.

WARNING. The above warranty shall terminate if any alterations or repairs are made to the Pump other than at a Service Center owned by Muncie, or if the Pump is used upon any equipment other than the equipment upon which it is first installed.

As to any Cast Iron/Roller Bearing Pump Series "S" which is rebuilt and retested at a Service Center owned by Muncie, the period of the above warranty is extended for a period of one additional year from the retest date.

THE FOREGOING WARRANTIES ARE IN LIEU OF ALL OTHER OBLIGATIONS AND LIABILITIES, INCLUDING NEGLIGENCE AND ALL WARRANTIES OF MERCHANTABILITY AND SUITABILITY, EXPRESSED OR IMPLIED AND STATE MUNCIE'S ENTIRE AND EXCLUSIVE LIABILITY AND BUYER'S EXCLUSIVE REMEDY FOR ANY CLAIM OF DAMAGES IN CONNECTION WITH THE SALE, REPAIR OR REPLACEMENT OF THE ABOVE GOODS, THEIR DESIGN, INSTALLATION OR OPERATION. MUNCIE WILL IN NO EVENT BE LIABLE FOR ANY DIRECT, INDIRECT, SPECIAL, INCIDENTAL OR CONSEQUENTIAL DAMAGES WHATSOEVER, AND OUR LIABILITY UNDER NO CIRCUMSTANCES WILL EXCEED THE CONTRACT PRICE FOR THE GOODS FOR WHICH LIABILITY IS CLAIMED.

Distributed By:



**Muncie®
Power
Products**

MP08-05 Printed in the U.S.A.
© Muncie Power Products, Inc. 2008

Muncie Power Products, Inc. Member of the Interpump Hydraulics Group
General Offices and Distribution Center • P.O. Box 548 • Muncie, IN 47308-0548
(765) 284-7721 • FAX (765) 284-6991 • E-mail info@munciepower.com
Web site <http://www.munciepower.com>
Drive Products, Exclusive Agents for Canada. ISO Certified by an Accredited Registrar