



ENGINE MOUNTING KIT PH CLUTCH PUMP

Mounting kit has bolt pattern specially designed for Muncie PH Clutch Pumps.

MOUNTING KITS INCLUDE ALL HARDWARE, PULLEYS AND BELTS AS REQUIRED.

ENGINE MOUNTING KITS FOR PH PUMPS: Mounting kits are designed for vehicles with or without air conditioning unless noted otherwise.

(See MP89-14 for Clutch Pumps)

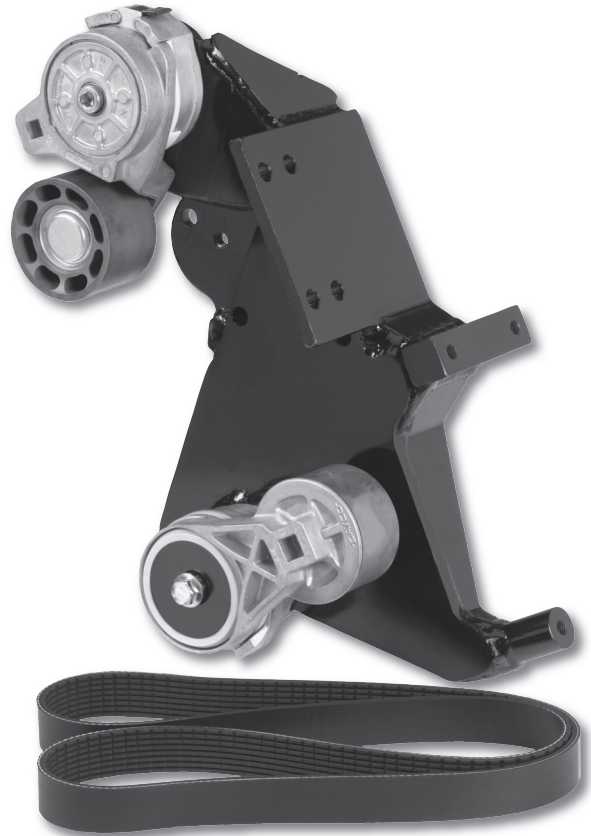

MODEL NUMBER CONSTRUCTION — PH CLUTCH PUMP ENGINE MOUNTING KIT

CMK F 08 - 6400 - P8 - AC

<p>Series C _____</p> <p>Mounting Kit Type MK — Pickup & Medium Duty Truck VK — Passenger Van</p> <p>Chassis Mfg. C — Chev./GMC I — Isuzu D — Dodge M — Mercedes (Freightliner/Sterling) E — Mitsubishi N — International (Navistar) F — Ford P — Peterbilt</p> <p>Model Year _____ First year kit designed for engine (assume it fits subsequent year unless newer year kit available).</p> <p>Engine (Typical - Not All Shown) _____</p>	<p>Kit Style AC — Kits designed to work with trucks with air conditioners. (Delete if applicable.) X — Bracket Kit Only. Inline to OEM Belts.</p> <p>Drive Option (Omit for Single Belt Kits) A — Dual 1/2" V-Belt Kits AH — Dual 1/2" V-Belt Kits, with longer belts for heavy duty clutch AW — Dual 1/2" V-Belt Kit, with water pump P6 — Serpentine 6 Groove Poly V-Belt* P8 — Serpentine 8 Groove Poly V-Belt* P8W — Serp. 8 Gr. Poly V-Belt, w/water pump* XP6 — Serp. 6 Gr. Poly V-Belt, Bracket kit only* XP8 — Serp. 8 Gr. Poly V-Belt, Bracket kit only* LA — Dual 1/2" V-Belt Kit, Ford Compliant Crank Pulley LP8 — Serpentine 8 Groove Poly V-Belt, Ford Compliant Crank Pulley*</p> <p><i>*Requires matching 6 or 8 groove clutch</i></p>
---	--

<p>Chevrolet/GMC 5360 5.3, 6.0 Liter Gas 6500 6.5 Liter Diesel 6600 6.6 Liter Diesel 8100 8.1 Liter Gas</p> <p>Dodge 3136 318, 360 cu. in. 360P 360 cu. in. 3600 360 cu. in. 590D 5.9 Liter Diesel 5900 5.9 Liter Diesel</p>	<p>Ford 5400 5.4 Liter Gas 5900 5.9 Liter Diesel 6000 6.0 Liter Diesel 6800 6.8 Liter Gas 6910 6.9L, 7.3L Diesel 7300 7.3 Liter Diesel</p> <p>International (Navistar) 3600 DT360 Diesel 4046 DT408, DT466 Diesel 444E 7.3 Liter Diesel 4600 DT466 Diesel</p>	<p>Isuzu / Chevy / GMC 3500 350 cu. in. 4700 4.7 Liter Gas 5700 5.7 Liter Gas</p> <p>Mercedes Group 3126 Caterpillar Diesel 5900 5.9 Liter Diesel</p>
--	---	---



Muncie Power Products, Inc. Member of the Interpump Hydraulics Group
General Offices and Distribution Center • P.O. Box 548 • Muncie, IN 47308-0548
(765) 284-7721 • FAX (765) 284-6991 • E-mail info@munciepower.com
Web site <http://www.munciepower.com>

