

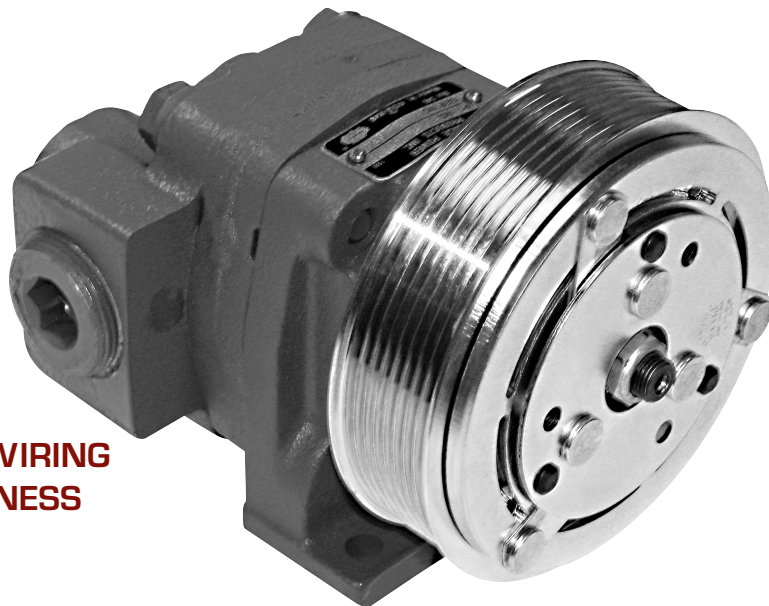

# H SERIES HEAVY DUTY CLUTCH PUMP

## PUMP FEATURES

- ALL CAST IRON CONSTRUCTION
- SPEEDS TO 4,000 RPM
- PRESSURES TO 3,500 PSI
- SOLID ONE PIECE SHAFT
- INTEGRAL MOUNTING PAD
- BOTH SIDE AND REAR PORTS
- ROCKER SWITCH WITH LIGHT, WIRING AND VEHICLE PROTECTION HARNESS KIT INCLUDED
- HEAVY DUTY CLUTCHES
  - \*32 HP/ 92 FT.LBS. (STANDARD) 45 HP/ 130 FT.LBS. (OPTIONAL) 70 HP/ 200 FT.LBS. (FLANGE YOKE)
- FULL ONE YEAR WARRANTY



Optional Engine  
Mounting Kit Available.  
*Brochure MP87-01*



## MODEL NUMBER CONSTRUCTION

|  |  |           |          |          |          |          |          |          |          |                                    |  |
|--|--|-----------|----------|----------|----------|----------|----------|----------|----------|------------------------------------|--|
| <b>Clutch Type</b>                       |  | <b>FB</b> | <b>-</b> | <b>P</b> | <b>H</b> | <b>9</b> | <b>-</b> | <b>P</b> | <b>R</b> | <b>Rotation</b>                    |  |
| FB — Fanbelt, 32 HP (24 KW)              |  |           |          |          |          |          |          |          |          | R — Right-Hand (CW)                |  |
| FBH — Fanbelt, 45 HP (34 KW)             |  |           |          |          |          |          |          |          |          | (Standard FB & SB drive)           |  |
| SB — Serpentine Type 6-Groove Poly Belt  |  |           |          |          |          |          |          |          |          | L — Left-Hand (CCW)                |  |
| SB8 — Serpentine Type 8-Groove Poly Belt |  |           |          |          |          |          |          |          |          | (Front mount FY drive)             |  |
| FY — Flange Yoke                         |  |           |          |          |          |          |          |          |          |                                    |  |
| <b>Pump</b>                              |  |           |          |          |          |          |          |          |          | <b>Port Type (Side &amp; Rear)</b> |  |
|  |  |           |          |          |          |          |          |          |          | P — Pipe Thread (N.P.T.)           |  |
|  |  |           |          |          |          |          |          |          |          | (1-1/4" inlet, 3/4" outlet)        |  |
|  |  |           |          |          |          |          |          |          |          | S — Straight Thread (O.D.T.)       |  |
|  |  |           |          |          |          |          |          |          |          | (1-1/4", 3/4" Straight Thread)     |  |
| <b>H Series</b>                          |  |           |          |          |          |          |          |          |          |                                    |  |
| <b>GPM (LPM) @ 1,000 RPM</b>             |  |           |          |          |          |          |          |          |          |                                    |  |
| 3, 5, 7, 9, 11                           |  |           |          |          |          |          |          |          |          |                                    |  |
| (11, 19, 26, 34, 42)                     |  |           |          |          |          |          |          |          |          |                                    |  |

# CLUTCH PUMP SPECIFICATIONS

| MODEL NO. | DISPL. CU IN (CC) | MAX RPM | MIN RPM | FB/SB MAX PSI (BAR) | FBH*FY MAX PSI (BAR) | MAX OIL TEMP. | MAX INLET VACUUM    |
|-----------|-------------------|---------|---------|---------------------|----------------------|---------------|---------------------|
| PH3       | 0.62 (10)         | 4,000   | 800     | 3,500 (241)         | 3,500 (241)          | 200°F (93°C)  | 5 IN. HG. (.17 BAR) |
| PH5       | 1.24 (20)         | 4,000   | 800     | 3,500 (241)         | 3,500 (241)          | 200°F (93°C)  | 5 IN. HG. (.17 BAR) |
| PH7       | 1.55 (25)         | 3,600   | 800     | 3,000 (207)         | 3,500 (241)          | 200°F (93°C)  | 5 IN. HG. (.17 BAR) |
| PH9       | 2.17 (36)         | 3,000   | 800     | 2,600 (179)         | 2,900 (200)          | 200°F (93°C)  | 5 IN. HG. (.17 BAR) |
| PH11      | 2.48 (41)         | 3,000   | 800     | 2,000 (138)         | 2,500 (172)          | 200°F (93°C)  | 5 IN. HG. (.17 BAR) |

\*Belt horsepower limitations may result in belt slippage @ rated HP even though high torque clutch can carry the pressure. **NOTE: Never use Teflon Tape on ports.**

# CLUTCH PUMP OUTPUT FLOW RATE

| MODEL | 1,000 RPM | 1,500 RPM | 2,000 RPM | 2,500 RPM | 3,000 RPM  |
|-------|-----------|-----------|-----------|-----------|------------|
| PH3   | 2.25 (9)  | 3.5 (13)  | 5.0 (19)  | 6.5 (25)  | 7.5 (28)   |
| PH5   | 4.5 (17)  | 7.3 (28)  | 10.1 (38) | 12.5 (47) | 15.5 (59)  |
| PH7   | 5.4 (20)  | 9.1 (34)  | 12.4 (47) | 15.7 (59) | 19.0 (72)  |
| PH9   | 7.6 (29)  | 12.8 (48) | 17.4 (66) | 22.0 (83) | 26.6 (101) |
| PH11* | 8.9 (34)  | 14.0 (53) | 20.5 (78) | 25.0 (95) | 30.5 (115) |

Flow Rate Tested at 2,500 PSI (172 BAR), Measured in GPM (L PM). \*Model PH11 Tested at 2,000 PSI (138 BAR)

**FB & SB** [32 HP (24 KW) • 95 FT.LBS. (129 NM)]  
**FBH** [45 HP (34 KW) • 130 FTLBS. (176 NM)]

| MODEL NO. | DIM A IN (MM) | DIM B IN (MM) |
|-----------|---------------|---------------|
| PH3       | 7.4 (188.0)   | 0.90 (22.9)   |
| PH5       | 7.9 (200.7)   | 1.40 (35.6)   |
| PH7       | 8.2 (208.3)   | 1.65 (41.9)   |
| PH9       | 8.6 (218.4)   | 2.15 (54.6)   |
| PH11      | 8.9 (226.1)   | 2.40 (61.0)   |

Dim. C: 5.47 in. (138.9 mm) for SB8  
6.00 in. (152.4 mm) for FB & SB  
7.38 in. (187.5 mm) for FBH

Approx. Shipping Weights: 34 Lbs. (15.4 Kg) for FB & SB  
38 Lbs. (17.2 Kg) for FBH

**NOTE:** Basic pump dimensions for all models are the same no matter which clutch is installed.

Clutches require 6 Amps @ 12-VDC. Minimum 11.5-V required at clutch.

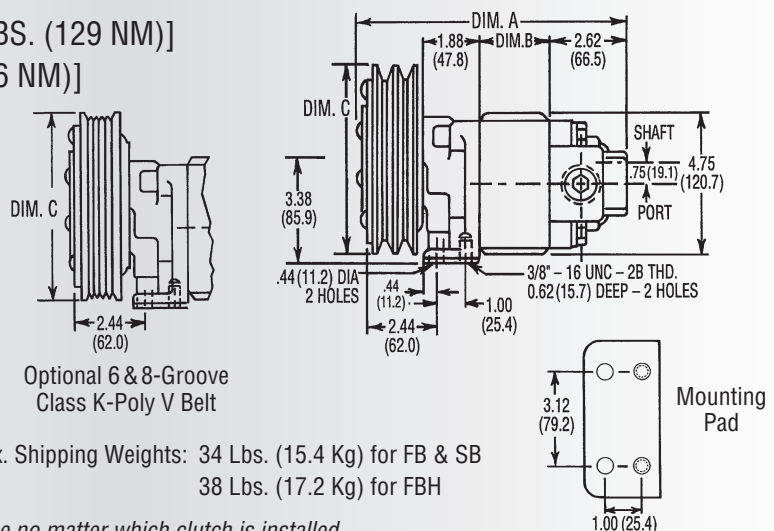

**FY** [70 HP (52 KW) • 200 FT.-LBS. (271 NM)]

| MODEL NO. | DIM A IN (MM) | DIM B IN (MM) |
|-----------|---------------|---------------|
| PH3       | 9.9 (251.5)   | 5.40 (137.2)  |
| PH5       | 10.4 (264.2)  | 5.90 (149.9)  |
| PH7       | 10.6 (269.2)  | 6.15 (156.2)  |
| PH9       | 11.1 (281.9)  | 6.65 (168.9)  |
| PH11      | 11.4 (289.6)  | 6.90 (175.3)  |

Approx. Shipping Weight:  
56 Lbs. (25.4 Kg)  
Manual Override Standard

Clutches require 6 Amps @  
12-VDC. Minimum 11.5-V  
required at clutch.

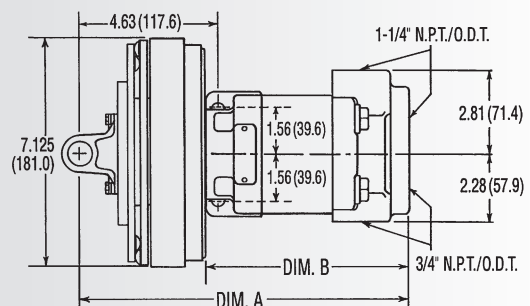

MP88-06 (Rev. 10-07) Printed in the U.S.A.  
© Muncie Power Products, Inc. 2007

**Muncie Power Products, Inc.** Member of the Interpump Hydraulics Group  
General Offices and Distribution Center • P.O. Box 548 • Muncie, IN 47308-0548  
(765) 284-7721 • FAX (765) 284-6991 • E-mail [info@munciepower.com](mailto:info@munciepower.com)  
Web site <http://www.munciepower.com>

Drive Products, Exclusive Agents for Canada, ISO Certified by an Accredited Registrar