



HYDRAULIC FILTERS

PRESSURE AND RETURN LINE STYLE



EASY TO READ FILTER CONDITION INDICATOR WITH GREEN AND RED COLOR CONDITIONS ELIMINATES GUESSWORK. POINTS TO THE RED AREA WHEN IT'S TIME TO REPLACE ELEMENT.

**CHOICE OF NOMINAL OR ABSOLUTE FILTRATION
CLEANER HYDRAULIC SYSTEMS REDUCE CONTAMINATION RELATED FAILURES AND EQUIPMENT DOWN TIME
FLOWS TO 100 GPM**

MODEL NUMBER CONSTRUCTION

TRLF G - 50 1 - L 10 G 25 P 7 7

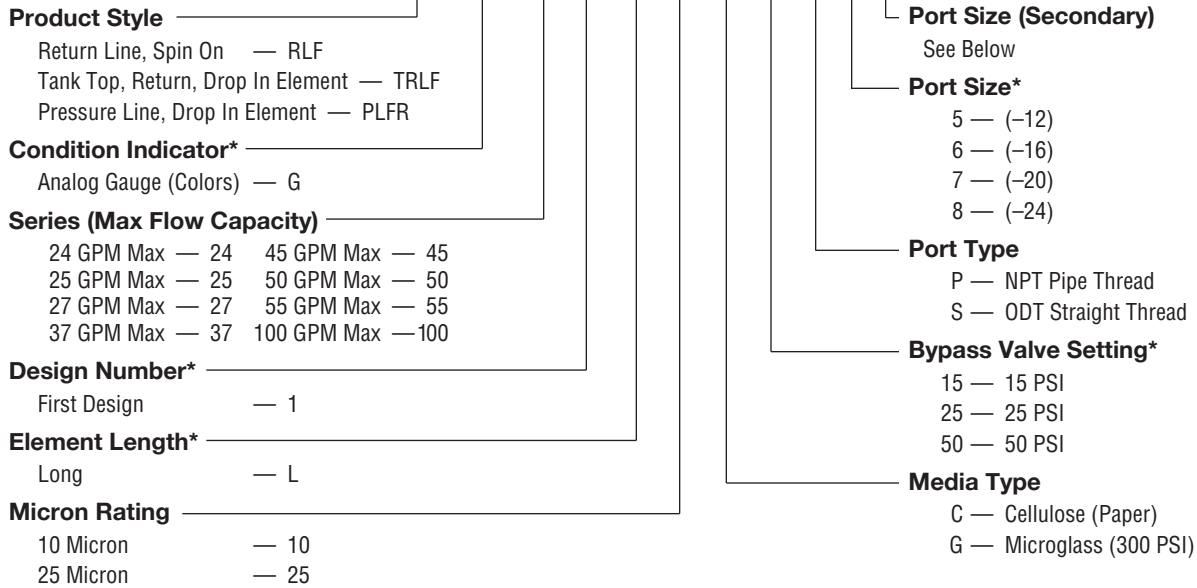

Note: All microglass media elements carry a Beta Rating of $B_{10} = 75$.

All RLF style filters use spin on style elements. All others use drop in elements.

* Delete for None

STANDARD MODELS (SEE PAGES 3-4)

MODEL NUMBER	MODEL STYLE	MEDIA TYPE	MICRON RATING	BYPASS SETTING	PORT TYPE	PORT SIZE	GAUGE NO. *	REPLACE. ELEMENT
RETURN LINE								
RLF*-25	A	C	10	25	NPT (2)	-16	FG-4	RE-25
RLF*-501	B	C	10	25	NPT (2)	-20	FG-4	RE-501
RLF*-100	C	C	10	25	NPT (2)	-24	FG-4	RE-501
RLF*-101	C	C	25	25	NPT (2)	-24	FG-4	RE-101
RLF*-241-L10G25P66	A	G	10	25	NPT (2)	-16	FG-4	RE-241L10G
RLF*-501-L10G25P77	B	G	10	25	NPT (2)	-20	FG-4	RE-501L10G
TANK TOP RETURN LINE								
TRLF*-501	E	C	10	25	NPT (2)	-20	FG-4	TRE-501
TRLF*-503	E	C	10	15	ODT (1)	-20	FG-3	TRE-501
TRLF*-503-10G25S77	E	G	10	25	ODT (1)	-20	FG-4	TRE-50110G
49T37524	E	C	10	25	ODT(2)	-20/24	FG-4	TRE-503(2)
PRESSURE LINE								
PLFR-451-10C50S55**	D	C	10	50	ODT (2)	-12	NA	PRE-45110C
PLFR-451-10C50S66**	D	G	10	50	ODT (2)	-16	NA	PRE-45110C

* Add letter G to model number to include gauge. All gauge ports are 1/8 NPT.

** Requires two mounting kits: PLFR-451-MK.

Note: Use electrical indicator switch part no. PM-515A to replace visual indicator FG-4. Does not include wiring and panel light.

STANDARD MODEL STYLES

DESCRIPTION

Model Style – Reference separate drawings showing basic configuration of the filter assembly.

Media Type – Material used for the element. “C” represents cellulose (paper) which is considered nominal in its dirt capturing capabilities. “G” represents synthetic microglass which is considered absolute in dirt capturing capabilities.

Micron Rating – Represents the smallest particle size that can be efficiently captured.

Bypass Setting – Set point for the internal bypass valve. Once element pressure drop reaches this value, the bypass opens and oil passes on through unfiltered.

Port Type – Shows the style of port either as pipe thread (NPT) or O-ring boss SAE straight thread (ODT). Also shown is the quantity of ports.

Gauge Number – Shows the individual part number of the gauge used for the filter shown. When the letter “G” is added to the model number, the gauge is automatically included.

Replacement Element – Shows the replacement element for the filter shown.

TYPICAL HYDRAULIC CIRCUIT

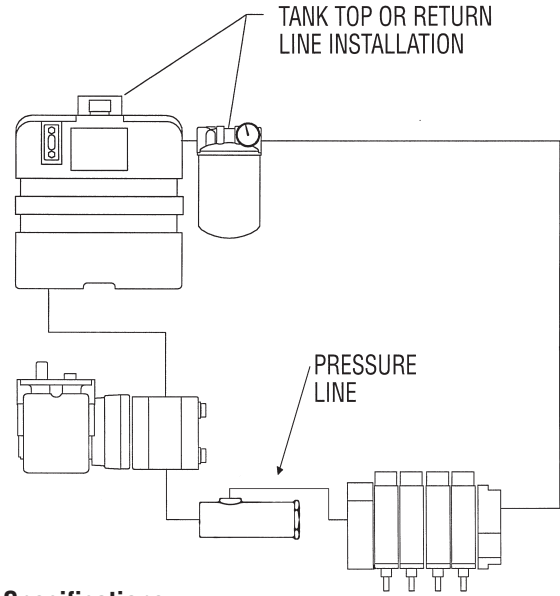

Specifications

Working Pressure: 100 PSI (Rtn.); 3,000 PSI (Press.)

Operating Temp: -65°F to +200°F

Fluid Types: Petroleum

Seals: Buna-N

Constr. (Rtn.): Aluminum Housing

Constr. (Press.): All Steel (PLFR-451)

STYLE A

Models	Dim B
RLF*-25	7.2 (183)
RLF*-241-L***	10.2 (259)

Note: Elements will not interchange between the two models

Note: Allow .63" (16) clearance for element removal

Technical drawings for Style A filter. The top view shows a circular housing with an inlet on the left and an outlet on the right, with a central flow arrow. The diameter is 3.7 (94). The side view shows a cylindrical housing with a height dimension 'B' and a diameter of 3.7 (94). A note indicates to allow .63" (16) clearance for element removal.

STYLE B

Models	Dim B
RLF*-501	9.3 (236)
RLF*-501-L***	13.3 (338)

Note: Allow 1.5" (38) clearance for element removal

Technical drawings for Style B filter. The top view shows a circular housing with an inlet on the left and an outlet on the right, with a central flow arrow. The diameter is 5.4 (137). The side view shows a cylindrical housing with a height dimension 'B' and a diameter of 5.1 (130). A note indicates to allow 1.5" (38) clearance for element removal. Detailed views show a 1/8" NPTF port with a height of 1.2 (30) and a distance of 1.8 (47) from the bottom of the housing. A feature labeled 'FG4' is also indicated.

STYLE C

IN (MM)

Models	Dim B
RLF*-100	17 (432)
RLF*-101	25 (635)
RLF*-100-L***	25 (635)

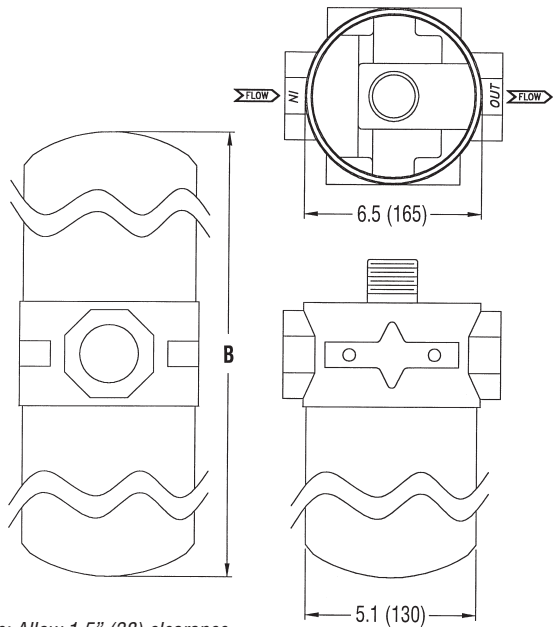

Note: Allow 1.5" (38) clearance for element removal

STYLE D

IN (MM)

Model
PLFR-451-***

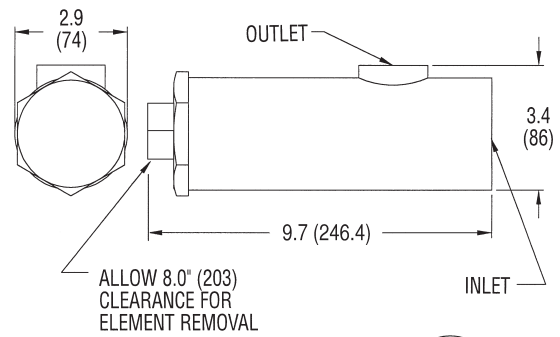

MOUNTING KIT

PLFR-451-MK
2 REQUIRED

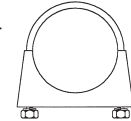

STYLE E

IN (MM)

Models
TRLF*-50*-***
49T37524

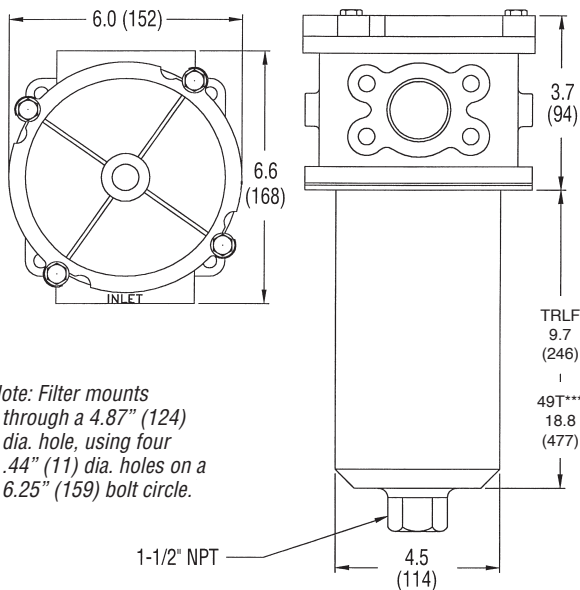

Note: Filter mounts through a 4.87" (124) dia. hole, using four .44" (11) dia. holes on a 6.25" (159) bolt circle.

Note: Allow 9.0" (229) clearance for element removal



MP98-07 (Rev. 1-07) Printed in the U.S.A.
© Muncie Power Products, Inc. 2007

Muncie Power Products, Inc. Member of the Interpump Hydraulics Group
General Offices and Distribution Center • P.O. Box 548 • Muncie, IN 47308-0548
(765) 284-7721 • FAX (765) 284-6991 • E-mail info@munciepower.com
Web site <http://www.munciepower.com>

Drive Products, Exclusive Agents for Canada, ISO Certified by an Accredited Registrar