

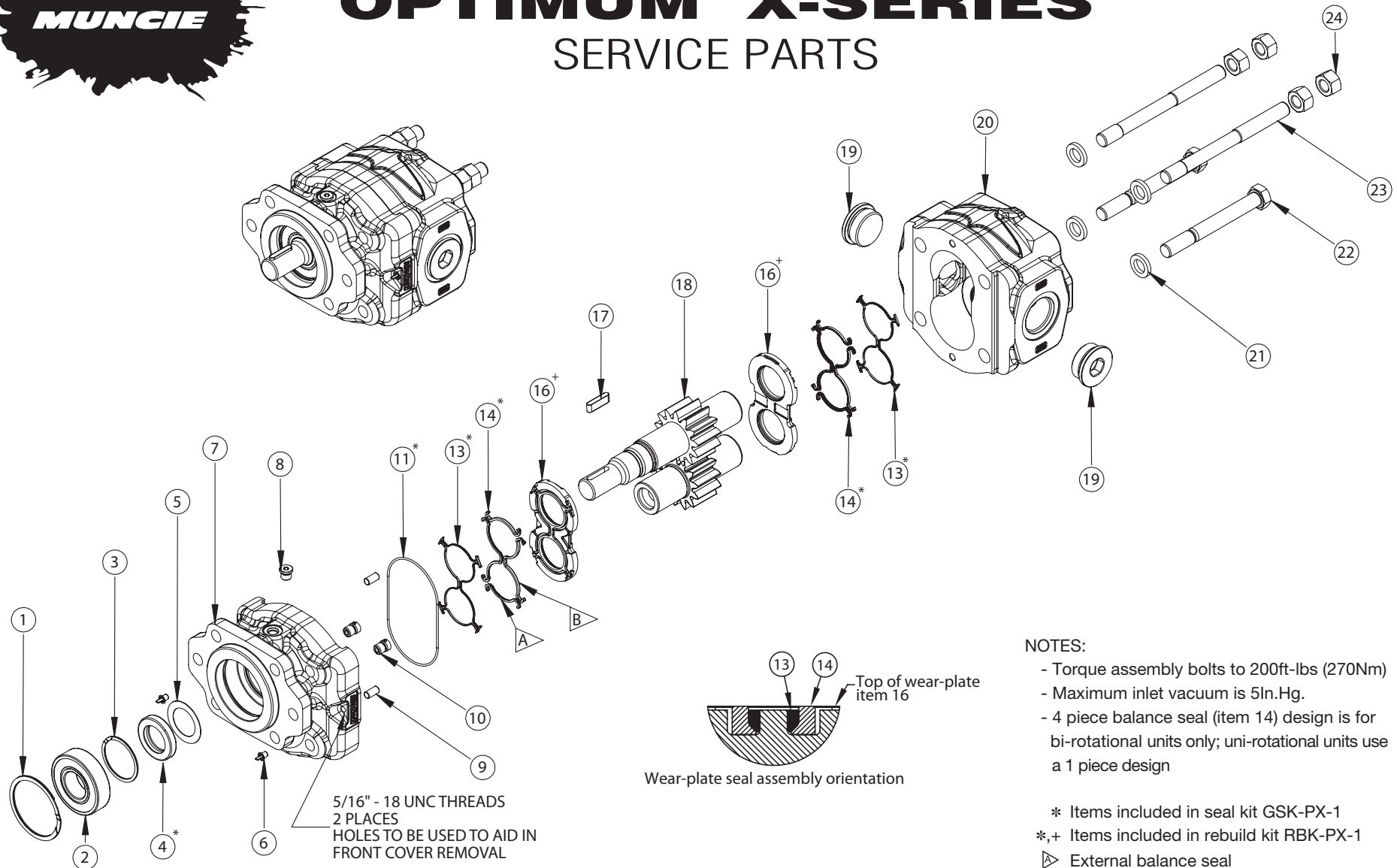

OPTIMUM™ X-SERIES

SERVICE PARTS



NOTES:

- Torque assembly bolts to 200ft-lbs (270Nm)
- Maximum inlet vacuum is 5In.Hg.
- 4 piece balance seal (item 14) design is for bi-rotational units only; uni-rotational units use a 1 piece design

- * Items included in seal kit GSK-PX-1
- *,+ Items included in rebuild kit RBK-PX-1
- ▷ External balance seal
- ◁ Internal balance seal

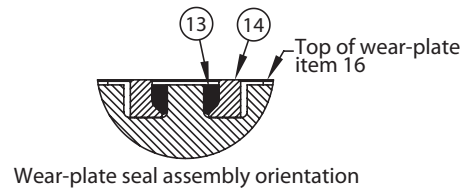

SP12-01 Printed in the U.S.A.
© Muncie Power Products, Inc. 2012

Muncie Power Products, Inc. Member of the Interpump Hydraulics Group
General Offices and Distribution Center • P.O. Box 548 • Muncie, IN 47308-0548
(765) 284-7721 • FAX (765) 284-6991 • E-mail info@munciepower.com
Web site <http://www.munciepower.com>

Drive Products, Exclusive Agents for Canada, ISO Certified by an Accredited Registrar



OPTIMUM™ X-SERIES SERVICE PARTS

Item	Description	Qty	Muncie Number	Item	Description	Qty	Muncie Number	Item	Description	Qty	Muncie Number			
1	Outboard Bearing Snap Ring	1	PL1-1001	Versatile ^B Gear Set, SAE "B" 7/8 - 13T Spline				19	Steel Port Plug w/ o-ring					
2	Outboard Bearing	1	PL1-1002	14GPM	1	PX1-1016-S02-14TV-2			-20SAE	2	HHBP-20Z			
3	Shaft Seal Snap Ring	1	PL1-1004	16GPM	1	PX1-1016-S02-16TV-2		20 ^A	-24SAE	2	HHBP-24Z			
4	Shaft Seal High Pressure	1	PL1-1005	19GPM	1	PX1-1016-S02-19TV-2			Gear Housing					
5	Seal Isolator	1	PX1-1002D	23GPM	1	PX1-1016-S02-23TV-2			SAE Ports, Side & Rear					
6	Jack Bolt Plug	2	PX1-1022P	25GPM	1	PX1-1016-S02-25TV-2			14GPM, -20SAE	1	PX1-1125-14-SGTGT			
7 ^A	Front Cover			27GPM	1	PX1-1016-S02-27TV-2			16GPM, -20SAE	1	PX1-1125-16-SGTGT			
	SAE "B" 2/4 bolt,			30GPM	1	PX1-1016-S02-30TV-2			19GPM, -24SAE	1	PX1-1125-19-SHEHE			
	4" pilot dia, w/ -4SAE drain	1	PX1-1107-BLSDM	33GPM	1	PX1-1016-S02-33TV-2			23GPM, -24SAE	1	PX1-1125-23-SHEHE			
	SAE "C" 4 bolt,			36GPM	1	PX1-1016-S02-36TV-2			25GPM, -24SAE	1	PX1-1125-25-SHEHE			
	5" pilot dia, w/ -4SAE drain	1	PX1-1107-CLSDM	Versatile ^B Gear Set, SAE "BB" 1.0 - 15T Spline					27GPM, -24SAE	1	PX1-1125-27-SHEHE			
	remote mount pad,			14GPM	1	PX1-1016-S17-14TV-2			30GPM, -24SAE	1	PX1-1125-30-SHEHE			
	w/ -4SAE drain	1	PX1-1107-RLSDM	16GPM	1	PX1-1016-S17-16TV-2			33GPM, -24SAE	1	PX1-1125-33-SHEHE			
8	Case Drain Plug w/ o-ring, - 4 SAE	1	HHBP4-Z	19GPM	1	PX1-1016-S17-19TV-2			36GPM, -24SAE	1	PX1-1125-36-SHEHE			
9	Dowel Pin, 5/16" x 5/8"	2	PX1-1024	23GPM	1	PX1-1016-S17-23TV-2			Split Flange Ports, Side Only					
10	Check Valve Assembly	2	PS1-1010	25GPM	1	PX1-1016-S17-25TV-2			14GPM, 2.00" x 1.25"	1	PX1-1125-14-FJCXX			
11	Body Seal	1	PX1-1015	27GPM	1	PX1-1016-S17-27TV-2			16GPM, 2.00" x 1.25"	1	PX1-1125-16-FJCXX			
13	Backup seal			30GPM	1	PX1-1016-S17-30TV-2			19GPM, 2.00" x 1.25"	1	PX1-1125-19-FJCXX			
	plastic, uni-rot design	2	PX1-1009-XPU	33GPM	1	PX1-1016-S17-33TV-2			23GPM, 2.00" x 1.25"	1	PX1-1125-23-FJCXX			
	plastic, bi-rot design	2	PX1-1009-XPB	36GPM	1	PX1-1016-S17-36TV-2			25GPM, 2.00" x 1.25"	1	PX1-1125-25-FJCXX			
14	Balance Seal			Versatile ^B Gear Set, SAE "C" 1.25 - 14T Spline					27GPM, 2.00" x 1.25"	1	PX1-1125-27-FJCXX			
	Uni-rot, Buna N	2	PX1-1008-XBU	14GPM	1	PX1-1016-S05-14TV-2			30GPM, 2.00" x 1.50"	1	PX1-1125-30-FJDXX			
	Bi-rot, external (14A), Buna N	4	PX1-1008-XBBE	16GPM	1	PX1-1016-S05-16TV-2			33GPM, 2.00" x 1.50"	1	PX1-1125-33-FJDXX			
	Bi-rot, internal (14B), Buna N	4	PX1-1008-XBBI	19GPM	1	PX1-1016-S05-19TV-2			36GPM, 2.00" x 1.50"	1	PX1-1125-36-FJDXX			
16	Wear plate			23GPM	1	PX1-1016-S05-23TV-2			21	5/8 Washer	4	PE1-1230		
	uni-rotational	2	PX1-1014UX	25GPM	1	PX1-1016-S05-25TV-2			22	Capscrew				
	bi-rotational	2	PX1-1014BX	27GPM	1	PX1-1016-S05-27TV-2				14GPM 5/8-11UNC x 5-1/4	2	PL1-1028-14		
17	Key			30GPM	1	PX1-1016-S05-30TV-2				16GPM 5/8-11UNC x 5-1/2	2	PL1-1028-16		
	1-1/4" x 1/4" x 3/8"			33GPM	1	PX1-1016-S05-33TV-2				19GPM 5/8-11UNC x 5-3/4	2	PL1-1028-19		
	for 1.00" round shaft	1	PS1-1017	36GPM	1	PX1-1016-S05-36TV-2				23GPM 5/8-11UNC x 6	2	PL1-1028-23		
	1-1/2" x 5/16" x 15/32"			Versatile ^B Gear Set, SAE "BB" 1.0" Round						25GPM 5/8-11UNC x 6-1/4	2	PL1-1028-25		
	for 1.25" round shaft	1	PM1-1017	14GPM	1	PX1-1016-K01-14TV-2				27GPM 5/8-11UNC x 6-1/2	2	PL1-1028-27		
18	Gear Set, SAE "B" 7/8 - 13T Spline			16GPM	1	PX1-1016-K01-16TV-2				30GPM 5/8-11UNC x 6-3/4	2	PL1-1028-30		
	14GPM	1	PX1-1016-S02-14-2	19GPM	1	PX1-1016-K01-19TV-2				33GPM 5/8-11UNC x 7	2	PE1-1028-23		
	16GPM	1	PX1-1016-S02-16-2	23GPM	1	PX1-1016-K01-23TV-2				36GPM 5/8-11UNC x 7	2	PE1-1028-23		
	19GPM	1	PX1-1016-S02-19-2	25GPM	1	PX1-1016-K01-25TV-2				23	Stud			
	23GPM	1	PX1-1016-S02-23-2	27GPM	1	PX1-1016-K01-27TV-2					14GPM 5/8-11UNC x 7	2	PE1-1028-23S	
	25GPM	1	PX1-1016-S02-25-2	30GPM	1	PX1-1016-K01-30TV-2					16GPM 5/8-11UNC x 7-1/4	2	PL1-1028-16S	
	27GPM	1	PX1-1016-S02-27-2	33GPM	1	PX1-1016-K01-33TV-2					19GPM 5/8-11UNC x 7-1/2	2	PE1-1028-27S	
	30GPM	1	PX1-1016-S02-30-2	36GPM	1	PX1-1016-K01-36TV-2					23GPM 5/8-11UNC x 7-3/4	2	PL1-1028-23S	
	33GPM	1	PX1-1016-S02-33-2	Versatile ^B Gear Set, SAE "C" 1.25" Round							25GPM 5/8-11UNC x 8	2	PL1-1028-25S	
	36GPM	1	PX1-1016-S02-36-2	14GPM	1	PX1-1016-K07-14TV-2					27GPM 5/8-11UNC x 8-1/4	2	PL1-1028-27S	
				16GPM	1	PX1-1016-K07-16TV-2					30GPM 5/8-11UNC x 8-1/2	2	PL1-1028-30S	
				19GPM	1	PX1-1016-K07-19TV-2					33GPM 5/8-11UNC x 8-3/4	2	PL1-1028-S0875	
				23GPM	1	PX1-1016-K07-23TV-2					36GPM 5/8-11UNC x 9	2	PL1-1028-S0900	
				25GPM	1	PX1-1016-K07-25TV-2					24	Nut 5/8-11 UNC	4 or 6	PE1-1020
				27GPM	1	PX1-1016-K07-27TV-2								
				30GPM	1	PX1-1016-K07-30TV-2								
				33GPM	1	PX1-1016-K07-33TV-2								
				36GPM	1	PX1-1016-K07-36TV-2								

KITS Description Muncie Number

Seal Kit	
includes items 4,11,13,14kit..... GSK-PX-1
Rebuild Kit	
includes items 4,11,13,14,16kit..... RBK-PX-1

NOTES:
 A. Covers shipped with bushings PX1-1013 installed
 B. Versatile gear sets are machined for multiple pump configurations