



**Muncie[®]
Power
Products**

CMKC01-6600-YP6-AC

2001-05 CHEVY

Silverado 2500HD & 3500

6.6, V-8 Diesel

W/O Dual Alternator

W-W/O Vacuum Pump

W-W/O AC

INSTALLATION NOTES

1. Disconnect the negative battery cable. Disconnect the wires to the module mounted on the fan shroud. Remove the module, fan shroud, and fan from the truck. (Fan nut has right hand threads). Remove the O.E.M. accessory drive belt.
2. Remove the four bolts holding the A/C compressor to the A/C bracket. Place the two spacers (4) under the A/C compressor at the two holes to the inside. Install bolts and flatwashers (10 & 11) into those two holes loosely. Install bracket (2) under the A/C compressor with bolts and flatwashers (10 & 11) at locations "A & B", and bolts (7) with lockwashers (12) at locations "C & D". Do Not Tighten.
3. Install the idler assembly on the back side of bracket (1) using the bottom hole of the lower three for 2001 model trucks, and the bottom hole of the upper three holes for 2002 models. Tighten. Install the belt around the A/C and clutch pump pulleys before installing bracket (1). Remove the three bolts holding the P/S pump plate to the aluminum bracket at locations "E, F & G". Install bracket (1) using bolts (7 & 8), with lockwashers (12) and spacers (3). Tighten all bolts very lightly, and then tighten them securely.
4. Install the clutch pump into the back side of bracket (2) using bolts (16), flatwashers (21), lockwashers (17) and nuts (18), tighten securely. Install the coil adapter plate (19) onto the front of bracket (2) using bolts (20). Install the coil and clutch as per manufacturer's instructions.
5. Install the belt onto the rest of the engine pulleys according to the illustration. Vehicles equipped with vacuum pump require the tensioner to be modified as shown on attachment. If the belt is properly seated into all the pulleys and is too short, remove the bolts holding bracket (1), and move the idler up to the next hole.
6. Replace the fan, shroud and module back onto the vehicle. Reconnect the module and the battery cable. Run the engine to make sure the belt tracks properly and nothing comes in contact with any moving parts. Adjust if necessary.

NOTE: This kit only requires one belt, the extra belt is to be placed in the vehicle for future use because this belt is not available over the counter.

CAUTION: Check all engine compartment vacuum hoses and electrical wiring that may have been disturbed or re-routed during kit installation to be sure that hoses are not kinked, that they do not touch any high temperature item, and that they do not interfere with any linkage components.

CMKC01-6600-YP6-AC

2001-05 Chevy

Silverado 2500 HD & 3500

6.6 V-8 Diesel

W/O Dual Alternator

W-W/O Vacuum Pump

W-W/O AC

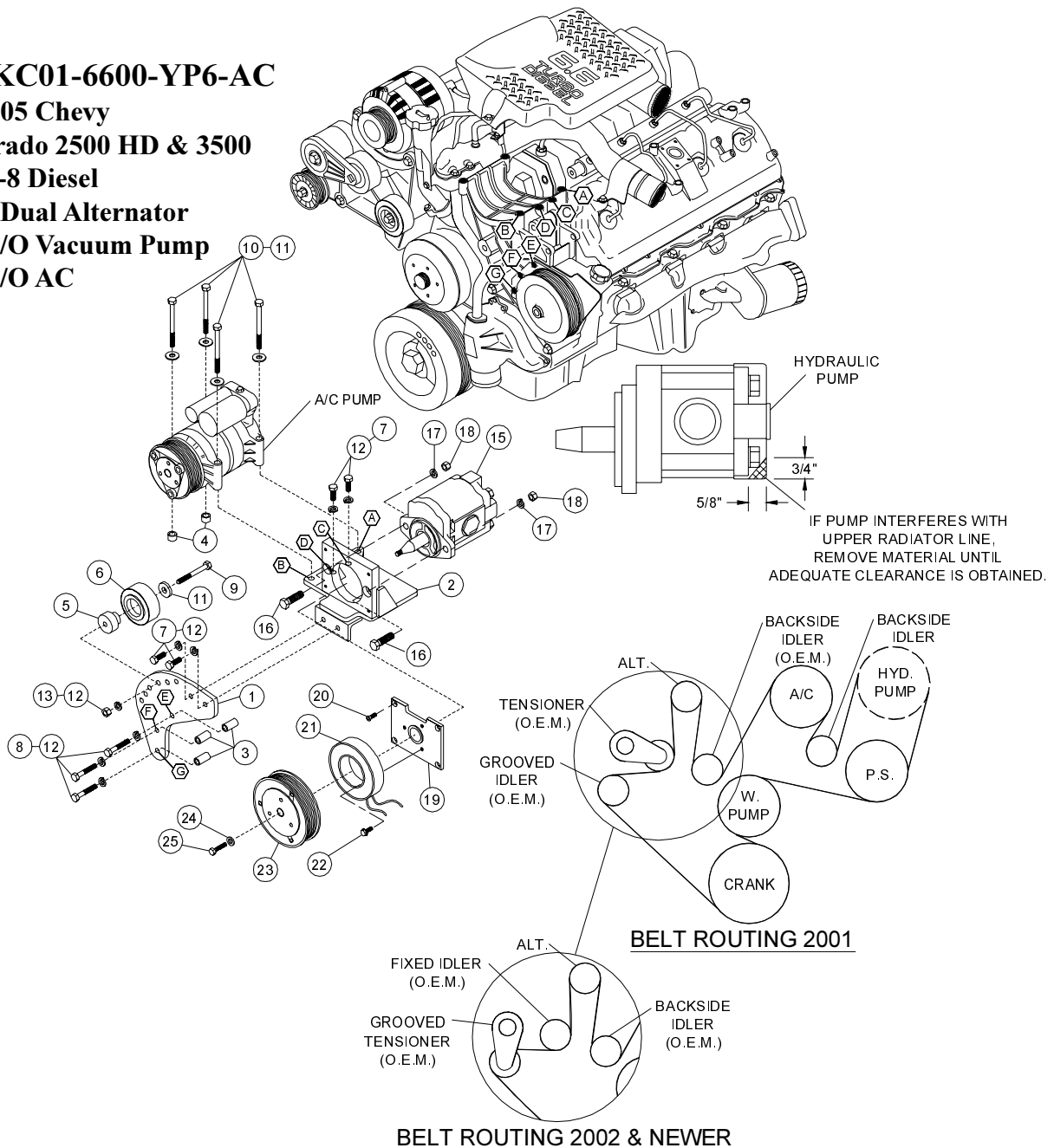

PARTS LIST

- | | |
|-------------------------|--|
| 1. CMB 681 (1) | 14. 5061380 (2) (Not Shown) |
| 2. CMP 681 (1) | 15. Clutch Pump (Sold Separately) |
| 3. SP64-1.500 (3) | 16. 3/8 x 1-1/2 (2) |
| 4. SP88-0.375 (2) | 17. 3/8 LW (2) |
| 5. CMB 672 (1) | 18. 3/8 NC Nut (2). |
| 6. TIPCS (1) | 19. MCA01 plate |
| 7. 10mm x 25mm 10.9 (4) | 20. 1/4 x 3/4 NC FHSCS (4) |
| 8. 10mm x 80mm 10.9 (3) | 21. Coil (Sold Separately) |
| 9. 10mm x 50mm (1) | 22. Capscrew- 19T34530 (3) (T=8-10 ft/lbs) |
| 10. 10mm x 100mm (4) | 23. Clutch (Sold Separately) |
| 11. 10mm FW (5) | 24. Flat Washer- 21MZ3487 (1) |
| 12. 10mm LW (8) | 25. Capscrew-19T38756 (1) (T=20 ft/lbs) |
| 13. 10mm NC (1) | |

VEHICLES WITH VACUUM PUMP

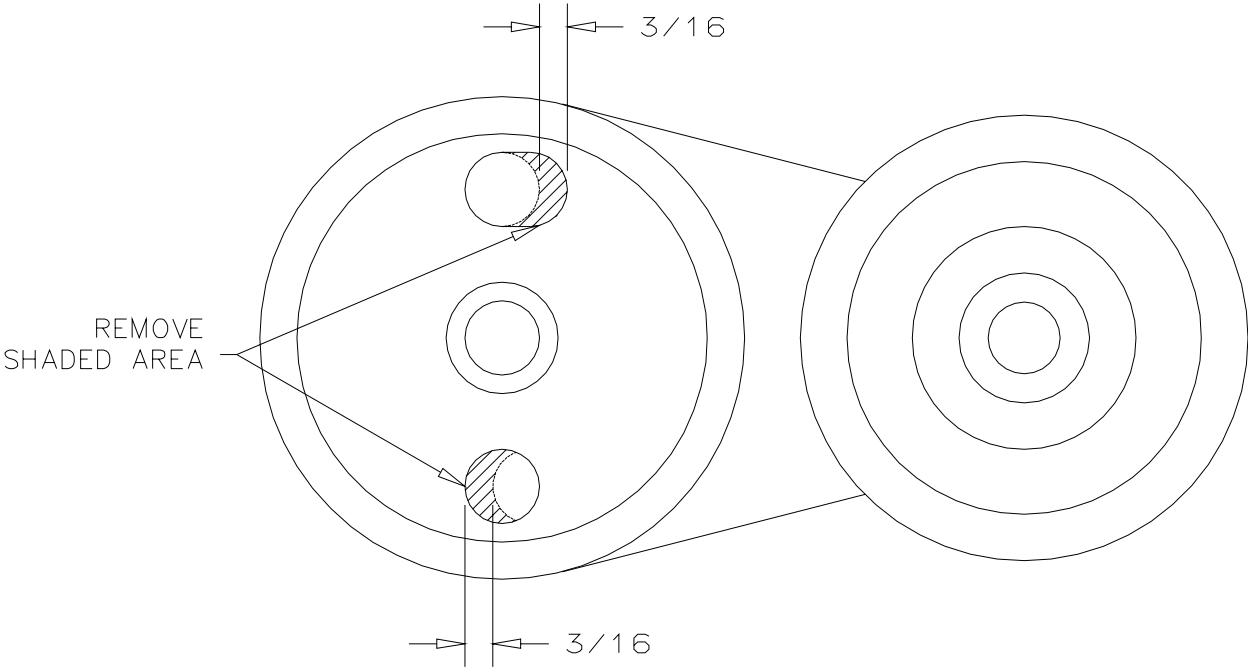

VIEW FROM THE BACK SIDE