



INSTALLATION NOTES

1. Disconnect negative battery cable. Drain engine coolant. Remove coolant tube at the water pump outlet and from the overflow tank. Remove OEM belt. Remove OEM alternator.
2. Install fittings (13, 14) at the water pump with the hose barb pointed forward and down to clear the radiator hose. Install new hose (15) using OEM hose clamps and odel clamps provided to secure the hose. Route the hose underneath the fan shroud and up to the overflow tank. (Note: do not route the hose above the overflow tank level.)
3. Remove OEM bolts from the passenger side frame rail at locations (B & C). Install radiator support rod bracket (16) with bolt (17), nut (4), and lockwasher (5) at location (A). Reuse OEM bolts in locations (B & C). (Note: Remember to reinstall ground cables at location (C)). Remove bolt from passenger side radiator support rod at location (D) and loosen the bolt at the other end of the rod. Rotate the support rod down to the new bracket reusing OEM bolt. Tighten both bolts securely.
4. Install the dual bearing idler assembly (8, 11, 12, 10) at location (E). Install studs (3) into the alternator mounting bracket. Install the alternator onto the studs and secure it with nuts (4). Torque to 35 ft/lbs. Install the pump onto pump plate (1) using bolts provided. Install bushings (2) and pump plate (1) onto the four alternator studs (3) as shown, securing with nuts (4) and lockwashers (5). Torque to 35 ft/lbs.
5. Loosen pump bolts and align the pump pulley with the drive pulley. Tighten bolts securely. Install the single bearing idler assembly (6, 7) with bolt (9) and flatwasher (8) in location H. Install belt (21) as shown in belt diagram. Refill engine with coolant and reconnect battery cable. Check for proper clearances to all moving parts. Run engine and check for proper tracking of the belt, and adjust if necessary.

CMKC04-3126-XP8-AC

2004-2009

Chevy Kodiak 6500 & 7500

GMC Topkick 6500 & 7500

CAT(C7)W/AC

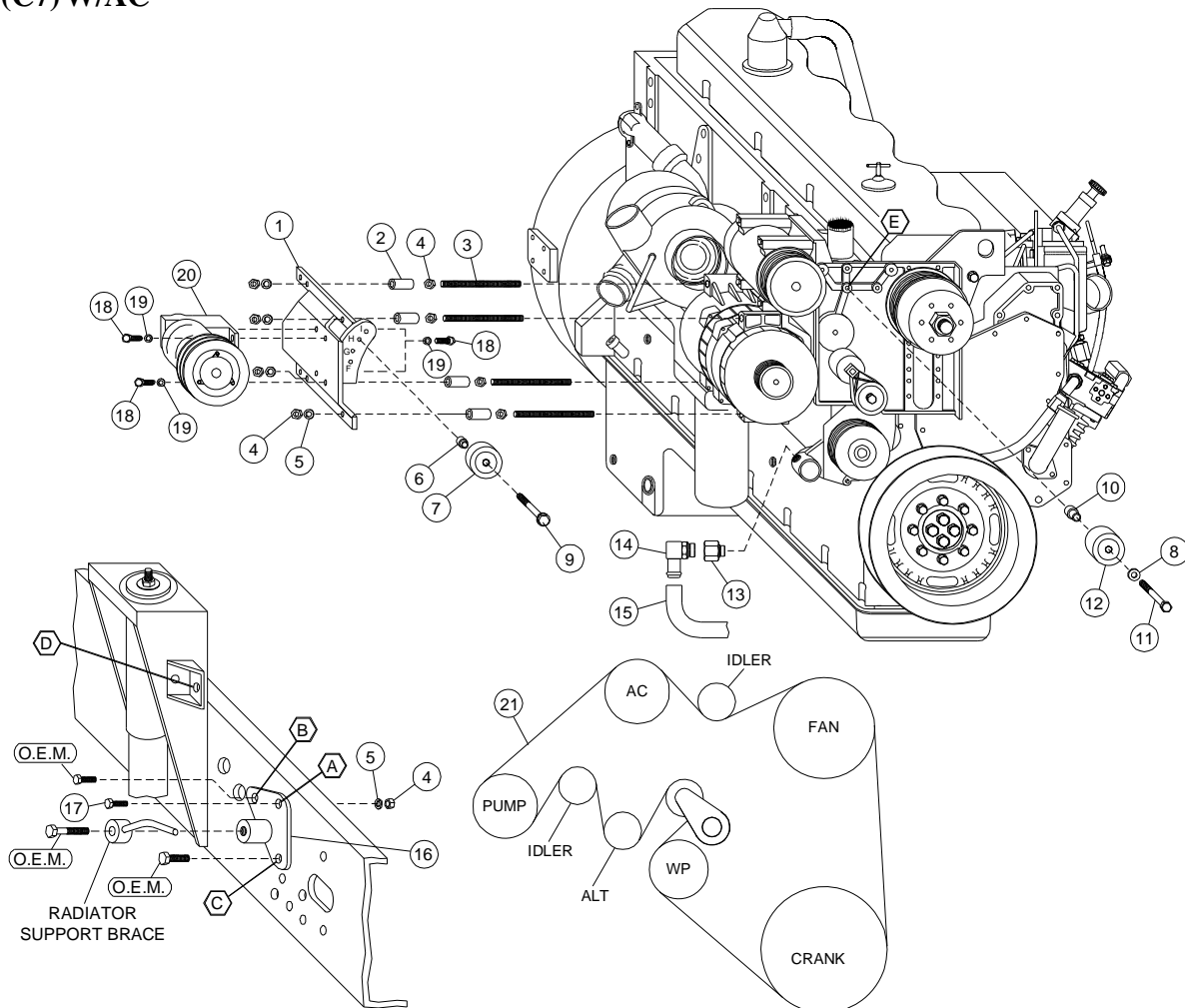

BELT DIAGRAM

PARTS LIST

- | | |
|--------------------------------|---|
| 1. FMB 931 (1) | 15. 1" Hose (1) |
| 2. SP 100-1.340 (4) | 16. CMB 742 (1) |
| 3. 10mm x 180mm Stud (4) | 17. 10mm x 45mm Bolt (1) |
| 4. 10mm Nut (9) | 18. 3/8 x 1 Bolt, NC (4) |
| 5. 10mm LW (5) | 19. 3/8 LW (4) |
| 6. FMB 935 (1) | 20. Clutch Pump Assembly
(Sold Separately) |
| 7. 89016 (1) | 21. Belt; 5081080 Dayco |
| 8. 3/8 FW (1) | 22. 1-1/2" Odel Clamp (4) |
| 9. 10mm x 40mm Flange Bolt (1) | 23. 1/4-20 x 1 Bolt (4) |
| 10. CMB 741 (1) | 24. 1/4-20 Nut (4) |
| 11. 10mm x 60mm Bolt (1) | 25. 1/4 LW (4) |
| 12. IPCD-3.0 (1) | 26. 1/4 FW (8) |
| 13. 6410-10-12 Adapter (1) | |
| 14. 4601-16-12 Hose Insert (1) | |