



**Muncie<sup>®</sup>  
Power  
Products**

**CMKC99-5360-XP6-AC**

**1999-Current Chevy Silverado**

**4.8,5.3,6.0**

**W-WO/AC**

**Kits built after April 2006 work with**

**all alternator sizes**

## **INSTALLATION NOTES**

---

1. Disconnect negative battery cable. Remove the top half of the fan shroud and the fan. (*Fan nut is right hand threads*). It's not necessary to remove the fan and fan shroud, but makes installation easier. Remove O.E.M. belt. Remove the hot wire from the back of the alternator, and the bracket that holds the wire connector to the alternator bracket.
2. Remove the three bolts holding the alternator bracket to the engine. Install the pump bracket (1) using those three hole locations on the alternator bracket with three 10mm x 140mm bolts (5) and lock-washers (6). (Do not tighten). Install pump bracket brace (2) to the back of the pump bracket using two 10mm x 25mm bolts (8) and lockwashers (6) and one 10mm x 60mm bolt (7) and lockwasher (6) at location D. Once all the bolts are in place and finger tight, tighten the front three bolts securely first and then the brace bolts.
3. Install the pump (9) onto the pump bracket and align the clutch pulley with the O.E.M. pulley. **NOTE:** The clutch pump pulley will run very close to the front of the pump bracket when properly aligned. Install the flat idler (3) into the lower tapped hole on the front of the bracket. If the belt is too short to install, move the idler to the upper tapped hole in the bracket.
4. Replace the fan and top half of the fan shroud if removed. Connect the alternator wire. (*It may be necessary to splice in a piece of wire or replace wire with a longer one*). Connect battery and check to make sure all hoses, wire's, etc. are clear of any moving or hot parts.

**NOTE:** Check all engine compartment vacuum hose and electrical wiring that may have been disturbed or rerouted during kit installation to be sure that hoses are not kinked, that they do not touch any high temperature items, and that they do not interfere with any linkage components.

**CMKC99-5360-XP6-AC**  
**1999-Current Chevy Silverado**  
**4.8,5.3,6.0**  
**W-WO/AC**  
**Kits built after April 2006**  
**Work with all alternator sizes**

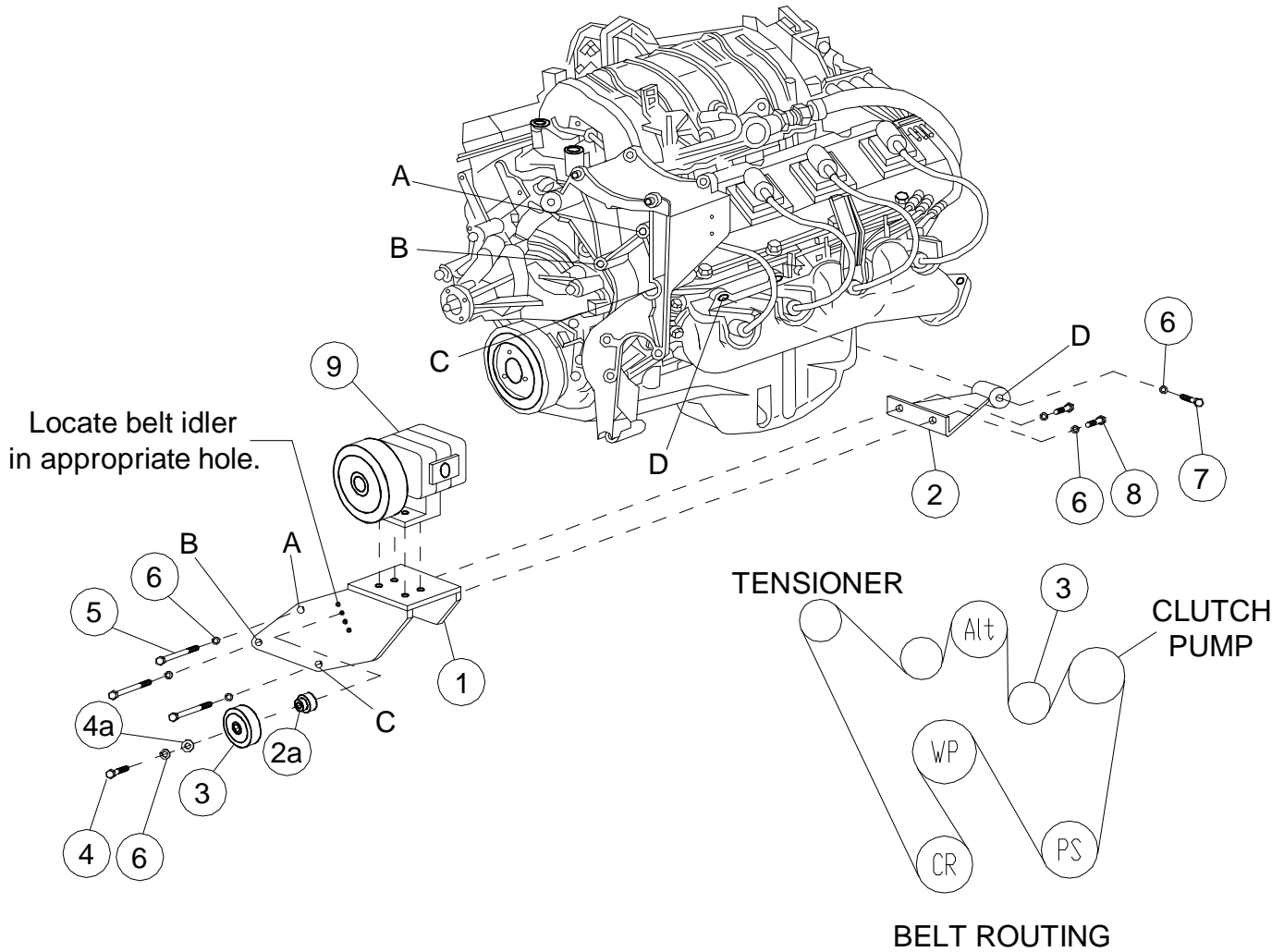

**PARTS LIST**

- |   |  |
|---|--|
| <ul style="list-style-type: none"> <li>1. CMP 381 (1)</li> <li>2. CMB 381 (1)</li> <li>3. 89007 Dayco (1)</li> <li>3a. CMB 3867 (1)</li> <li>4. 10mm x 40mm 1.5 Flange Bolt (1)</li> <li>5. 10mm x 140mm 1.5 (3)</li> </ul> | <ul style="list-style-type: none"> <li>6. 10mm LW (7)</li> <li>7. 10mm x 60mm 1.5 (1)</li> <li>8. 10mm x 25mm 1.5 (2)</li> <li>9. Clutch Pump Assembly (1)<br/>(Sold Separately)</li> <li>10. Belt 5061185* (1)</li> </ul> |
|---|--|

\* Kits built prior to April 2006 use belt no. 5061150. These kits have 3 holes for positioning the idler and fit all alternator sizes except 130 & 145 amp. Kits built after April 2006 have 4 idler adjustment holes.



**Muncie<sup>®</sup>  
Power  
Products**

## **BULLETIN**

**CMKC99-5360-XP6-AC 1999-Current Chevy Silverado 4.8,5.3,6.0 W-WO/AC**

All 4.8, 5.3, and 6.0 litre engines will require the removal of aluminum from the O.E.M. alternator bracket in order for the pump bracket to fit properly. The illustration shows the area that needs to be removed.

