



**Muncie<sup>®</sup>  
Power  
Products**

**CMKC99-740M-A-AC  
CMKC99-740M-AH-AC**

90-98 Chevy 6.0, 7.0 C60 & C70  
& 99-00 454 7.4 C65 & C75 Trucks  
W-WO/AC W-WO Dual Battery,  
WO/Air Brakes, W/ Remote  
Mounted P.S. Reservoir  
(Serpentine)

---

## INSTALLATION NOTES

---

1. Disconnect negative battery cable. Remove the fan. Loosen O.E.M. belts. Do not remove.
2. Remove the six bolts from the front of the crank pulley. If equipped with a single groove v-belt pulley on the radiator side, remove it. Install the three groove pulley onto the front of the existing pulley(s) with bolts provided in the kit.  
**CAUTION:** Make sure the pulley bolts are the same threads as the O.E.M. bolts and 1/2" longer.
3. Remove the bolts at locations "D & C". Install the main bracket (5) at locations "A & B" with bolts (9) and lockwashers (12). Do not tighten. Using the washers and spacers provided in the kit, shim the bracket at locations "D & C". Install bolts (7) and lockwashers (8). Tighten bolts at all locations.
4. Install the pump plate onto the main bracket with bolts (10 & 11), flatwasher (13), lockwashers (12) and nuts (14). Do not tighten. Install the pump onto the plate and align it with the drive pulley. Tighten pump bolts securely. Tighten O.E.M. belts. Install and tighten pump belts. **NOTE:** The fan shroud may need to be notched for pulley and belt clearance.
5. Install the fan spacer nut (4) onto the water pump. Install fan. Check for clearances on belts, pulleys, etc.. Connect battery cable.

**CAUTION:** Check all engine compartment vacuum hose and electrical wiring that may have been disturbed or rerouted during kit installation to be sure that hoses are not kinked, that they do not touch any high temperature items, and that they do not interfere with any linkage components.

**CMKC99-740M-A-AC**  
**CMKC99-740M-AH-AC**

90-98 Chevy 6.0, 7.0 & 99-00 454 7.4 W-WO/AC  
 W-WO Dual Battery, WO/Air Brakes,  
 W/ Remote Mounted P.S. Reservoir  
 (Serpentine)

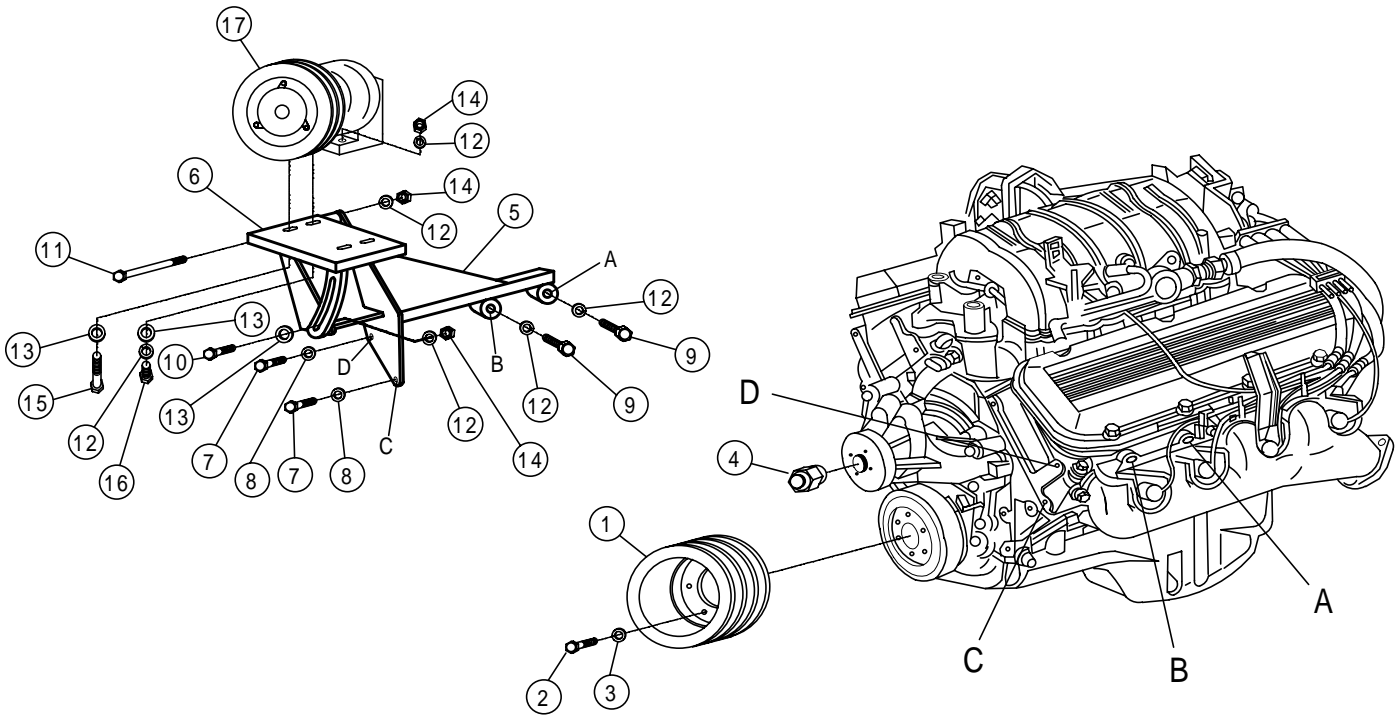

**PARTS LIST**

- |                             |   |
|-----------------------------|---|
| 1. CPC-522 (1)              | 10. 3/8 x 1-1/4 (1)                           |
| 2. 5/16 x 1-1/4 NC-GR.8 (6) | 11. 3/8 x 5-1/2 NC (1)                        |
| 3. 5/16 LW (6)              | 12. 3/8 LW (8)                                |
| 4. FSK 52 (1)               | 13. 3/8 FW (5)                                |
| 5. CMB 530 (1)              | 14. 3/8 NUT (4)                               |
| 6. CMP-53 (0-4)             | 15. 3/8 x 1-1/2 NC (2)                        |
| 7. 7/16 x 1-3/4 NC (2)      | 16. 3/8 x 1 NC (2)                            |
| 8. 7/16 LW (2)              | 17. Clutch Pump Assembly<br>(Sold Separately) |
| 9. 3/8 x 2 NC (2)           | 18. A62F (2) H.D.: A64F<br>(Not Shown)        |