



**Muncie®
Power
Products**

CMKD04-5900-P6-AC

**2003-2007 R-250,350
5.9 I.S.B. Cummins Diesel
With A/C only**

INSTALLATION NOTES

1. Disconnect the negative battery cables. Drain the engine coolant until the water level is several inches below the upper radiator hose. Remove the air cleaner assembly. Disconnect the fan clutch wire at the bottom of the fan shroud and remove the wire from the fan shroud. Remove the fan (*fan nut has right hand threads*), fan shroud and coolant reservoir from the engine compartment. Trucks with a build date of Jan. '04 and later will not require the removal of the radiator reservoir, but will require the removal of the fan shroud brace located high on the passenger side.
2. Remove the serpentine belt. Remove the upper alternator bolt and loosen the lower bolt. Swing the alternator towards the fender. Remove the alternator bracket and the engine lifting lug, they will not be reused.
3. Move the wire loom that runs across the front of the engine behind the thermostat housing. Install the main bracket reusing the three 10mm alternator bracket bolts at locations "C", "D" and "E" and bolts (7) with lockwashers (6) at locations "A" and "B". Tighten bolts evenly. Raise the alternator until the hole in the alternator aligns with the bushing on the bracket. Install the OEM alternator bolt. If the truck has a build date of Jan. '04 or later, use shroud brace (10) with OEM alternator bolt, then tighten both alternator bolts.
4. Remove the grooved idler from the top of the engine and replace it with the idler pulley assembly (1 through 4). Install the OEM serpentine belt to its original routing. Install the clutch pump (16) with bolts provided. Align the clutch pulley with the drive pulley then tighten bolts. Install the pump belt tensioner (8) onto the bracket with bolt (9). Install the pump drive belt according to the diagram.
5. Replace the fan, fan shroud and coolant reservoir. If the truck has a build date of Jan. '04 or later, fan shroud will need trimmed for adequate clearance. Drill 3/8 hole in shroud for brace (10) and use bolt (11), flatwasher (14), lockwasher (13), and nut (15) to secure shroud.
NOTE: Coolant reservoir must be installed with the fan shroud. Connect the fan clutch wire. Replace the upper radiator hose. Remove the filter minder from the air cleaner cover and replace it with grommet plug. Install the air cleaner assembly. Replace the engine coolant. Connect battery cables. Run the engine and check for proper belt tracking. Adjust if necessary.

04/12

NOTE: Recommend no larger than 1.75 CID pump or 15hp draw.

CMKD04-5900-P6-AC

2003-2007 Dodge, R-250, 350

5.9ISB Cummins Diesel

With A/C only

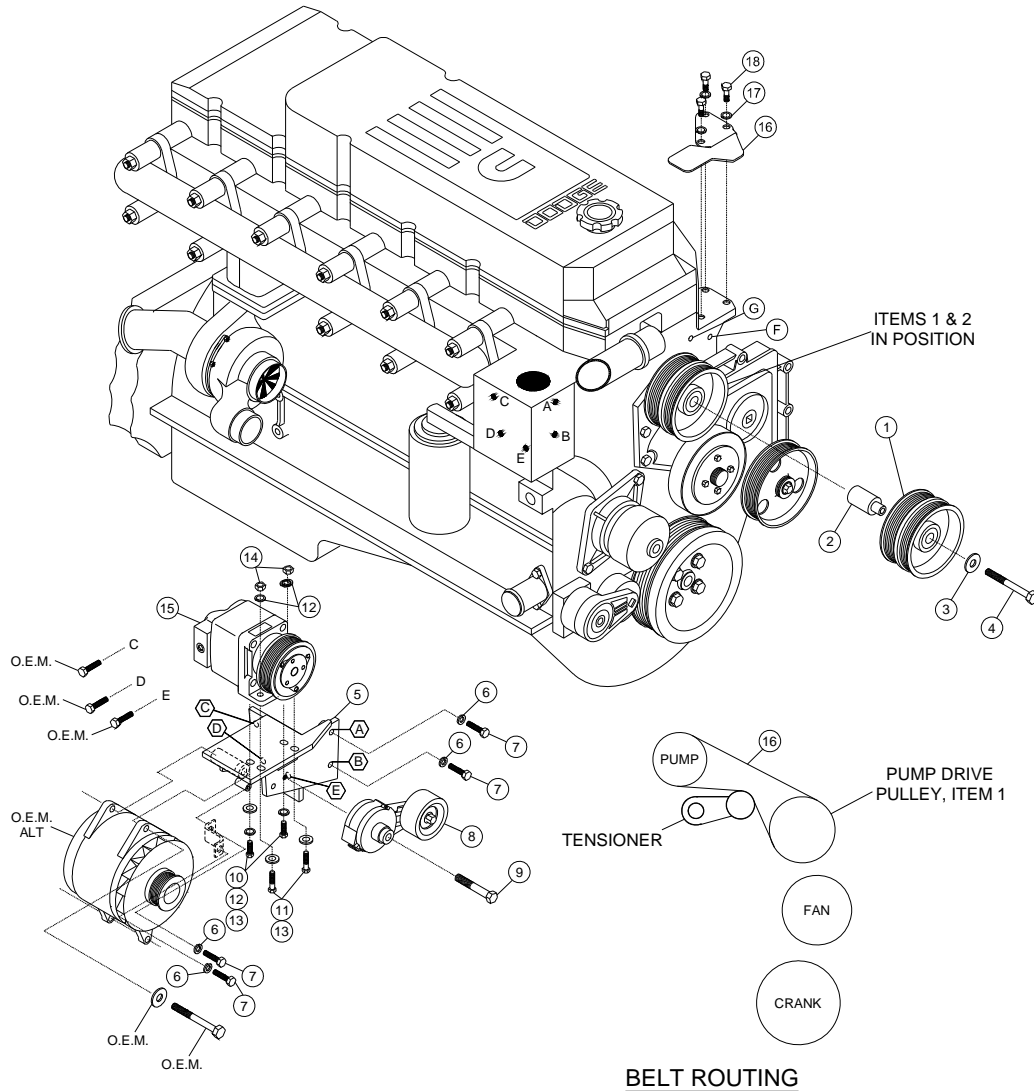

PARTS LIST

- | | |
|---------------------|--|
| 1. DPC 556 (1) | 10. DMB 551 (1) |
| 2. DMB 550 (1) | 11. 3/8 x 1 NC (3) |
| 3. 3/8 FW (1) | 12. 3/8 x 1 1/2 NC (2) |
| 4. 10mm x 105mm (1) | 13. 3/8 LW (5) |
| 5. DMP 551 (1) | 14. 3/8 FW (5) |
| 6. 8mm LW (2) | 15. 3/8 Nut (3) |
| 7. 8mm x 35mm (2) | 16. Clutch Pump (<i>Sold Separately</i>) |
| 8. 8920236 (1) | 17. Pump drive belt (1) |
| 9. 12mm x 80mm (1) | Dayco 5060415 |