



**Muncie<sup>®</sup>  
Power  
Products**

**CMKF03-6001-YP6-AC**

**2003-2007 Ford Truck F-250-550**

**6.0 Diesel**

**W-WO/AC, W/Dual Alt.**

## **INSTALLATION NOTES**

1. Disconnect the negative battery cables. Drain the engine coolant. Remove the upper radiator hose and overflow tube from the radiator. Disconnect the fan clutch wire. Remove the two bolts from the fan shroud. Using a flat bar against the top of the radiator, pry up on the fan shroud to free it from the diffuser. Raise the fan shroud approximately one foot. With the fan shroud raised, remove the fan clutch wire harness from the fan diffuser so the fan shroud can be removed completely without breaking the plastic wire support. Remove the five bolts (*'04 models have 4 bolts*) from the fan diffuser. Remove the fan from the water pump (*fan clutch has right hand threads*), then remove the diffuser and fan together from the engine compartment. Remove the passenger side charge air cooler tube.
2. Remove the auxiliary alternator belt and main drive belt. Remove the bolts from the primary alternator at locations "A" & "B". Remove the bolt from the auxiliary alternator at location "C", and install the 10mm x 145mm stud (18) at that location. Remove the other two auxiliary alternator bolts. Install the clutch pump bracket (17) onto the stud at location "C" as per the illustration using bolts (19), lockwashers (2) and nut (8). Torque bolts and nut to 35 ft/lbs. Install brace (21) using bolts (24) with lockwashers (2) and flatwashers (15) to the primary alternator at locations "A" & "B", and bolt (20) with lockwasher (2), and flatwasher (15) to the back of bracket (17). Tighten bolts evenly, then torque to 35 ft/lbs.
3. Remove the OEM idler at locations "G". Remove the bolt and washer from the idler, then install the idler back to its original location reusing the OEM washer (3) and stud (4). Torque to 35 ft/lbs. Install the main drive belt (refer to the belt diagram on the trucks radiator support for the belt routing).
4. Remove both OEM idlers from the engine at locations "F" & "H". One of these idlers will be reused. Install bracket (1) onto the engine with bolts (7), lockwashers (2), and spacers (6) at locations "F" & "H", and nut (8) with lockwasher (2) and spacer (5) at location "G". Torque bolts and nut to 35 ft/lbs. Install one of the OEM grooved idlers with bushing (9), bolt (12), and flatwasher (11) at location "E". Install the flat idler (10) with bushing (9), bolt (12) and flatwasher (11) at location "D". Torque both idler bolts to 40 ft/lbs.

**If vehicle is equipped with an automatic transmission:**

Remove the nut holding the transmission dipstick tube to the valve cover bolt. Install the dipstick tube brace (31) onto the stud with the OEM nut. Install the dipstick onto the brace with nut (32). This should allow enough clearance to run the hydraulic hoses between the transmission dipstick tube and the engine oil fill spout.

*(continued on back side)*

5. Remove the passenger side battery. With a suitable tool, cut the flange with the two holes in it from the battery tray. Remove any sharp edges. Reinstall the battery, and move it as close to the fender as possible.
6. Install the clutch pump onto bracket (17) with bolts (22) lockwashers (23). Install coil and clutch as per manufacturer's instructions. Tighten bolts securely. Install pump drive belt according to belt diagram.
7. Cut the fan diffuser as necessary to clear the belt, idler and clutch pump. Install the diffuser and fan. Install the fan shroud, upper radiator hose and overflow tube. Install the 90° rubber elbow onto the charge air cooler with the opening pointing up. Install cooler tube (39) with the long end down, the 3" coupler (37), and the 2-1/2" steel tube (38). Rotate the OEM elbow on the turbo until it aligns with tube (38). Install tube rest (47) onto the inside alternator bolt and point it towards the front. Install the adel clamp (44) around the turbo tube and hold it into place with bolt (45). Once turbo is aligned, tighten all clamps securely.
8. Replace the antifreeze and connect the battery cables. Run the engine and check for proper belt tracking and clearances.

# CMKF03-6001-YP6-AC

2003-2007 Ford Truck F-250-550

6.0 Diesel

W-WO/AC, W/Dual Alt.

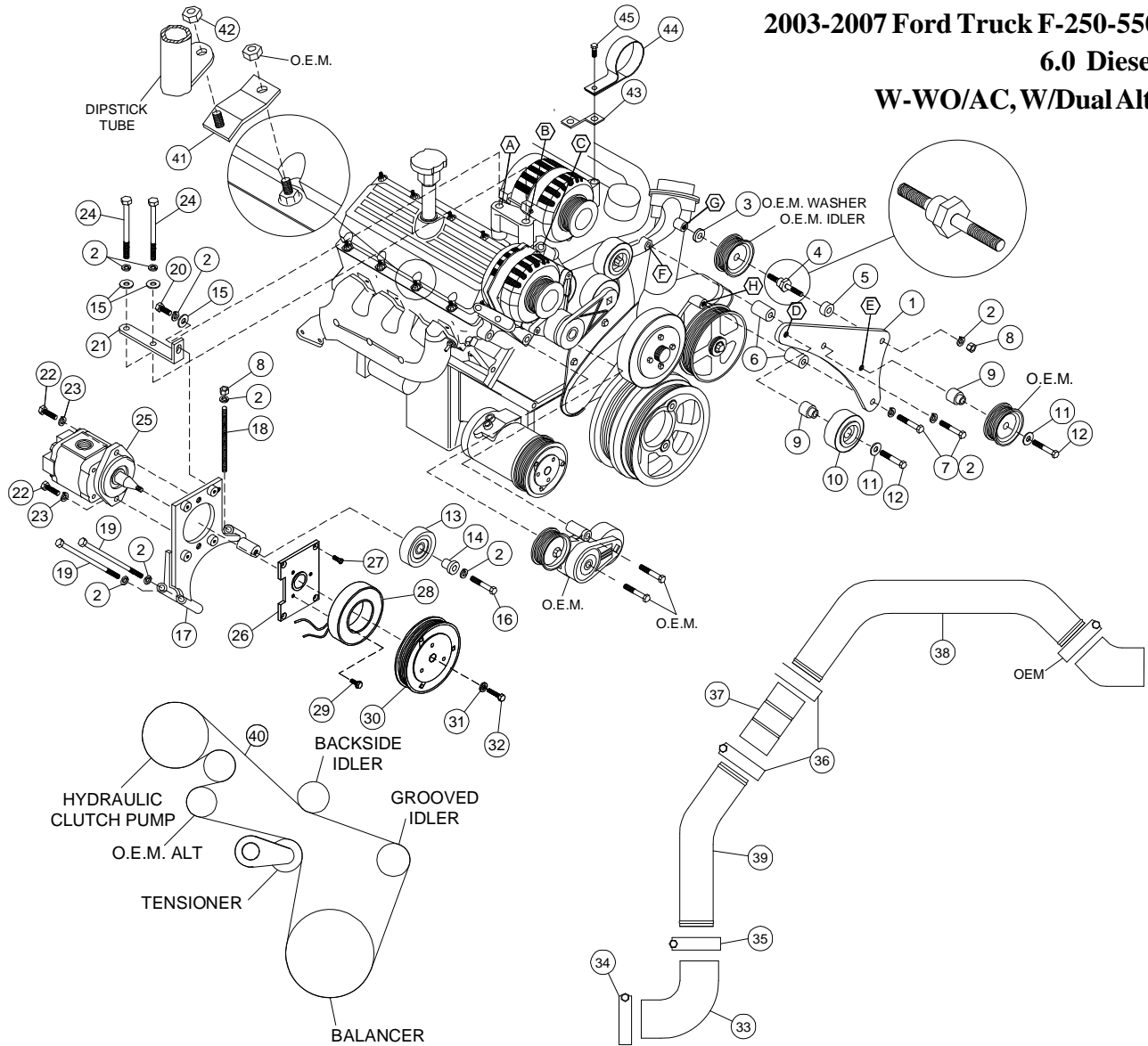

## BELT ROUTING

## PARTS LIST

- |                          |   |   |
|--------------------------|---|---|
| 1. FMB 680DA (1)         | 16. 10mm x 40mm 10.9 (1)                      | 31. FMB 688 (1) Dipstick Tube Brace     |
| 2. 10mm LW (10)          | 17. FMP 681ADA (1)                            | 32. 1/4 NC Nut (1)                      |
| 3. OEM Washer            | 18. 10mm x 5-3/4 Allthread                    | 33. TP 140 Rubber Elbow (1)             |
| 4. 1080ST (1)            | 19. 10mm x 150mm (2)                          | 34. 250-87 Hose Clamp (1)               |
| 5. FMB 682 (1)           | 20. 10mm x 25mm 10.9 (1)                      | 35. 250-84 Hose Clamp (1)               |
| 6. FMB 683 (2)           | 21. FMB 685DA (1)                             | 36. O.E.M Hose Clamps (2)               |
| 7. 10mm x 65mm 10.9 (2)  | 22. 3/8 x 1 1/4 NC (2)                        | 37. O.E.M. Coupler (1)                  |
| 8. 10mm Nut (1)          | 23. 3/8 LW (2)                                | 38. ST256030 2-1/2 Steel Tube (1)       |
| 9. FMB 684DA (2)         | 24. 10mm x 90mm 10.9 (2)                      | 39. ST30-325-55 3" Steel Tube (1)       |
| 10. TIPCS (1)            | 25. Clutch Pump Assembly<br>(Sold Separately) | 40. 5060900 Dayco (1) (Pump Drive Belt) |
| 11. 12mm FW (3)          | 26. ST30-325-55 3" Steel Tube (1)             | 41. FMB 688 (1) Dipstick Tube Brace     |
| 12. 12mm x 45mm 10.9 (2) | 27. 250-84 Hose Clamp (1)                     | 42. 1/4 NC Nut (1)                      |
| 13. TIPCSS (1)           | 28. TP 140 Rubber Elbow (1)                   | 43. FMB 6812 Cooler Tube Rest (1)       |
| 14. CMB 38               | 29. 250-87 Hose Clamp (1)                     | 44. 2-1/2 Adel Clamp (1)                |
| 15. 10mm FW (3)          |   | 45. 8mm x 25mm Flange Bolt (1)          |