



**Muncie®  
Power  
Products**

**CMKF04-3126-YP8-AC**

**2003-2009 Ford Truck 650**

**CAT 3126, W-WO/AC**

---

## **INSTALLATION NOTES**

---

1. Disconnect negative battery cable. Remove innercooler tube and both rubber elbows. Remove Alternator bolts one at a time and replace them with allthread (3) and nuts (4). Torque to 35 ft. lbs.. Install spacer (2) onto each of the alternator studs. Install the pump bracket (1) with nuts (4) and lockwashers (5). Move O.E.M. idler from location "A" to location "B".
2. Install pump with bolts (11), lockwashers (12), and nuts (13). Align clutch pulley with the drive pulley and tighten bolts. Install idler (7) with spacer (6) and bolt (9), onto bracket (1) in location "E", with bolt (8) and flatwasher (7). Install belt (26) as shown in belt diagram. Install new innercooler tube (21) with new elbows (22, 23) and clamps (24, 25). Reconnect battery cable.

# CMKF04-3126-YP8-AC

2003-2009 Ford Truck 650

CAT 3126, W-WO/AC

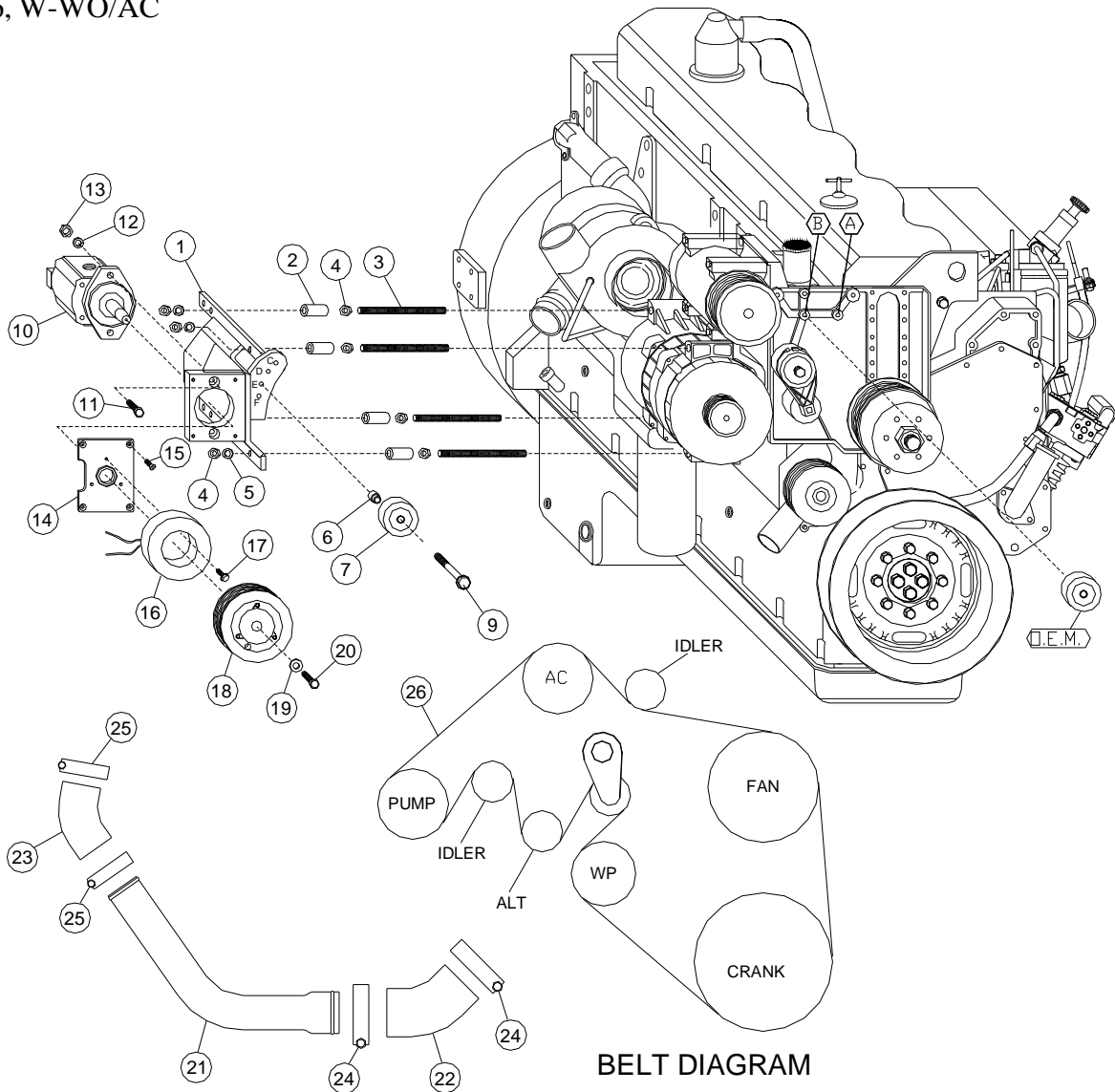

**BELT DIAGRAM**

## PARTSLIST

- |   |  |
|---|--|
| 1. FMB 931 (1)                                | 15. 1/4 x 3/4 NC FHSCS (4)                   |
| 2. FMB 932 (4)                                | 16. Coil (Sold Separately)                   |
| 3. 10mm Allthread (4)                         | 17. Capscrew-19T34530 (3)<br>(t=8-10 ft/lbs) |
| 4. 10mm Nut (8)                               | 18. Clutch (Sold Separately)                 |
| 5. 10mm LW (4)                                | 19. Flat Washer-21MZ3487 (1)                 |
| 6. FMB 935 (1)                                | 20. Capscrew-19T38756 (1)<br>(t=20 ft/lbs)   |
| 7. 89016 (1)                                  | 21. 3-55-ST 3" Steel Elbow (1)               |
| 8. NOT USED                                   | 22. 3 1/2" Rubber Elbow (1)                  |
| 9. 10mm x 40mm Flanged bolt(1)                | 23. 3" Rubber Elbow (1)                      |
| 10. Clutch Pump Assembly<br>(Sold Separately) | 24. 3-1/2" Hose Clamp (2)                    |
| 11. 3/8 x 1-1/2 NC (2)                        | 25. 3" Hose Clamp (2)                        |
| 12. 3/8 LW (2)                                | 26. Belt; 5081000 Dayco                      |
| 13. 3/8 Nut NC (2)                            |  |
| 14. MCA01 Clutch Mtg Plate (1)                |  |