



INSTALLATION NOTES

1. Disconnect the negative battery cable. Drain the engine coolant. Remove the upper radiator hose and overflow hose from the radiator. Remove the air duct. On 5.4L engines, remove and discard the air duct brace. Remove the fan and fan shroud. (Fan nut has right hand thread.)
2. Clean any dirt or rust from the damper then install the drive pulley (1) onto the damper with bolts (2) & lockwashers (3). Torque to 40 ft. lbs.
3. Remove the two nuts from the studs at locations "A" and "B". Remove the radio noise suppressors and torque the studs to 25 ft. lbs. **(IMPORTANT) Replace the radio noise suppressors back onto the studs. On 2011 6.8L engines use shim (29) and nut (30) at location (B).** Remove the bolt from the idler at location "C". **Do not remove the idler.** If the heater hose at location "H" comes in contact with the bracket, cut off as indicated in illustration. Expand the steel band holding the check valve. Push the check valve past the 90° bend and crimp the steel band back on the hose to secure the check valve. Reconnect the heater hose. The heater hose should now turn back toward the cab instead of up and then back. Re-route the wires that run across the front of the passenger side valve cover to allow the bracket to be installed without pinching any of the wires. *Note: On 05-07 5.4L engines, it may be necessary to trim the plastic nipple from the air cleaner box. On 08 and newer chassis the resonator will need to be cut from the the air intake tube as shown and capped with the plug (27) and grommet (28) provided in the kit.* Install the main bracket onto the engine with the O.E.M. nuts at location "A" and "B", lockwasher (7) with bolt (5) at location "D", and lockwasher (7) with bolt (6) at location "C". Torque nuts and bolts to 25ft. lbs.
4. Install idler (9) with bushing (8), lockwasher (10), and bolt (11) onto the main bracket. Torque the bolt to 35-40 ft. lbs. Install the clutch pump with bolts (15,16, &17). Torque to 35 ft. lbs. Install the coil adaptor plate (18) onto the pump bracket with bolts (19) torque to 10 ft. lbs. Install the coil & clutch as per. manufactures instructions. Install the tensioner (20) with bolt (21). Torque to 25 ft. lbs. Install the drive belt according to the belt diagram. Install the appropriate fan spacer nut.
5. Replace the fan and fan shroud. Install the radiator hose and overflow hose. Replace the air duct. On 5.4L engines, the resonator will need to be cut from the main air duct tube to gain belt cleatance. Connect the battery cable and replace the engine coolant. Make certain any wires that were disturbed during intallation do not come in contact with an hot or moving parts. Run the engine and check for proper belt tracking. Adjust if necessary.

NOTE: Check all engine compartment hoses and electrical wiring that may have been disturbed or rerouted during kit installation to be sure that hoses are not kinked, that they do not touch any high temperature items, and that they do not interfere with any linkage components.

NOTE: On 6.8L trucks equipped with push button 4 wheel drive, an additional bracket kit is required to relocate the vacuum canister. Part # FMB474A

CMKF05-5468-ZP8-AC

2005-2010 Ford F 250-550

5.4L, 6.8L, Triton 3-Valve

2011-Current 6.8L Engines

W-W/O AC, W/O Bearing Support

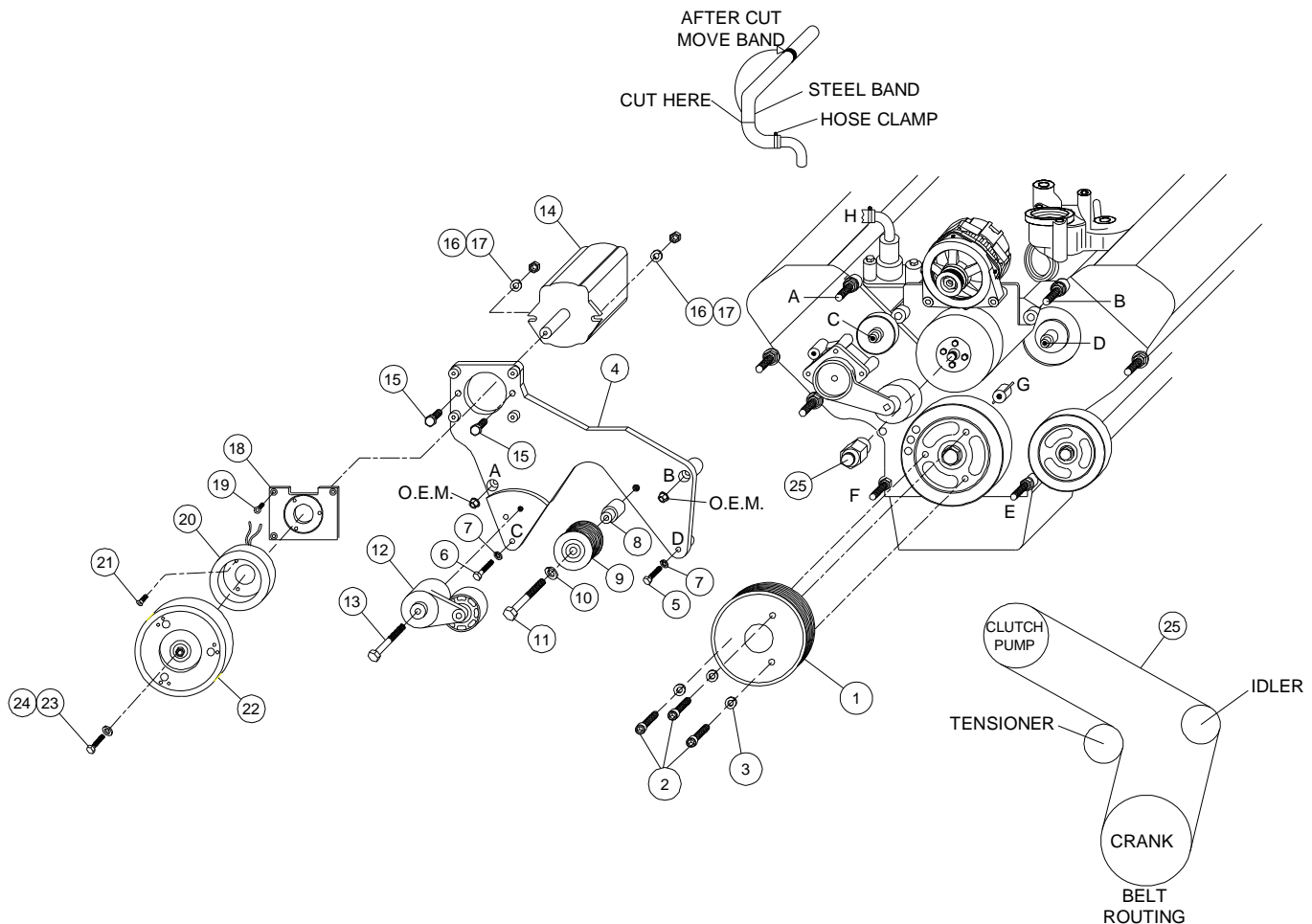

PARTS LIST

- | | |
|--|--|
| 1. FPC 368 (1) | 18. MCA01 (1) |
| 2. 10mm x 60mm (3) | 19. 1/4 x 3/4 NC FHSCS (4) |
| 3. 10 mm LW (3) | 20. Coil (1) <i>(Sold Separately)</i> |
| 4. FMB 47A (1) | 21. Cap Screw 19T34530 (3) (t=8-10 ft. lbs.) |
| 5. 8mm x 35mm (1) | 22. Clutch (1) <i>(Sold Separately)</i> |
| 6. 8mm x 45mm (1) | 23. Flat Washer 21MZ3487 (1) |
| 7. 8mm LW (2) | 24. Cap Screw 19T38756 (1) (t=20 ft. lbs.) |
| 8. FMB 473 (1) | 25. 5080705 Dayco(1) |
| 9. GPCD8P (1) | 26. FSK37R (Used on 5.4L Only) (1) |
| 10. 12mm LW (1) | FSK6.8A (Used on 6.8L Only) (1) |
| 11. 12mm x 75mm (1) | 27. Aluminum Plug 1012646(5.4L) |
| 12. 89200 B Dayco (1) | 1012647 (6.8L) |
| 13. 10mm x 80mm (1) | 28. Rubber Grommet 1013038 (5.4L) |
| 14. Clutch Pump (1) <i>(Sold Separately)</i> | 1007870 (6.8L) |
| 15. 3/8 x 1-1/2 NC (2) | 29. .040" x 8mm Shim Washer (1) |
| 16. 3/8 LW (2) | 30. 8mm Flange Nut (1) |
| 17. 3/8 Nut (2) | |

MODIFICATIONS SHEET

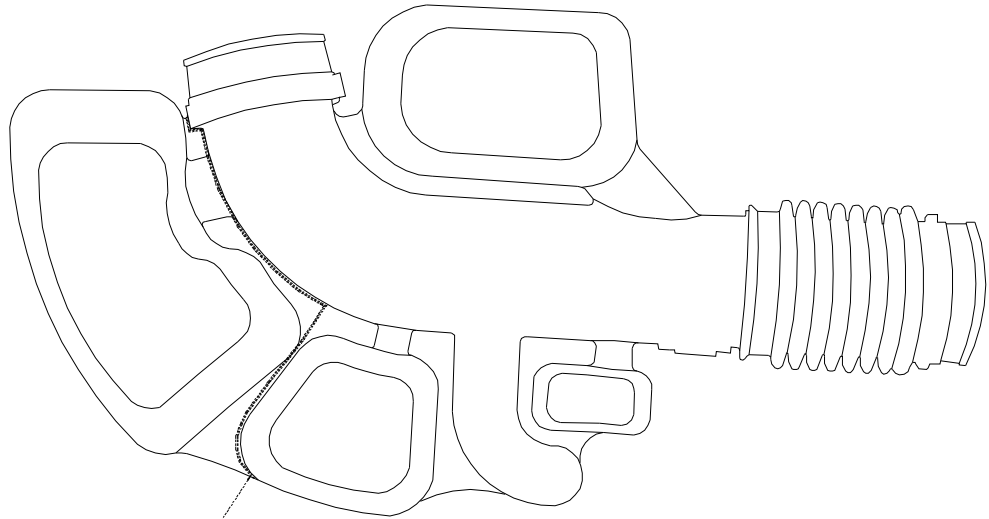

5.4L TRITON
CUT HERE

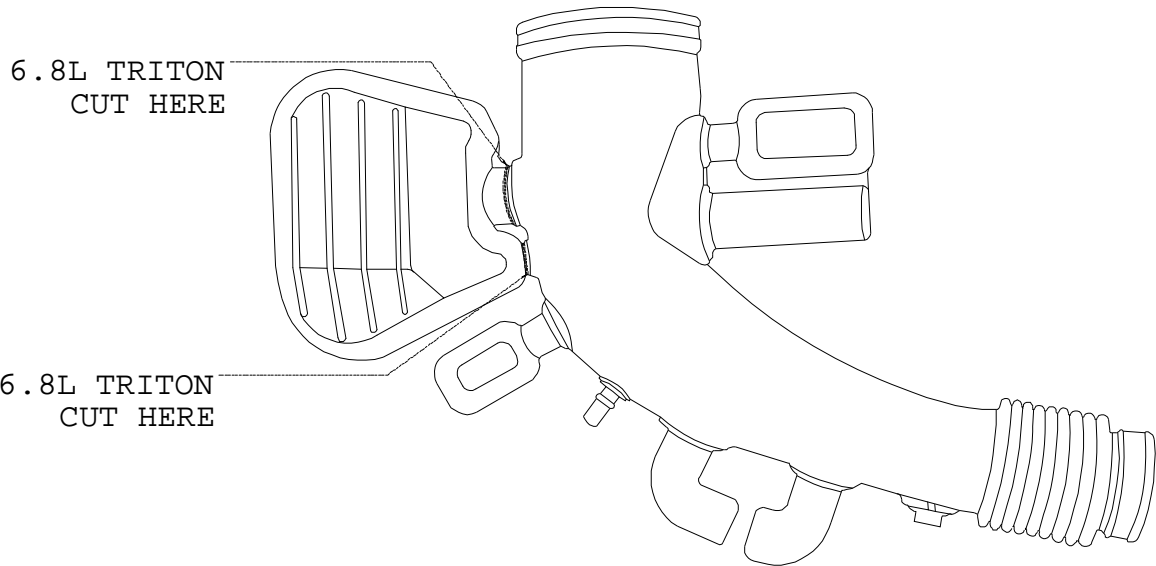

6.8L TRITON
CUT HERE

6.8L TRITON
CUT HERE

**2009 AND NEWER
MODIFICATION ONLY**

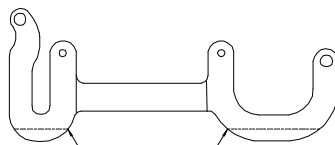

CUT ALONG LINE.
APPROX. 1/2"