



Muncie[®]
Power
Products

CMKF88-4600-A-AC
CMKF88-4600-AH-AC
1988-97 Ford
F-250,350,Super Duty
460 W-WO/AC
(2 poly v-belts)

INSTALLATION NOTES

1. Disconnect battery terminal. Loosen both poly v-belts. Remove fan and shroud.
2. Remove belts from pulley on crankshaft. Install drive pulley (1) with provided bolts and lockwashers.
CAUTION: Be sure bolts have the same threads as O.E.M. bolts removed.
NOTE: Be sure center bolt on crankshaft pulley is torqued to 70-90 ft/lbs.
3. Remove bolt from alternator bracket at location "A", where alternator bracket fastens to head. It is hidden by heater hoses.
4. Install mounting bracket (8) using bolt (11) at location "A". Locations "B,C & D" are the three exposed tapped holes on water pump. Location "B" (no spacer) use bolt (14), location "C" (short spacer) use bolt (13), location "D" (long spacer) use bolt (12). **NOTE:** Bracket (8) has been notched to allow clearance for the small water hose going to throttle body. Be sure hose is not rubbing or pinched by bracket. Tighten bolts at all locations.
5. Put fan and shroud back in place, secure shroud. Due to limited fan to radiator clearance, it may be necessary to assemble fan, spacer (4) and studs (5) together before installing onto water pump. Thread studs completely into water pump before installing lockwashers and nuts (6 & 7). Secure fan.
6. Install pump (19) to pump plate (9) with provided bolts. **NOTE:** Install bolts through plate with nuts to pump flange. Do not tighten.
7. Install plate (9) to bracket (8) with provided bolts. Align clutch pulley to drive pulley (1), tighten pump bolts securely.
8. Install and tension O.E.M. belts. Install pump drive belts (18), adjust pump plate (9) for proper belt tension, tighten bolts (10 & 12). Connect battery.
9. **CAUTION:** Check all engine compartment hoses and wiring to insure they are not kinked, touching any high temperature item, or do not interfere with any linkage components.
NOTE: Due to O.E.M. assembly tolerances, visually make certain that there is adequate clearance between fan and drive pulley and also fan to radiator. It may be necessary to use a longer spacer for pulley clearance. If there is little clearance to the radiator - *provide adequate clearance between fan and radiator before operating.*

CMKF88-4600-A-AC
CMKF88-4600-AH-AC
 1988-97 Ford 460 W-WO/AC
 (2 ea. poly v-belts)

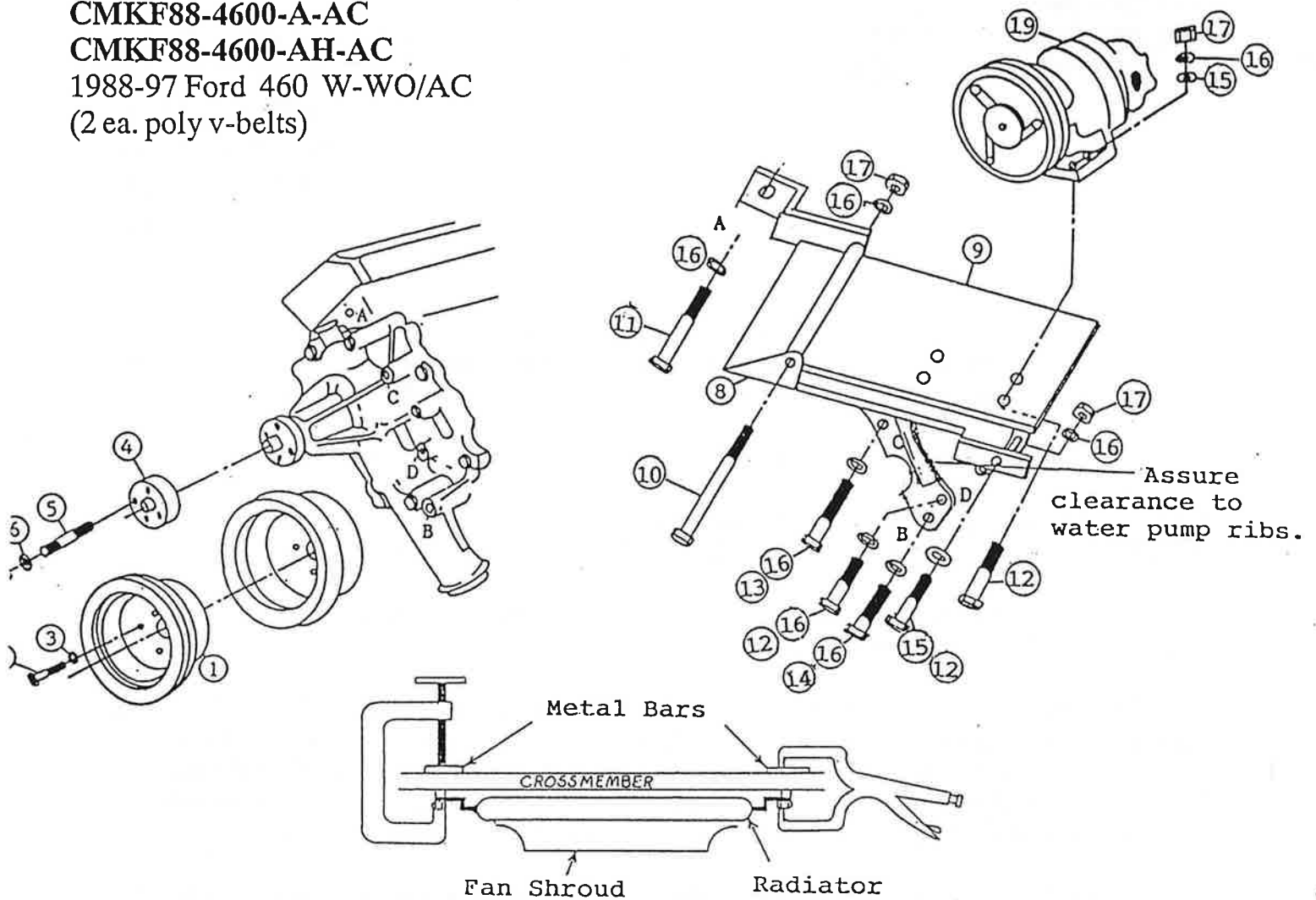

PARTS LIST

- | | |
|------------------------|---------------------------------------|
| 1. FPC 422 (1) | 11. 3/8 X 1 3/4 NC (1) |
| 2. 3/8 X 1 3/4 NC (4) | 12. 3/8 X 1 1/2 NC (6) |
| 3. 3/8 LW (4) | 13. 3/8 X 1 1/4 NC (1) |
| 4. FSO 610 (1) | 14. 3/8 X 1 NC (1) |
| 5. 5/16 X 2 3/4 ST (4) | 15. 3/8 FW (5) |
| 6. 5/16 LW (4) | 16. 3/8 LW (10) |
| 7. 5/16 NC (4) | 17. 3/8 NC (6) |
| 8. FMB 430 (1) | 18. AX-56 (2) H.D.: AX-58 (Not Shown) |
| 9. FMP 431 (1) | 19. Clutch Pump Assembly (1) |
| 10. 3/8 X 6 NC (1) | (Sold Separately) |

NOTE: To obtain an additional 1/4"-3/8" fan to radiator clearance, carefully apply pressure on heads of upper radiator support bolts. An additional 1/2" fan to radiator clearance may be gained by loosening six cab mounting bolts and moving cab forward on frame, tighten bolts. Clutch or auto trans. linkage adjustment may be necessary.