



**Muncie®  
Power  
Products**

**CMKF99-7300-YP8**

**1999-2002 Ford Truck 250-550**

**7.3 D.I.T. Intercooled Diesel  
WO/AC**

## **INSTALLATION NOTES**

---

1. Disconnect the negative battery cables. Using a 1/2 inch breaker bar, release the tension on the belt and remove it from the idler pulley that's located just above the spring tensioner. Remove the idler and bracket from the O.E.M. tensioner bracket.
2. Install the pump plate (1) onto the tensioner bracket using bolts (2), lockwashers (3) and flatwashers (4). Do Not Tighten. Install pump (10) into the pump plate using bolts (5), flatwashers (6), lockwashers (7) and nuts (8) as shown in the illustration. Torque bolts to 35 ft/lbs.. Install coil adapter plate (13) onto bracket (1) using bolts (14). Install magnet and clutch pulley onto the pump as per clutch pulley instructions. Using a straight edge align the clutch pulley with the other pulleys on the engine, torque the pump plate bolts at 20-25 ft/lbs..
3. Install the belt back to its original belt routing. Connect the battery cables and run the engine to make sure the belt tracks properly.

**NOTE:** A new belt comes with the mounting kit, if the O.E.M. belt is in good condition, the new belt should be stored in the truck for future use. If the O.E.M. belt is cracked and worn, it is advisable to install the new belt.

**CMKF99-7300-YP8**  
**1999-2002 Ford Truck 250-550**  
**7.3 D.I.T. Intercooled Diesel**  
**WO/AC**

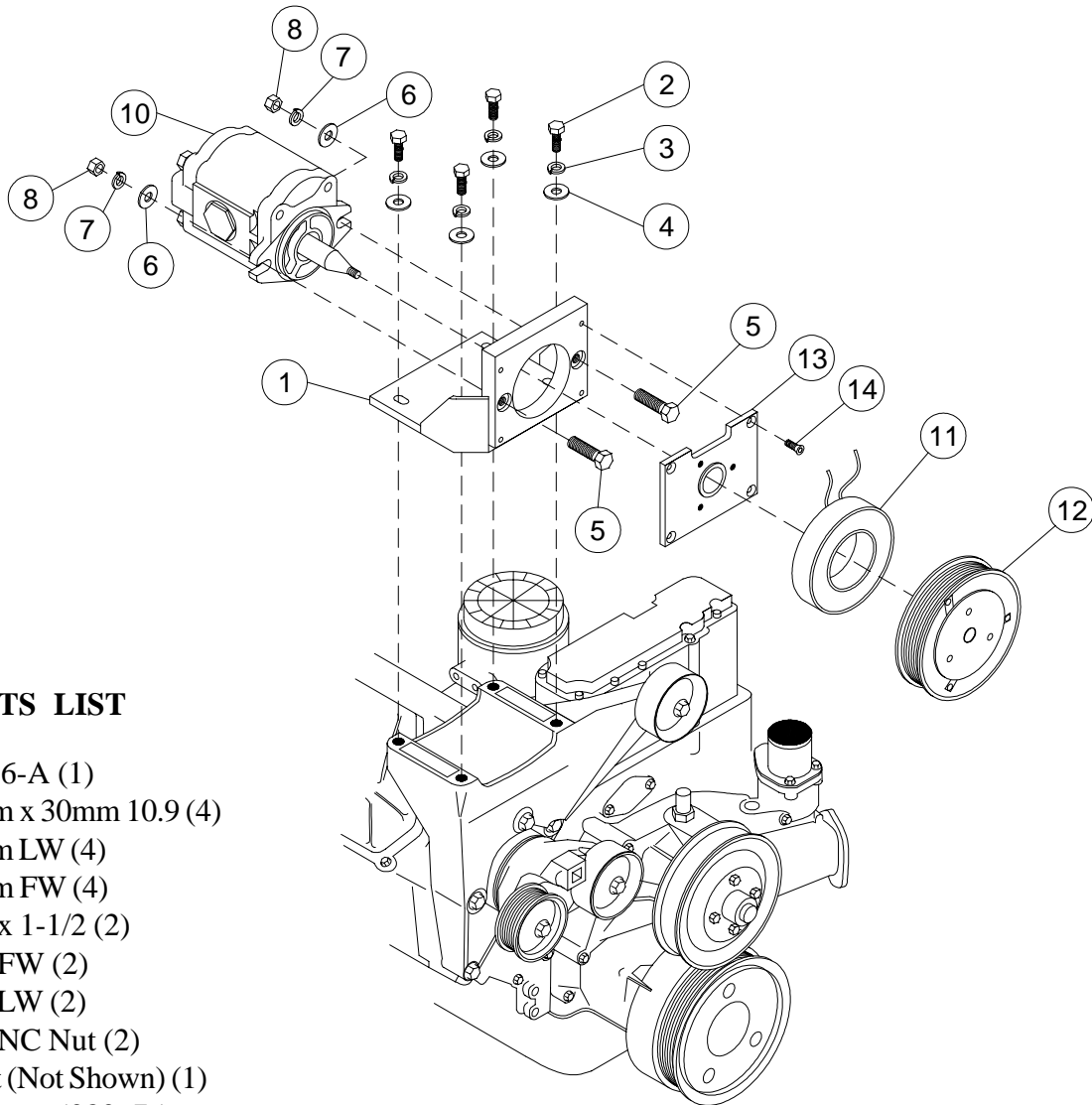

**PARTS LIST**

- 1. FP66-A (1)
- 2. 8mm x 30mm 10.9 (4)
- 3. 8mm LW (4)
- 4. 8mm FW (4)
- 5. 3/8 x 1-1/2 (2)
- 6. 3/8 FW (2)
- 7. 3/8 LW (2)
- 8. 3/8 NC Nut (2)
- 9. Belt (Not Shown) (1)  
Dayco 5080675
- 10. Pump (*Sold Separately*)
- 10. Coil (*Sold Separately*)
- 10. Clutch (*Sold Separately*)
- 13. MCB001A (1)
- 14. 1/4 x 3/4 NC FHSCS (4)