



## CMKM00-3126-A-AC

2000-02 Freightliner FL-60 & 70

2000-02 Sterling w/3126 Cat

### INSTALLATION NOTES

---

1. Disconnect negative battery cable(s). Remove the OEM serpentine belt. Remove the fan from the fan pulley. Remove the fan pulley assembly from the engine.
2. Screw a bolt into the fan clutch pilot on the front of the pulley until it pushes the pilot from the pulley. Remove the bolt that holds the pulley onto the spindle. The pulley should lift off the spindle without the use of a press. Remove the snap ring from the back of the pulley and press the bearings out. Install the bearings into the new pulley using a press.  
**NOTE:** Make sure the thick washer is inside the pulley before the bearings are installed. Install the snap ring. Install the pulley back onto the spindle and install the O.E.M. bolt. Install the fan pilot. Install the fan pulley assembly back onto the engine.
3. Remove any clamps or hose standoffs from the front of the timing cover at location "A". Install bracket (2) onto the engine at location "A", with 4 or 5 of bolts (4) and lockwashers (5). Torque bolts to 40/ft. lbs.. Install pump assembly (11) onto plate (3) with pump bolts packed in the kit. Align the pump clutch with the drive pulley, then tighten the pump bolts securely. Install the OEM serpentine belt. Install the pump belts and tension properly. Replace the fan. Secure any wires, hoses, etc. that may have been moved during assembly. Reconnect the batter cables. Run the engine and check for proper belt tracking, realign if necessary. Retention the belts after 30 minutes of run time.

**CAUTION:** Check all engine compartment vacuum hose and electrical wiring that may have been disturbed or rerouted during kit installation to be sure that hoses are not kinked, that they do not touch any high temperature items, and that they do not interfere with any linkage components.

# CMKM00-3126-A-AC

2000-02 Freightliner FL60 & 70

2000-02 Sterling w/3126 Cat

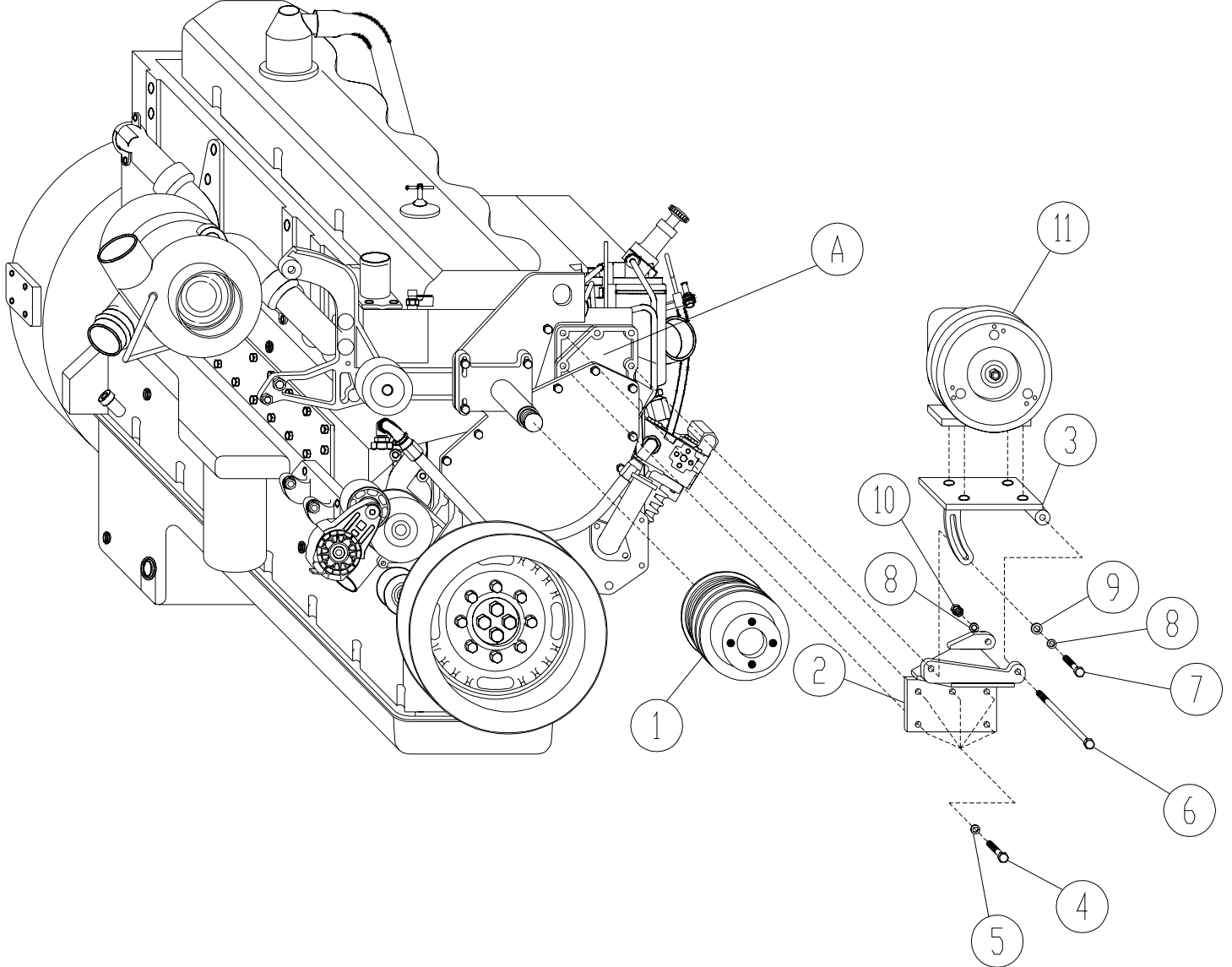

## PARTS LIST

1. LPC 912 (1)
2. FLMB 910 (1)
3. FLMP911 (1)
4. 10mm x 55mm (5)
5. 10mm LW (5)
6. 3/8 x 5 NC (1)
7. 3/8 x 1 1/4 NC (1)
8. 3/8 LW (2)
9. 3/8 FW (1)
10. 3/8 NC (1)
11. Clutch Pump Assembly (1)  
(Sold Separately)
12. Belt: Goodyear 84560(A54F) (Not Shown)