



Muncie®
Power
Products

CMKM00-3126-XP8-AC

2000-02 Freightliner FL-60 & 70

2000-02 Sterling w/3126 Cat

INSTALLATION NOTES

1. Disconnect negative battery cable(s). Remove the OEM serpentine belt. Remove any bolts or claps from the block at location "A".
2. Install bracket (1) with bolts (2) and lockwashers (3) at location "A", torque the bolts to 40 ft/lbs.. Install the pump onto the bracket with the bolts provided and align it with the OEM pulleys. Install the flat idler into the bottom hole in the bracket with bushing (4), flat washer (8) and bolt (7). Install the grooved idler onto the bracket at the other location with bushing (4), flatwasher (8) and bolt (7).
3. Install the new belt onto the engine according to the belt diagram. If the belt is too short, move the flat idler up to the next hole. Check all hoses, wires, etc. that may have been moved during installation to make sure they are not rubbing against any moving parts. Connect the battery and run the engine to check for proper belt tracking.

CAUTION: Check all engine compartment vacuum hose and electrical wiring that may have been disturbed or rerouted during kit installation to be sure that hoses are not kinked, that they do not touch any high temperature items, and that they do not interfere with any linkage components.

CMKM00-3126-XP8-AC

2000-02 Freightliner FL60 & 70

2000-02 Sterling w/3126 Cat

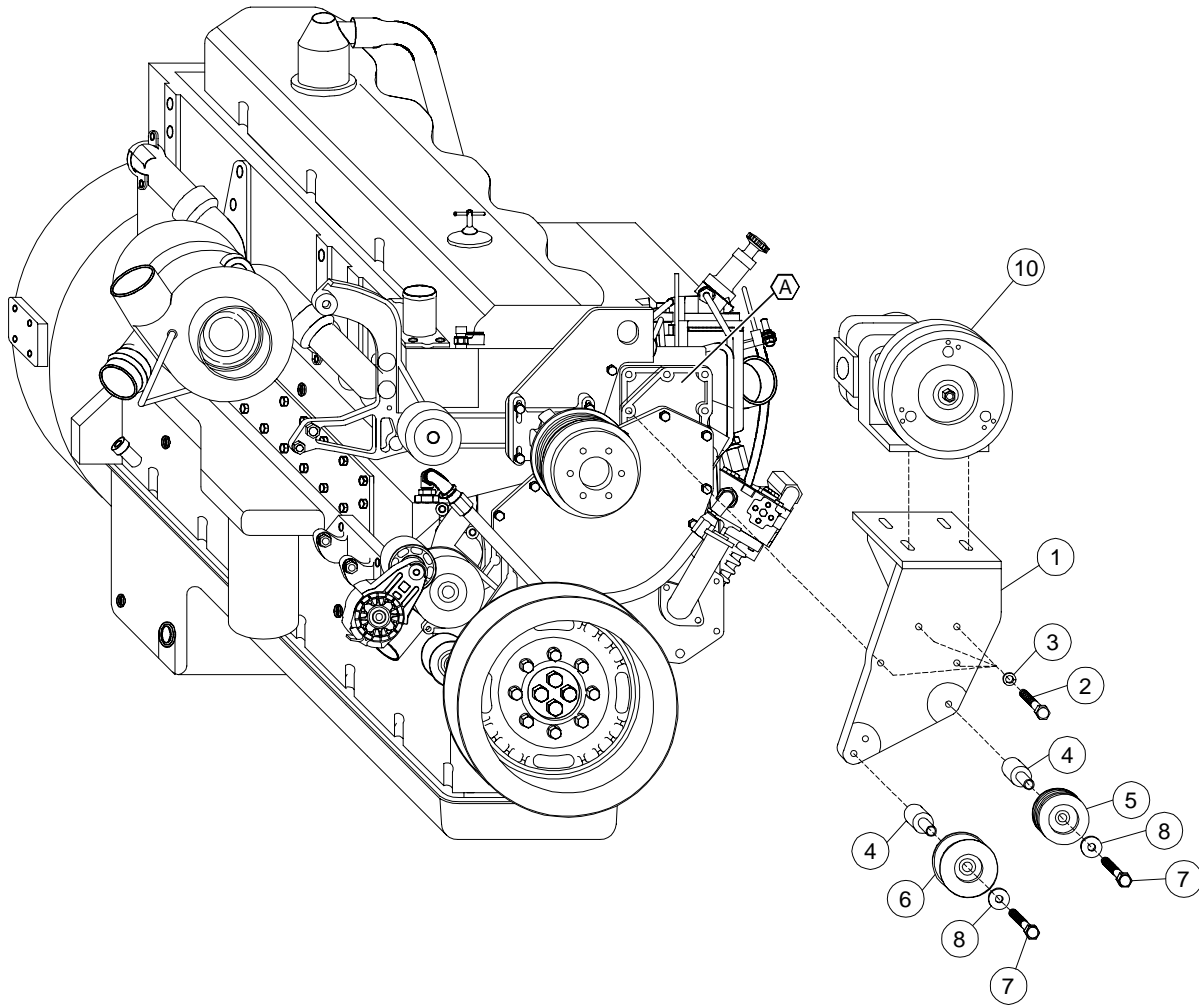

PARTS LIST

1. FLMP 911 (1)
2. 10mm x 55mm 10.9 (4)
3. 10mm LW (4)
4. FLMB 911 (2)
5. GPCD8 (1)
6. IPCD (1)
7. 12mm x 65mm (2)
8. 12mm LW (2)
9. Pump Belt (Not Shown) (1)
Dayco # 5081223
10. Clutch Pump Assembly
(Sold Separately)

