

CMKM04-3126-XP8-AC

2004-08 Freightliner M2

CAT 3126, W/AC

INSTALLATION NOTES

1. Disconnect negative battery cable. Remove innercooler tube and both rubber elbows. Remove the four alternator bolts one at a time and replace them with studs (3) and nuts (4). Torque to 35-40 ft/lbs. Install spacers (2) onto each of the four alternator studs. Install the pump (12) onto the pump plate (1) with bolts (13) and lockwashers (14). (DO NOT TIGHTEN). Install the pump and plate assembly onto the four alternator studs and secure with lockwashers (5) and nuts (4). Torque to 35-40 ft/lbs. Align the clutch pump pulley with the drive pulley, then tighten the pump bolts securely. Move O.E.M. idler from location "A" to location "B".
2. Install idler assembly (6,7,8) onto bracket (1) at location "E". Install belt (15) as shown in belt diagram. Idler (7) may need to be moved to hole (C,D, or F) to make the belt fit properly.
3. Temporarily install rubber elbow (10) onto the cooler inlet and point it downward. Install the steel tube (9) into the elbow, then replace the OEM tube onto the turbo. Mark the OEM tube and cut it to fit inside tube (9). Once the tube is fitted properly, tack weld it in place, then remove it from the engine and complete the weld. Use silver high heat paint to protect the weld from rust and install it back onto the engine with clamps (11) at the cooler and the OEM clamp at the turbo.
4. Reconnect battery cable. Run the engine and check for proper belt tracking. Adjust if necessary.

NOTE: The steel A/C line may need to be bent slightly to gain adequate clearance to the pump and pump bracket.

CMKM04-3126-XP8-AC

2004-08 Freightliner M2

CAT 3126, W/AC

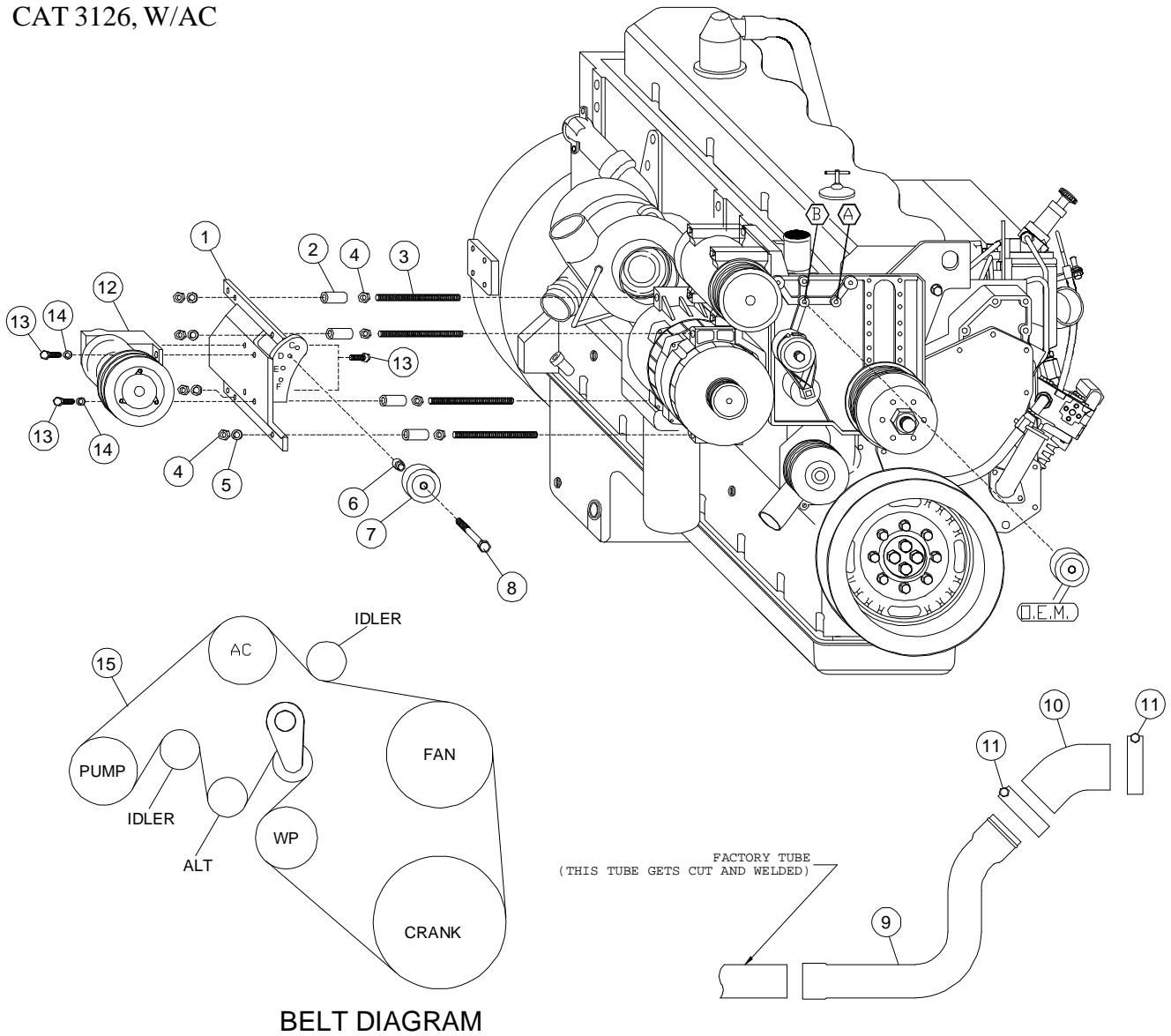

BELT DIAGRAM

PARTS LIST

- 1. FMB 931-I8 (1)
- 2. SP100-1.340 (4)
- 3. 10mm x 180mm Stud (4)
- 4. 10mm Nut (8)
- 5. 10mm LW (4)
- 6. FMB 935 (1)
- 7. 89016 (1)
- 8. 10mm x 40mm Flange Bolt (1)

- 9. FL4590 3" Steel Tube (1)
- 10. TP1189 3 1/2" Rubber Elbow (1)
- 11. 250-92 Hose Clamp (2)
- 12. Clutch Pump Assembly
(Sold Separately)
- 13. 3/8 x 1-1/4 (4)
- 14. 3/8 LW (4)
- 15. 5081000 Belt (1)