



**Muncie®
Power
Products**

CMKN08-6400-P8-AC

2008-10 International 4200 Series

2011-Current TerraStar

2011-Current DurraStar

Max Force 7, W-W/O AC

W/O Air Compressor

INSTALLATION NOTES

1. Install drive pulley(1) onto the engine damper with bolts(2) and lockwashers(3). Torque bolts to 35 ft. lbs.
2. Remove engine lifting lug from the front of the driver's side cylinder head.
3. Install pump bracket(4) with bolts(5) and lockwashers(3). Torque to 30 ft. lbs.
4. Install pump(1) to adapter plate(12) with bolts(13,14), nuts(16) and lockwashers(15). Install pump and adapter plate(12) to bracket(4) with bolts(18), flatwashers (17), and lockwashers(15). Make sure pump is aligned with the drive pulley. Tighten bolts securely.
5. Install idlers(9) using bolts(11), flatwashers(10) and spacers(8). Install tensioner(6) using bolt(7). Install the belt(20) as shown in the diagram.

NOTE: Run engine and check for proper belt tracking. Realign the pump if necessary.

CMKN08-6400-P8-AC
2008-10 International 4200 Series
2011-Current Terra Star
2011-Current Durra Star
MAXXFORCE 7
W-W/O AC W/O Air Compressor

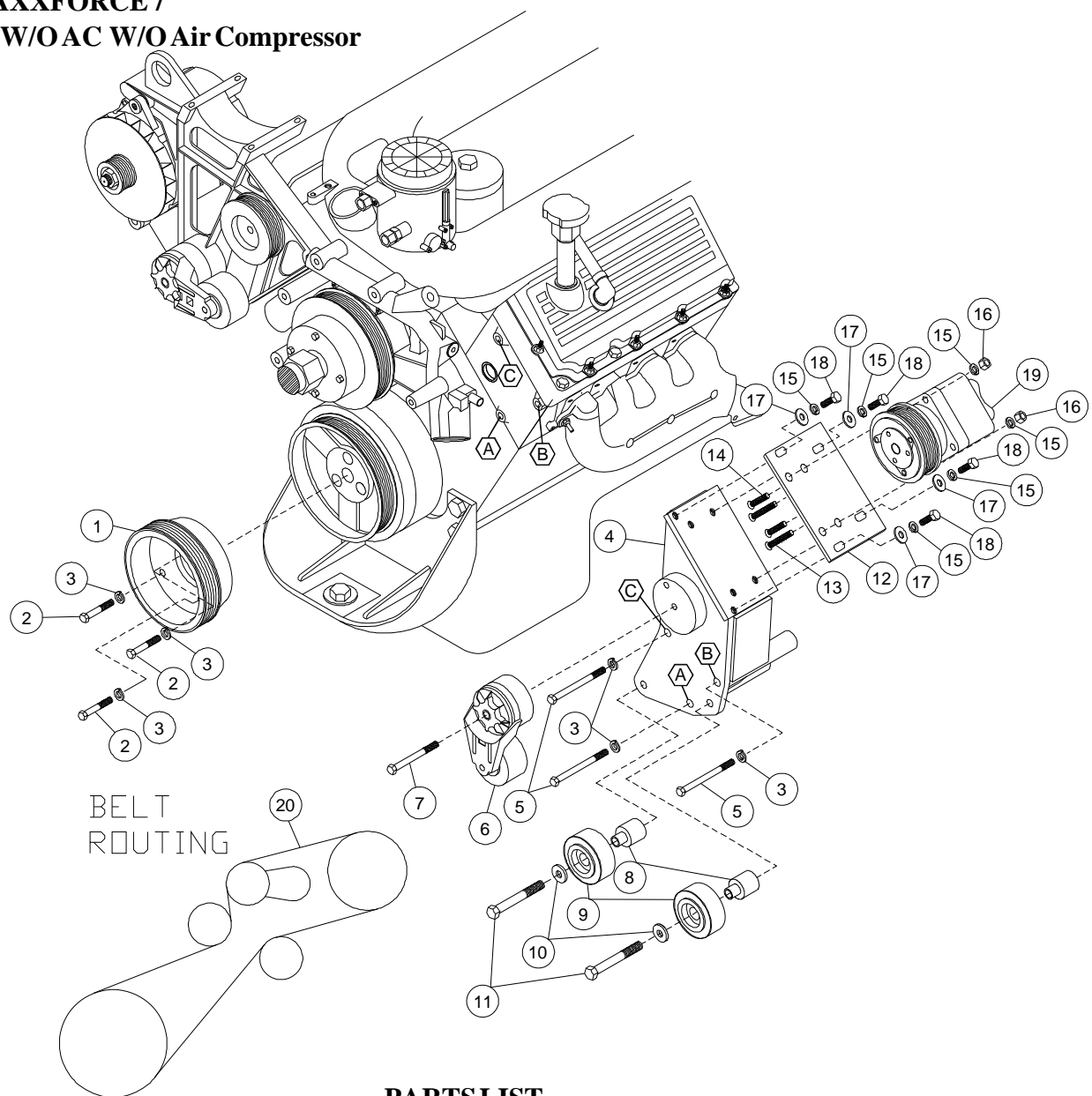

PARTSLIST

- | | |
|----------------------------|---|
| 1. FPC 2608 (1) | 11. 12mm x 75mm (2) |
| 2. 10mm x 50mm (3) | 12. IMP631 (1) |
| 3. 10mm LW (6) | 13. 3/8 x 1 3/4 FHCS (2) |
| 4. IMP 642 (1) | 14. 3/8 x 1 FHCS (2) |
| 5. 10mm x 150mm (3) | 15. 3/8 LW (6) |
| 6. Tensioner 89438-053 (1) | 16. 3/8 Nut NC (2) |
| 7. 10mm x 80mm Bolt(1) | 17. 3/8 FW (4) |
| 8. IMB 641 (2) | 18. 3/8 x 1 NC (4) |
| 9. 89016 Dayco (2) | 19. Clutch Pump Assembly (<i>Sold Separately</i>) |
| 10. 12mm FW (2) | 20. Belt; Dayco 5080685 (1) |