

ASCS-100/ASCT-100 CONTROL VALVE AIR PLUMBING DIAGRAM

PARTS LIST AND DESCRIPTION

ITEM	QTY	PART NO.	DESCRIPTION
1	1	35T36353	PTO/Pump Air Control Valve
2	1	44M30137	Breather
3	3	44MB6842	1/8 N.P.T. Straight Tube Adapter
4	1	45M44430	1/4 Nylon Tubing - 30'
5*	1	NA	Power Take-Off
6	4	44MB6942	1/8 N.P.T. 90° Tube Adapter
7*	1	NA	Pump
8	1	44MB6844	1/4 N.P.T. Straight Tube Adapter
9	1	31M15759	Pressure Protection Valve
10	1	44MB2164	1/4 N.P.T. Pipe Nipple

* Items not included with Air Control Valve Package.

The PTO indicator light must be installed so that it is visible to the operator of the vehicle while seated in the driver's seat. Additional indicator lights may need to be purchased to comply with this requirement.

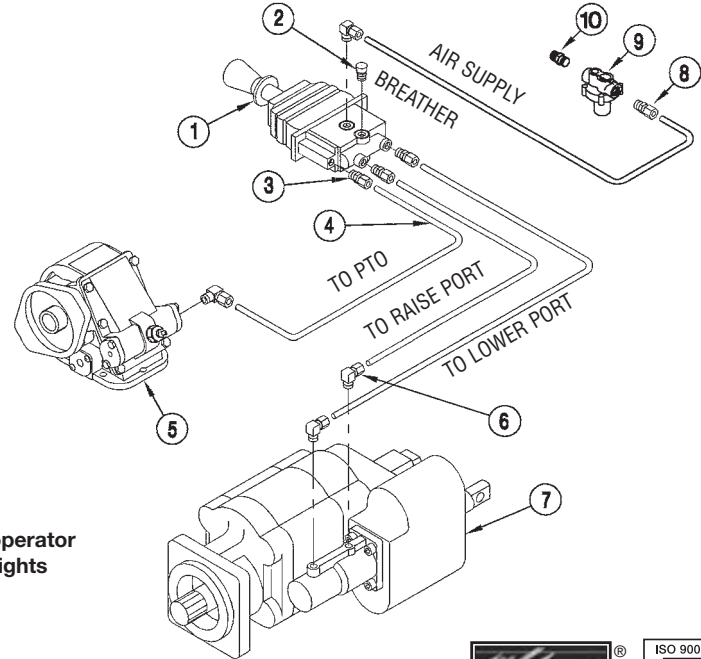

**Muncie®
Power
Products**

IN00-01 (Rev. 9-05) Printed in the U.S.A.
© Muncie Power Products, Inc. 2005

Muncie Power Products, Inc. Member of the Interpump Hydraulics Group
General Offices and Distribution Center • P.O. Box 548 • Muncie, IN 47308-0548
(765) 284-7721 • FAX (765) 284-6991 • E-mail info@munciepower.com
Web site <http://www.munciepower.com>

Drive Products, Inc., Toronto, Exclusive Agents for Canada, ISO Certified by an Accredited Registrar

