

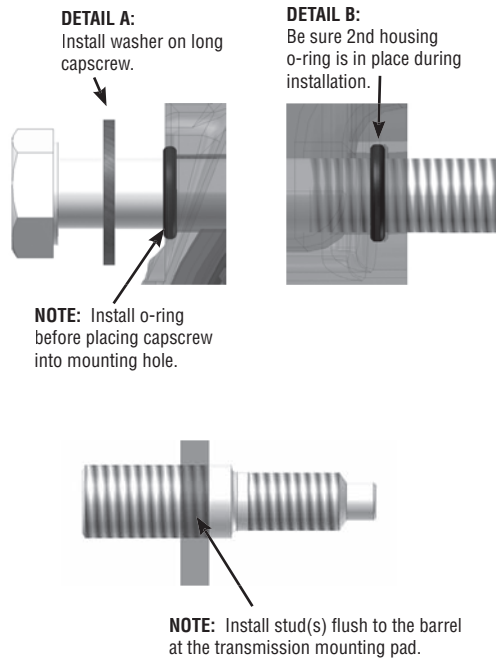

# FR64/67 Thru-Bolt INSTALLATION INSTRUCTIONS

## FR 67 SERIES STUD KIT INSTALLATION

- This stud kit is supplied with two special studs.
- Locate the two shoulder studs (1) and the two spirallock nuts (3) as well as the three step studs (2) and the three \*whiz-lock nuts (4).
- Install the shoulder studs (1) into the "A" and "C" mounting hole locations.
- Install the three step studs (2) into the "B", "E" and "F" mounting hole locations.
- Mount PTO using \*whiz-lock nuts (4) at the three step stud locations.
- Install the two spirallock hex nuts (3) on the two shoulder studs (1) locations following the instructions in the PTO Owner's Manual.
- Install the 6.20" long hex head capscrew (5) into the "D" mounting hole location. Follow diagrams A & B above to ensure proper location of the washer and O-rings supplied in this kit.
- Torque Values:  
3/8" spirallock nut (3) = 40 ft. lb.  
5/16" \*whiz-lock nut (4) = 17 ft. lb.  
9/16" hex head on long bolt (5) = 30 ft. lb.

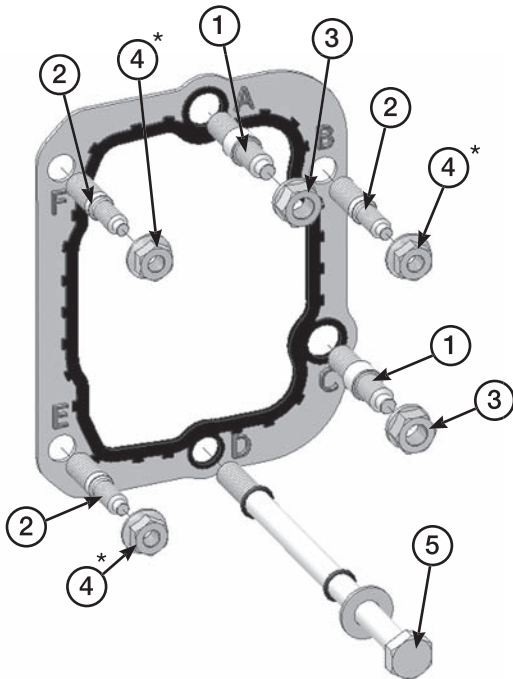
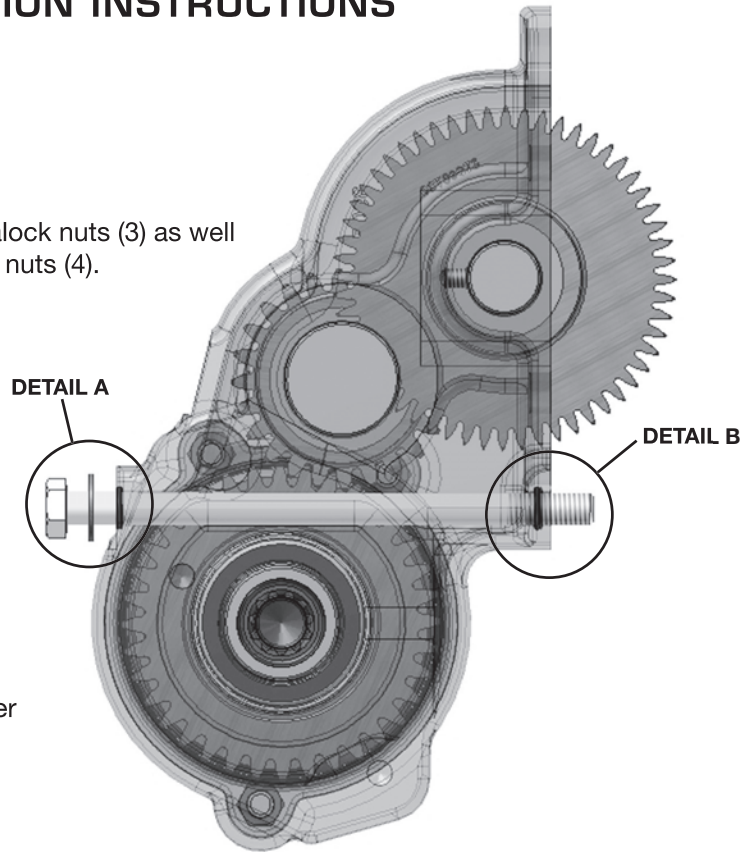

**Muncie Power Products, Inc.** Member of the Interpump Hydraulics Group  
 General Offices and Distribution Center • P.O. Box 548 • Muncie, IN 47308-0548  
 (765) 284-7721 • FAX (765) 284-6991 • E-mail info@munciepower.com  
 Web site <http://www.munciepower.com>

Drive Products, Exclusive Agents for Canada, ISO Certified by an Accredited Registrar

