



DT12 PTO ADAPTER

INSTALLATION INSTRUCTIONS

REQUIRES DEALER PTO PREP PACKAGE

Prior to beginning adapter and PTO installation, verify that the adapter is correct for the transmission! The table below shows the correct adapter P/N for each transmission!

Transmission	Adapter	Adapter Gear P/N
DC (DHE & DV)	No option available	N/A
OC (OHE & OV)	40TA6479	05T64697
OD (OVX)	40TA6480	05T64698

PTO Models (sold separately): TG8S-U68**-*4**

828S-U68**-*4**

1. Before beginning PTO adapter installation, set PARK brake, place transmission in neutral, and start engine. Listen to engine and transmission. Any transmission gear noise may be more noticeable after PTO is installed. STOP ENGINE. NEVER GO UNDER VEHICLE WITH ENGINE RUNNING!
2. Drain the transmission fluid from transmission by removing drain plug. Measure the amount of fluid removed, if it will not be reused. This amount will need to be added back to the transmission after PTO installation is complete.
3. Find PTO opening on transmission.
Remove cover plate and gasket from PTO opening on transmission.

Do not reuse
components

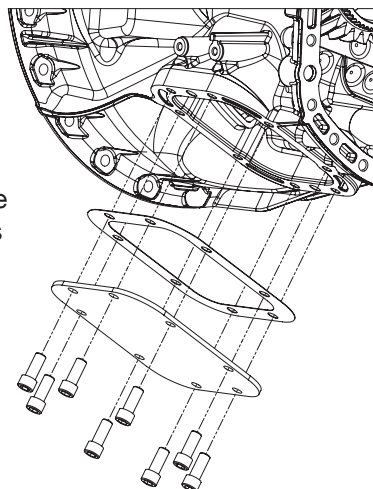

4. Locate alignment pins in installation kit.
Install the pins at the 6 and 12 o'clock positions in the adapter.

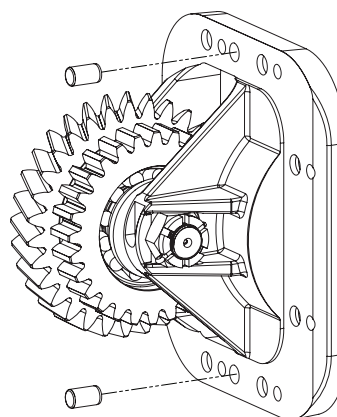

5. Install the adapter on the transmission using the thicker gasket (0.020") included with the installation kit.

Torque cap screws (M12x30)
to 50 ft.lbs.

Measure backlash between the adapter and transmission gear. Backlash should measure between 0.006"-0.012".

Adjust as necessary using the second gasket. Additional gaskets are available from Muncie Power, if necessary.

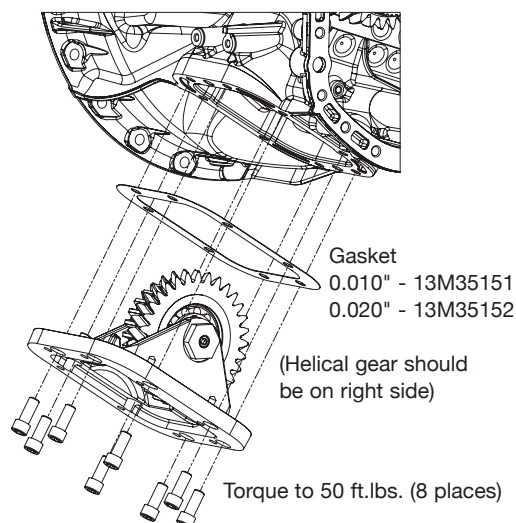

6. Install PTO (See IN84-03 for installation instructions).

Use edge molded gasket between the adapter and the PTO, or between the adapter and any spacer plates required for PTO installation. (Not required to measure backlash if no spacers are used between the PTO and the adapter.)

It is critical that the edge molded gasket be used against the adapter! Failure to do so may result in leaking!

TG Series, 82 Series 05 - 13 ratios

Setting backlash between PTO and adapter NOT required

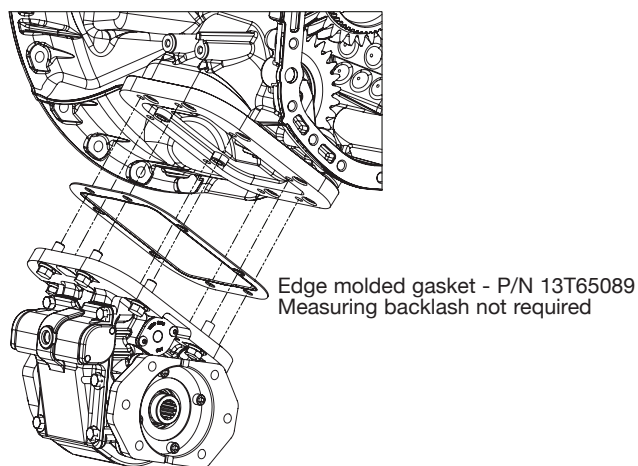

82 Series 15 and 19 ratios only

Backlash must be set between PTO and adapter!

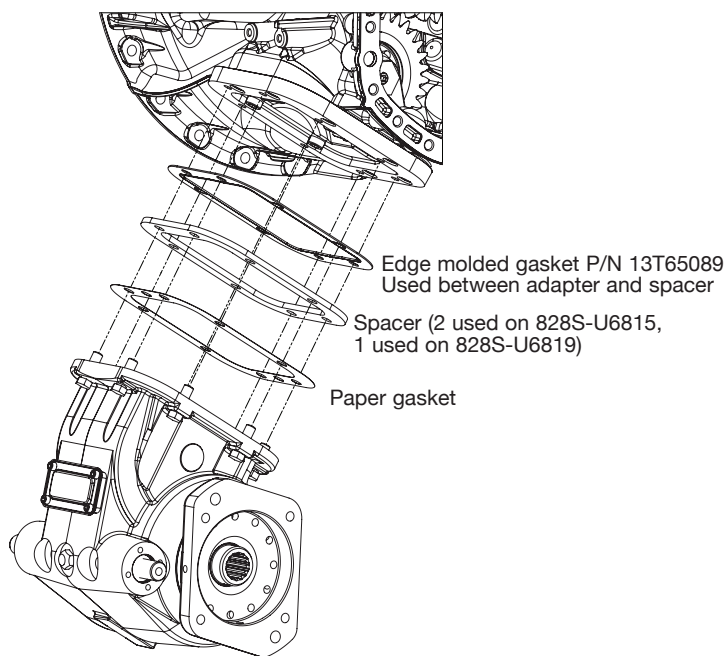

**Muncie®
Power
Products**

A Member of the Interpump Group

IN20-07 (Rev. 05-25)

201 East Jackson Street • Muncie, Indiana 47305
800-367-7867 • Fax 765-284-6991 • info@munciepower.com • www.munciepower.com
Specifications are subject to change without notice. Visit www.munciepower.com
for warranties and literature. All rights reserved. © Muncie Power Products, Inc. (2021)