



**Muncie®
Power
Products**

KEEP IN VEHICLE
READ OPERATING INSTRUCTIONS
INSIDE BEFORE OPERATING PTO

ACTIVATION INSTRUCTIONS

P58/P60 PTO ACTIVATION ON PACCAR TRANSMISSIONS

REQUIRES FOLLOWING PACCAR PTO PREP CODES:

4233510 PARK BRAKE INTERLOCK FOR TRANSMISSION MOUNTED PTO
4233900 (1) DASH MTD SINGLE ACTING EOA PTO CTRL ELECTRIC OVER AIR

REQUIRES ONE OF FOLLOWING:

4257110 LH MOUNTED TRANS PTO PROVISIONS
4257120 RH MOUNTED TRANS PTO PROVISIONS

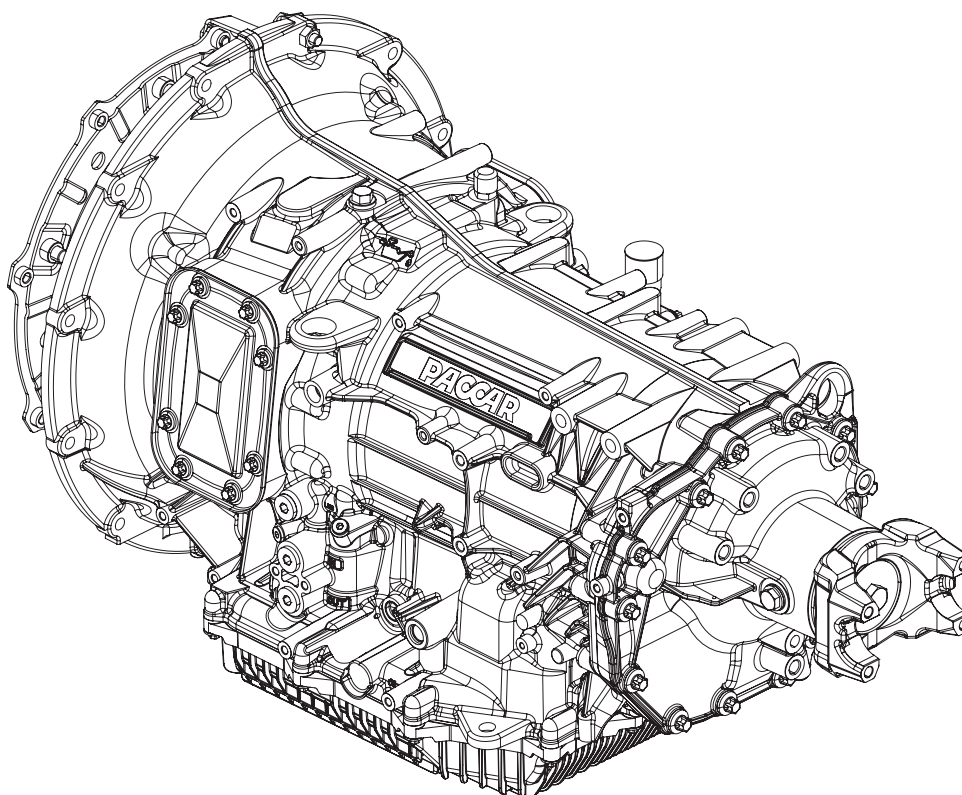

P58/P60 PTO DIAGRAM

PTO Indicator Switch connected to Chassis Wiring harness and PTO Activation Connection for OEM Solenoid for PTO Engagement

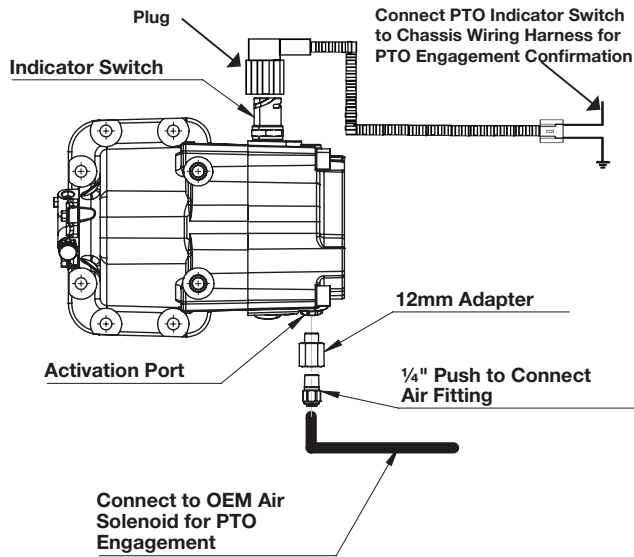

PTO LUBE PORT, INDICATOR SWITCH, AND ACTIVATION PORT

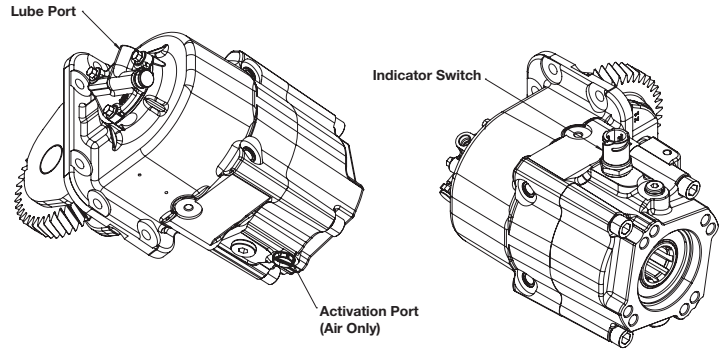

PACCAR PTO PREP CODES:

- 4233510 Park brake Interlock for transmission mounted PTO
- 4233900 (1) Dash MTD single-acting EOA PTO control electric over air

REQUIRES ONE OF FOLLOWING:

- 4257110 LH mounted transmission PTO provisions
- 4257120 RH mounted transmission PTO provisions

PUMP SUPPORT BRACKET MOUNTING LOCATIONS

Pump support brackets are required for all direct mount hydraulic pumps exceeding 20 lbs., including hoses, fittings, etc.

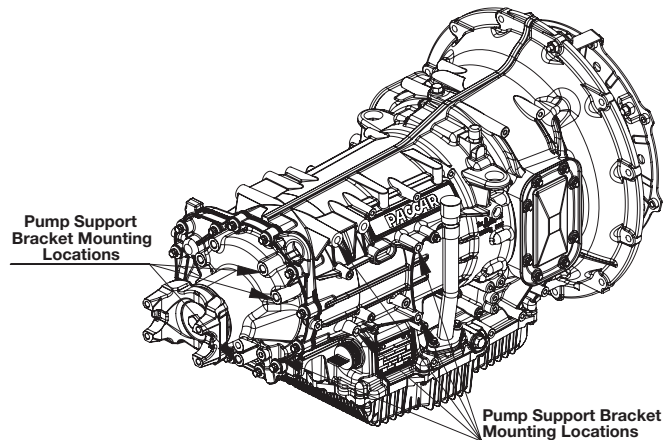
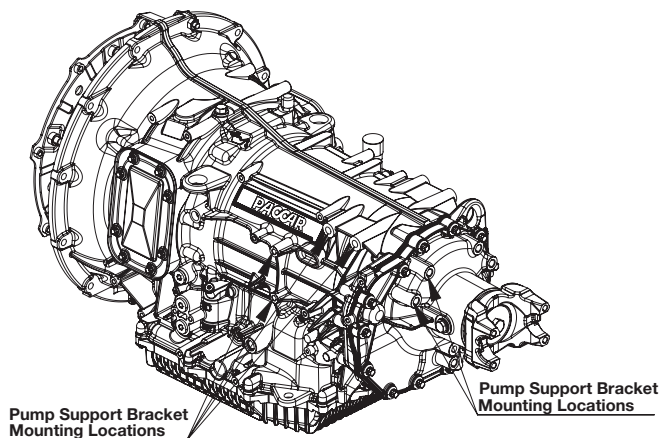

PTO Activation only permitted in stationary or crawl model.
Read PTO Operator's Manual IN17-04 prior to operating PTO!



A Member of the Interpump Group

IN25-07 (Rev. 05-25)

201 East Jackson Street, Muncie, Indiana 47305
800-367-7867 • Fax: 765-284-6991 • info@munciepower.com

Specifications are subject to change without notice. Visit www.munciepower.com for warranties and literature. All rights reserved. © Muncie Power Products, Inc. (2025)