



AIR SHIFT CONSOLE

INSTALLATION INSTRUCTIONS

AIR SHIFT CONSOLE

INSTALLATION INSTRUCTIONS

Tools Required:

- Screwdriver
- Adjustable Wrench
- Drill
- Knife
- Crimping Tool

ASSEMBLY

1. Install Street Tee Adapter (A19) in the supply port of Air Control Valve (A1).
 2. On Air Valve (A1) install the two Elbow Adapters (A18) and two Straight Tube Adapters (A11) in the two output ports opposite the supply port as shown in drawing.
 3. Install Straight Tube Adapter (A11) in supply port at the bottom of the PTO air valve (A2) and tighten.
 4. Install 90° Tube Adapter (A10) in the output port on the side of the PTO air valve and tighten so that the tube adapter points toward the floor of the cab.
 5. Install the two air valves (A1 and A2) in the Mounting Plate (A3) using the mounting screws (A6 and A7) and nuts (A9) provided.
 6. Cut a piece of air hose (A15) to fit between the Straight Tube Adapter (A11) on the PTO air valve and the 90° Tube Adapter (A10) on the Air Control Valve (A1). Cut the hose long enough for complete engagement on the fittings, but short enough to prevent any kink in the hose.
 7. Mount the indicator light (A12) from the PTO kit into the hole provided into mounting plate (A3).
 8. Attach the mounting plate (A3) to console housing (A4) with round head screws (A8) and hex nuts (A9).
 9. Position the console in the cab and find a location within reach of the driver, where holes can be drilled for the air lines as well as the 4 mounting holes for the console.
 10. Drill five 7/16" dia. holes in the floor of the cab within the area covered by the console. Insert grommets (A16) in the holes.
 11. Attach Nipple (A21) and Pressure Protection Valve (A20) to the air supply as you would for the air shift PTO. Note: Arrows on Pressure Protection Valve (A20) point away from the air supply.
 12. Install straight tube adapter (A22) to the remaining port on the Pressure Protection Valve (A20).
 13. Route the plastic tubing from the Pressure Protection Valve (A20) to the Straight Tube Adapter at the (supply) port of the air control valve (A1).
- Note: Route plastic tubing away from any sharp edges and exhaust pipes.
Make gentle bands to prevent hose from kinking.**
14. Thread tube adapter (A10) to the air cylinder of the PTO.
 15. Route another length of tubing (A15) from the PTO cylinder to the 90° tube adapter (A10) on the PTO air valve (A2).
 16. Attach the remaining two fittings (A10) to the air cylinders on the pump.
 17. Route a length of tubing (A15) from each of the fittings on the air cylinders to the fittings (A11) of the air control valve (A1).
 18. Using one of the butt splice connectors (A19), connect the #18 wire to one of the leads from indicator light (A12). Route this wire through grommet and to the PTO. Cut, strip and attach spade terminal (A18). Attach spade terminal to indicator switch terminal on PTO shift cover.

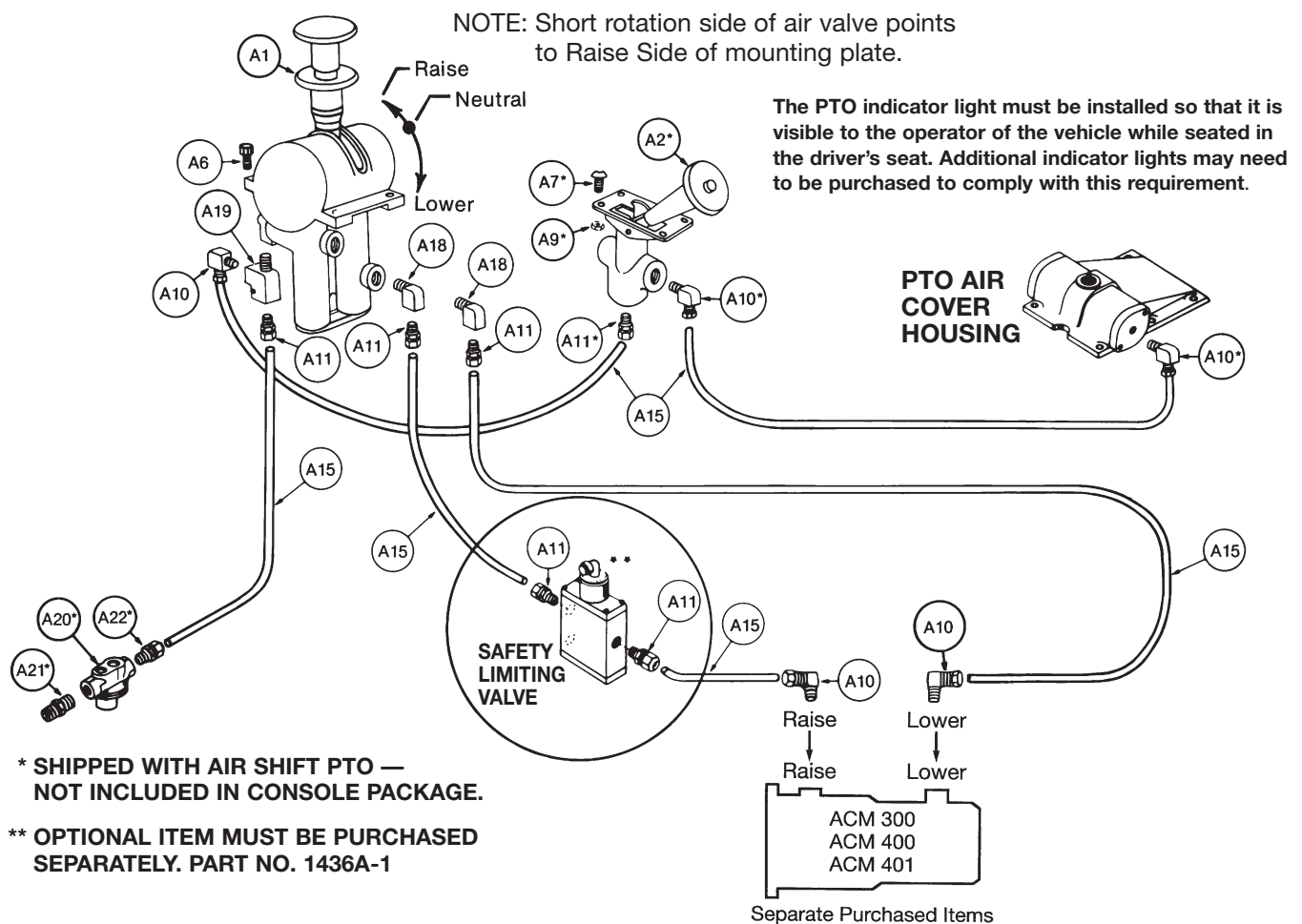

19. Use the other butt splice connector (A19) to connect the remaining lead from the indicator light (A12). Route this wire to an available "ACC" (accessory) tap on the fuse panel of the truck.

BE SURE THE HYDRAULIC SYSTEM IS PROPERLY PLUMBED. FILL HYDRAULIC SYSTEM AND TRANSMISSION WITH OIL BEFORE PROCEEDING.

20. With the air control valve (A1) in Hold Position and the PTO air valve (A2) out of gear, start the truck and let the air pressure build.
21. Disengage the clutch and engage the PTO air valve (A2). The light should come on at this time. Release the clutch and the pump is now turning.
22. Shift air control (A1) to the lower position and allow to run for a few minutes. This will allow for fluid movement and release of any entrained air in the system.
23. Shift air control valve (A1) to the raise position. If the body does not raise, shift air control valve (A1) out of gear and reverse the lines to cylinder ports (A11). Shift air control valve to raise dump body. Check for proper operation in the hold and lower position. Check for air leaks. (If unit does not function, review instructions to insure that everything is connected properly.)
24. Attach Side Plates (A5) and secure with sheet metal screws (A13).
25. Holding the console in position, drill the four holes in the floor of the cab and secure the console with suitable fasteners.

AIR SHIFT CONSOLE KIT

CONTAINS THE FOLLOWING PARTS:

| ITEM | QTY | PART NO. | DESCRIPTION |
|------|-----|----------|---------------------------------|
| A1 | 1 | 1461AM | Hoist Control Valve |
| A3 | 1 | A1153 | Mounting Plate |
| A4 | 1 | 1400C | Console Housing |
| A5 | 2 | 1401AC | Side Panel |
| A6 | 4 | 19M53238 | 10-32 x 3/8 Allen Head Screw |
| A8 | 4 | 1441A | 10-32 x 1/2 Machine Screw |
| A9 | 4 | 22MX1032 | 10-32 Locking Hex Nut |
| A10 | 3 | 44MB6942 | 1/8 N.P.T. 90° Tube Adapter |
| A11 | 3 | 44MB6842 | 1/8 N.P.T. Straight Tube Adapt. |
| A13 | 12 | 1405AC | #6 Sheet Metal Screws |
| A14 | 12' | 37M18000 | #18 A.W.G. Wire |
| A15 | 1 | 45M44430 | 1/4 Nylon Tubing - 30' |
| A16 | 5 | 1416AC | Rubber Grommet |
| A17 | 6 | 08470 | Plastic Ties |
| A18 | 2 | 44MB0222 | Street Elbow |
| A19 | 1 | 44MB2252 | Street Tee |

The PTO indicator light must be installed so that it is visible to the operator of the vehicle while seated in the driver's seat. Additional indicator lights may need to be purchased to comply with this requirement.

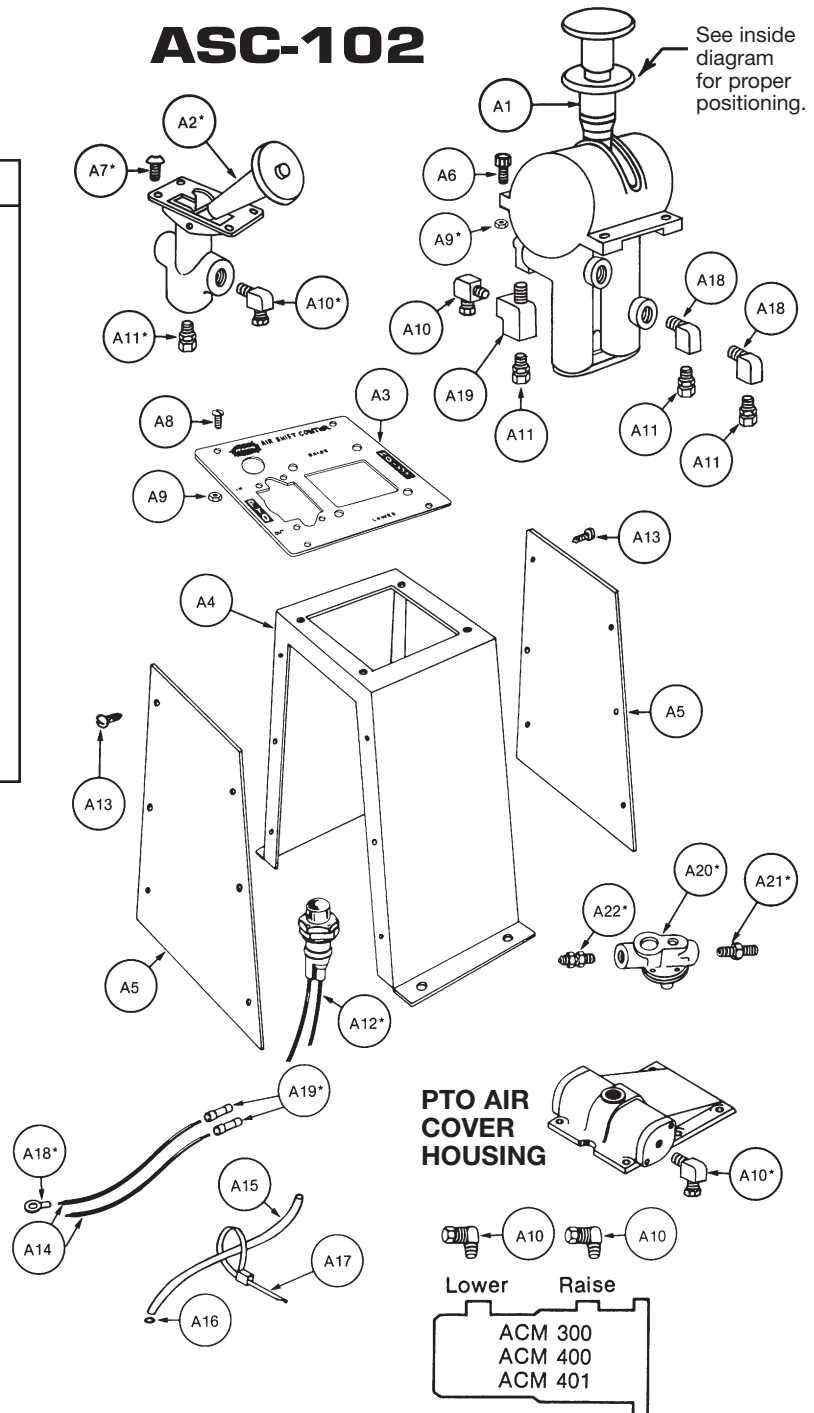

*** SHIPPED WITH AIR SHIFT PTO — NOT INCLUDED IN CONSOLE PACKAGE.**



IN82-01 (Rev. 9-05) Printed in the U.S.A.
© Muncie Power Products, Inc. 2005

Muncie Power Products, Inc. Member of the Interpump Hydraulics Group
General Offices and Distribution Center • P.O. Box 548 • Muncie, IN 47308-0548
(765) 284-7721 • FAX (765) 284-6991 • E-mail info@munciepower.com
Web site <http://www.munciepower.com>

Drive Products, Exclusive Agents for Canada, ISO Certified by an Accredited Registrar