

Product Bulletin #00104



MUNCIE POWER PRODUCTS
CORPORATE HEADQUARTERS

201 EAST JACKSON STREET
POST OFFICE BOX 548
MUNCIE, INDIANA 47308 USA

765-284-7721 PHONE
765-751-9506 FAX

Subject: Bent Axis Piston Pump for F20 Series PTO

Date: September 10, 2021

URL: www.munciepower.com

The new PT2-025-21IBRL UNI mount bent axis piston pump is now available and ready for purchase. This pump was selected for use with the F20 Series PTO on 2020 and later F-250–F-600 Ford 10R140 applications.

Pump Information

The PT2-025-21IBRL pump has a 1.56 in³ displacement. It can produce 6.75 theoretical GPM @ 1000 RPM, is rated to 6,525 PSI maximum continuous operating pressure and has a maximum operating RPM of 2300.

The PT2-025-21IBRL pump will come standard with a straight 1–1/4" hose barb suction fitting, (2) heavy duty hose clamps, and a SAE-8 O-Ring face seal pressure fitting.

The UNI mount uses a European standard for the mounting flange and input shaft which due to its small size, allows for proper fitment on the Ford transmission with the F20 Series PTO.

PTO Reference

The F20 Series PTO will require the new "UU" output to accept the new PT2-025 UNI mount pump. This combination will install on both 4x2 and 4x4 chassis.

Applications

The F20/PT2-025 combination will be ideal for high pressure applications like small cranes, hook-lifts, vacuum pump/blower drives, and product pump drives.

Literature

- MP07-05 – PT2 bent axis piston pump brochure
- IN01-04 – Fixed displacement piston pump installation tips and procedures
- MP19-02 – F20 brochure
- Ford-12 and Ford-13 – Quick reference application pages

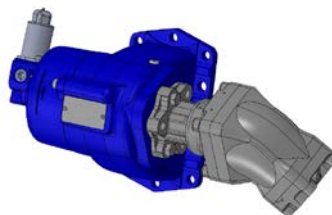

WE BUILD
TRUST.