



MUNCIE POWER PRODUCTS

Product Bulletin #00093

Subject: Support Bracket Change on XSMC Shaft Extensions

Date: August 28, 2020

URL: www.munciepower.com

A design change is being implemented on the support brackets on all XSMC shaft extensions. The “J” bracket design is being replaced by a clamping bracket, similar to the bracket used on XS24 and XD10 shaft extensions. This is an inline change, and as such will not result in a new model code for the shaft extensions.

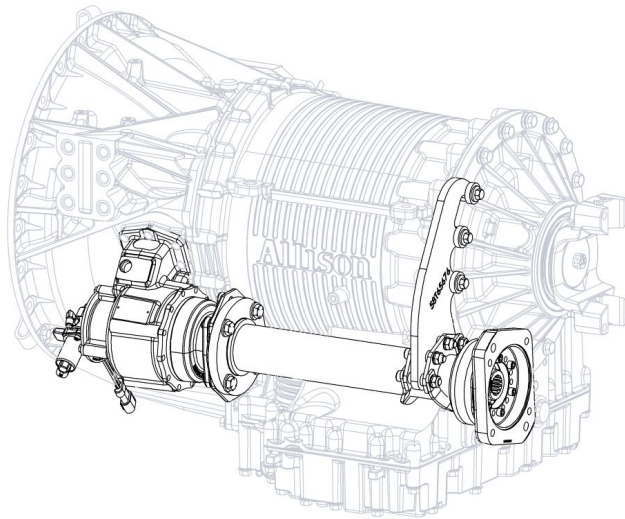

XSMC with new Clamping Style Bracket

The new bracket features two clamps that squeeze against the shaft extension housing, providing a very rigid installation. The installation of the new bracket is very similar to the old style bracket, with the exception of clamps on the bottom.

Most existing installations currently using the old “J” bracket can be converted to the new clamp style bracket, with the exception of XSMC-A40XX-X3**XX units. This is due to length of the housing on those units, which are too short to accommodate the clamping mechanism on the new bracket. Units of XSMC-A40XX-X3**XX

WE BUILD
TRUST.



MUNCIE POWER PRODUCTS

built on or after 9/7/2020 will feature a longer housing, and will be shipped with the clamping style bracket. The new housing will measure 17.9" from PTO mounting face to output flange mounting face. The old housing will measure 17.0" at the same place. All other housings will remain unchanged.

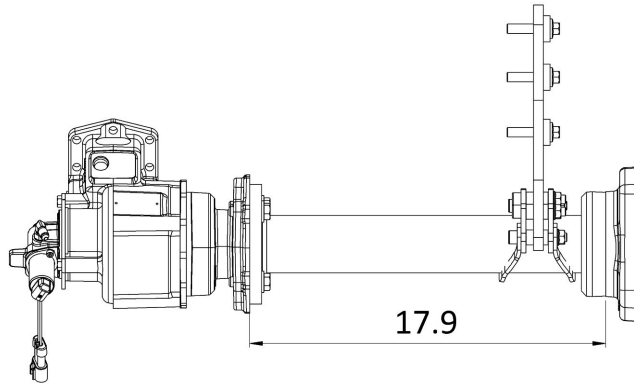

New XSMC-A40XX-X3**XX Housing Length

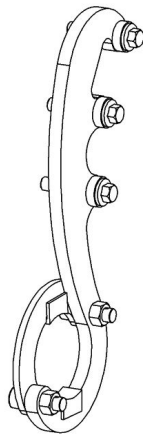

"J" Bracket (Old)

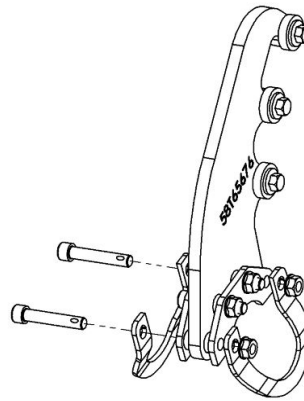

Clamp Style Bracket (New)

The installation instruction for the new bracket is IN20-10. It can be found at munciepower.com.

This change is being implemented on all XSMC shaft extensions, and will go into effect over the next month.

For more information, please contact Muncie Power Products

WE BUILD
TRUST.



MUNCIE POWER PRODUCTS

Customer Service at 800-367-7867

WE BUILD
TRUST.