

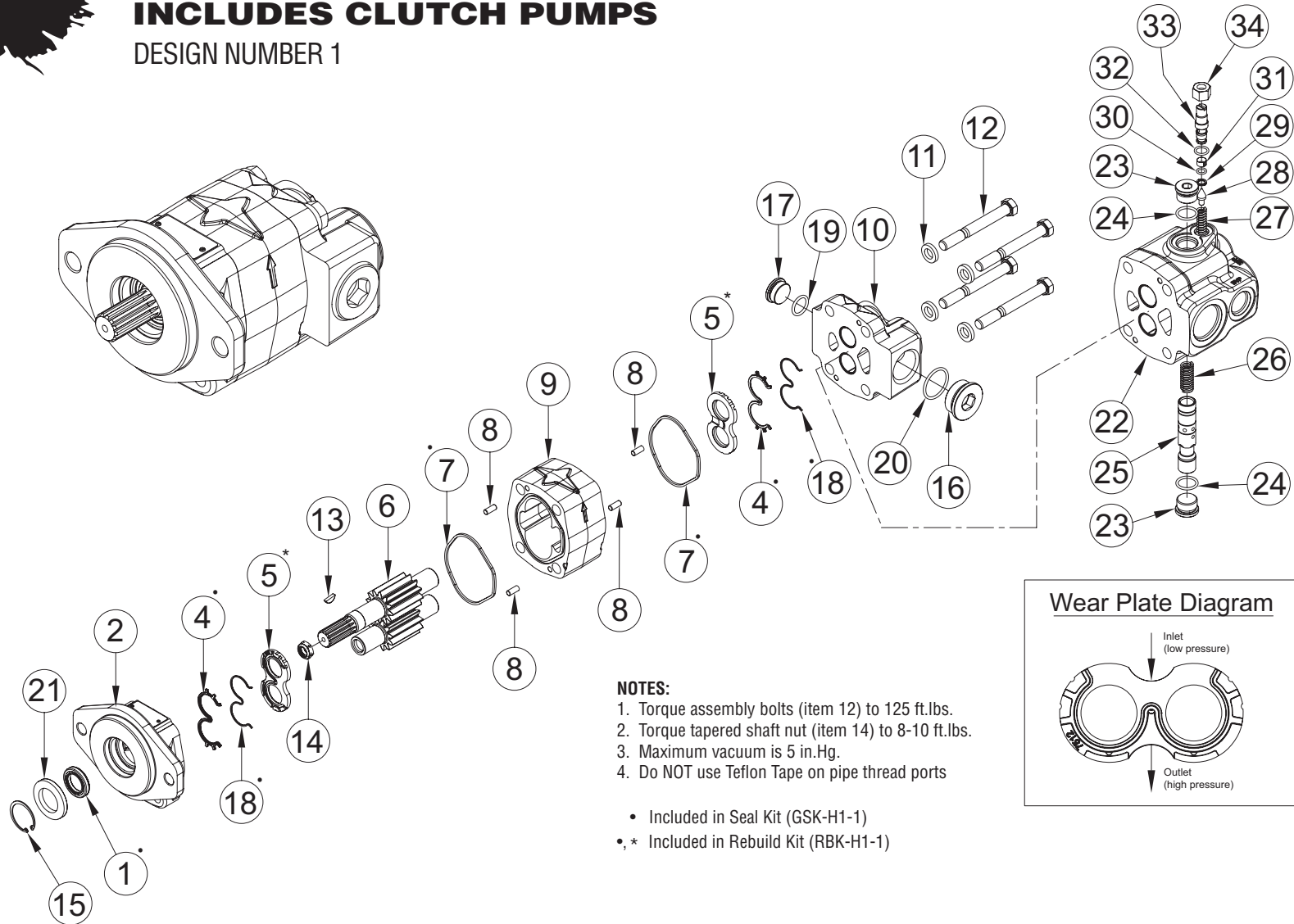

# H SERIES PUMP SERVICE PARTS

INCLUDES CLUTCH PUMPS

DESIGN NUMBER 1



**NOTES:**

1. Torque assembly bolts (item 12) to 125 ft.lbs.
2. Torque tapered shaft nut (item 14) to 8-10 ft.lbs.
3. Maximum vacuum is 5 in.Hg.
4. Do NOT use Teflon Tape on pipe thread ports

- Included in Seal Kit (GSK-H1-1)
- ,\* Included in Rebuild Kit (RBK-H1-1)

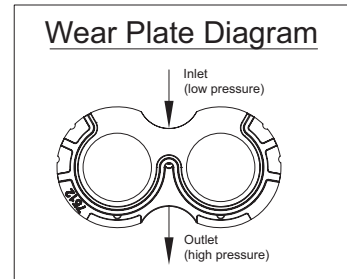

# H SERIES PUMP SERVICE PARTS

Item	Description	Qty.	Muncie Number
1	Shaft Seal .....	1	PH1-1005
2 <sup>A</sup>	Front Cover SAE A Flange.....	1	PH1-1107-ASXXX
	SAE A Flange, machined for snap ring .....	1	PH1-1107-ASXXX*
	SAE B Flange.....	1	PH1-1107-HSXXX
	SAE B Flange, machined for snap ring .....	1	PH1-1107-HSXXX*
	Remote Pad Mount (Clutch Pump) .....	1	PH1-1107-RSXXX
NS <sup>A</sup>	Bushings .....	4	PH1-1013
4	Balance Seal .....	2	PH1-1008-B
5	Wear Plate .....	2	PH1-1014
6	<b>Gear Set</b>		
	7/8-13T 3 GPM.....	1	PH1-1016S02-03-2
	7/8-13T 5 GPM.....	1	PH1-1016S02-05-2
	7/8-13T 7 GPM.....	1	PH1-1016S02-07-2
	7/8-13T 8 GPM.....	1	PH1-1016S02-08-2
	7/8-13T 9 GPM.....	1	PH1-1016S02-09-2
	7/8-13T 11 GPM.....	1	PH1-1016S02-11-2
	<b>Tapered Shaft Clutch Pump</b>		
	3 GPM .....	1	PH1-1016T04-03-2
	5 GPM .....	1	PH1-1016T04-05-2
	7 GPM .....	1	PH1-1016T04-07-2
	9 GPM .....	1	PH1-1016T04-09-2
	11 GPM .....	1	PH1-1016T04-11-2
7	Body Seal .....	2	PH1-1015
8	Dowel Pins .....	4	PH1-1024
9	<b>Body</b>		
	3 GPM .....	1	PH1-1125-03XX
	5 GPM .....	1	PH1-1125-05XX
	7 GPM .....	1	PH1-1125-07XX
	8 GPM .....	1	PH1-1125-08XX
	9 GPM .....	1	PH1-1125-09XX
	11 GPM .....	1	PH1-1125-11XX
10 <sup>A</sup>	Rear Cover NPT Both Side and Rear Ports .....	1	PH1-1126-PCP2
	Rear Cover SAE Both Side and Rear Ports .....	1	PH1-1126-SGR2
11	Lockwasher .....	4	PH1-1029
12 <sup>B</sup>	<b>Capscrew</b>		
	3 GPM (1/2-13 UNC x 2 3/4) .....	4	PH1-1028-03
	5 GPM (1/2-13 UNC x 3 1/4) .....	4	PH1-1028-05
	7 GPM (1/2-13 UNC x 3 1/2) .....	4	PH1-1028-07
	8 GPM (1/2-13 UNC x 3 3/4) .....	4	PH1-1028-08
	9 GPM (1/2-13 UNC x 4) .....	4	PH1-1028-09
	11 GPM (1/2-13 UNC x 4 1/4) .....	4	PH1-1028-11
	3 GPM (w/ PFC 1/2-13 UNC x 5 1/4) .....	4	PH1-1028-C0525
	5 GPM (w/ PFC 1/2-13 UNC x 5 3/4) .....	4	PH1-1028-C0575
	7 GPM (w/ PFC 1/2-13 UNC x 6.00).....	4	PH1-1028-C0600
	8 GPM (w/ PFC 1/2-13 UNC x 6 1/4) .....	4	PH1-1028-C0625
	9 GPM (w/ PFC 1/2-13 UNC x 6 1/2) .....	4	PH1-1028-C0650
	11 GPM (w/ PFC 1/2-13 UNC x 6 3/4) .....	4	PH1-1028-C0675
13	#6 Woodruf Key (Tapered shaft only) .....	1	PH1-1017-W
14 <sup>C</sup>	Nut (1/2-20 Nylock) (Tapered Shaft Only).....	1	PH1-1020
15	Snap Ring (Tapered Shaft Only & PFC units only).....	1	PH1-1004
16	Inlet Port Plug		
	-20 NPTF .....	1	HHPP-20Z
	-20 SAE w/ O-Ring .....	1	HHBP-20Z

Item	Description	Qty.	Muncie Number
17	Outlet Port Plug		
	-12 NPTF .....	1	HHPP-12Z
	-12 SAE w/ O-Ring .....	1	HHBP-12Z
18	Back-Up Seal .....	2	PH1-1009
19	O-Ring 0.92 X 0.12 (for HHBP-12Z) .....	1	BOR-12
20	O-Ring 1.50 X 0.12 (for HHBP-20Z) .....	1	BOR-20
21 <sup>D</sup>	Seal Retainer .....	1	PH1-1001-D
22 <sup>A</sup>	Rear Cover for integral priority flow control .....	1	PH1-1126-SFGPFC1
23	Spool Cavity Plug, -10 SAE w/ O-Ring.....	2	HHBP-10Z
24	O-Ring 0.76 X 0.10 (for HHBP-10Z) .....	2	BOR-10
25	<b>Priority flow spool code</b>		
	"A", 2.0 GPM (7.5 LPM) .....	1	PH1-1040-PFC020
	"B", 3.0 GPM (11.4 LPM) .....	1	PH1-1040-PFC030
	"C", 3.5 GPM (13.2 LPM) .....	1	PH1-1040-PFC035
	"D", 4.0 GPM (15.1 LPM) .....	1	PH1-1040-PFC040
	"E", 4.5 GPM (17.0 LPM) .....	1	PH1-1040-PFC045
	"F", 5.0 GPM (18.9 LPM) .....	1	PH1-1040-PFC050
	"G", 5.5 GPM (20.8 LPM) .....	1	PH1-1040-PFC055
	"H", 6.0 GPM (22.7 LPM) .....	1	PH1-1040-PFC060
	"I", 6.5 GPM (24.6 LPM) .....	1	PH1-1040-PFC065
	"J", 7.0 GPM (26.5 LPM) .....	1	PH1-1040-PFC070
	"K", 7.5 GPM (28.4 LPM) .....	1	PH1-1040-PFC075
	"L", 8.0 GPM (30.3 LPM) .....	1	PH1-1040-PFC080
	"M", 8.5 GPM (32.2 LPM) .....	1	PH1-1040-PFC085
	"N", 9.0 GPM (34.1 LPM) .....	1	PH1-1040-PFC090
	"O", 9.5 GPM (36.0 LPM) .....	1	PH1-1040-PFC095
	"P", 10.0 GPM (37.9 LPM) .....	1	PH1-1040-PFC100
	"Q", 11.0 GPM (41.6 LPM).....	1	PH1-1040-PFC110
	"R", 12.0 GPM (45.4 LPM).....	1	PH1-1040-PFC120
26	Priority Flow Spool Spring.....	1	PH1-1034A
27	Relief Valve Spring .....	1	PH1-1231-16V
28	Relief Valve Poppet.....	1	PH1-1231-4V
29	Relief Valve Back-Up Seal .....	1	PH1-1231-14V
30	O-Ring 0.302 X 0.07 (for RV) .....	1	PH1-1231-13V
31	Relief Valve Filter Screen .....	1	PH1-1231-10V
32	O-Ring 0.472 X 0.08 (for RV) .....	1	BOR-6
33	Relief Valve Adjustment Cartridge .....	1	PH1-1231-15VX
34	Relief Valve Lock Nut.....	1	PH1-1231-5V
<b>CLUTCH PUMP REPLACEMENT CLUTCHES</b>			
N.S.	6" Fanbelt Clutch (32 HP, 2-Groove "V" Belt).....	1	FBC32-6A
N.S.	6" Fanbelt Clutch (32 HP, 6-Groove Poly Belt) .....	1	FBC32-6PA
N.S.	6" Fanbelt Clutch (32 HP, 8-Groove Poly Belt) .....	1	FBC32-6P8A
N.S.	Flange Yoke Clutch (70 HP) .....	1	FCY-70A
N.S.	Coil (32 HP) .....	1	RC32-6A
N.S.	Coil (70 HP) .....	1	RC-70
<b>"H" SERIES KITS</b>			
N.S.	Seal Kit GSK-H1-1 (Includes items 1, 4, 7 and 18)		
N.S.	Rebuild Kit RBK-H1-1 (Includes items 1, 4, 5, 7 and 18)		

**NOTES:**

- A. Covers are shipped with bushings (PH1-1013) installed
- B. Torque assembly capscrews to 125 ft.lbs.
- C. Torque to 8-10 ft.lbs.
- D. Seal retainer used on SAE "A" flange with snap ring (PFC units only)
- \* Front covers machined for snap ring are used with PFC units only