

S SERIES DUMP PUMP SERVICE PARTS

MAIN RV SHIM PRESSURE CHART ***			
Thickness	.005	.015	.062
Pressure	30 PSI	150 PSI	625 PSI

Adjustable from 1,000 to 2,500 PSI
Factory set at 2,000 PSI ± 100 PSI

*** **Note:** Units built Nov 2002 and later have screw adjustable main relief valves and do not use shims.

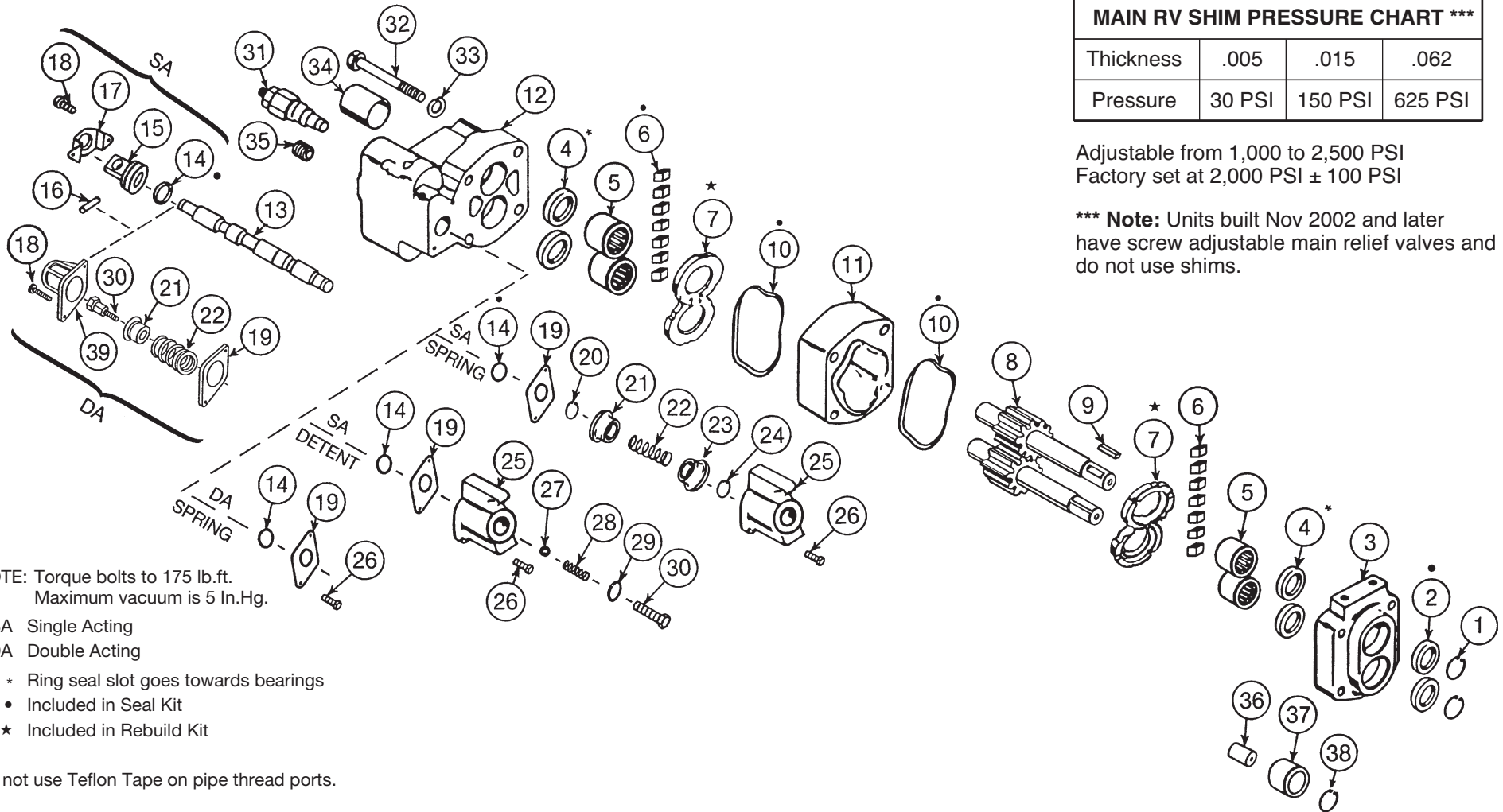

NOTE: Torque bolts to 175 lb.ft.
Maximum vacuum is 5 In.Hg.

SA Single Acting
DA Double Acting

- * Ring seal slot goes towards bearings
- Included in Seal Kit
- ★ Included in Rebuild Kit

Do not use Teflon Tape on pipe thread ports.



SP88-01 (Rev. 12-05) Printed in the U.S.A.
© Muncie Power Products, Inc. 2005

Muncie Power Products, Inc. Member of the Interpump Hydraulics Group
General Offices and Distribution Center • P.O. Box 548 • Muncie, IN 47308-0548
(765) 284-7721 • FAX (765) 284-6991 • E-mail info@munciepower.com
Web site <http://www.munciepower.com>
Drive Products, Inc., Toronto, Exclusive Agents for Canada

S SERIES DUMP PUMP SERVICE PARTS

Item	Description	Qty	Muncie Number
1	Snap Ring		
	Direct	1	PS-1004D
	Remote	2	PS-1004R
2	Shaft Seal	1 or 2	PS-1005
3	Front Cover	1	
	Direct		PS-1007-D
	Remote		PS-1007-R
4	Ring Seal	4	PS-1008
5	Roller Bearings	4	PS-1013
6	Pocket Seal (3 inch strip)	1	PS-1009
7	Wear Plates	2	PS-1014
8	Driveshaft*	2*	
	Direct Mount		
	6 GPM		PS-1016S-6-2
	11 GPM		PS-1016S-11-2
	15 GPM		PS-1016S-15-2
	Remote Mount		
	6 GPM		PS-1016K-6-2
	11 GPM		PS-1016K-11-2
	15 GPM		PS-1016K-15-2
9	Key (Remote)	1	PS-1017
10	Housing Seal	2	PS-1015
11	Pump Housing	1	
	6 GPM		PS-1025-6
	11 GPM		PS-1025-11
	15 GPM		PS-1025-15
12,13	Rear Cover/Valve Spool Ass'y**	1	
	Direct Mount		
	SA Detented		PS-1026-DDK
	SA Spring		PS-1026-DSK
	DA Spring		PS-1026-DSKD
	Remote Mount		
	SA Detented		PS-1026-RDK
	SA Spring		PS-1026-RSK
	DA Spring		PS-1026-RSKD
14	Spool O-Ring	2	PS-1214V
15	End Cap SA	1	PS-1215V
16	Stop Pin SA	1	PS-1216V
17	Stop Bracket SA	1	PS-1217V
18	Bracket Bolts SA	2	PS-1218V
	Capscrew (Cap End) DA	2	PS-1236V
19	Cover Plate SA	1	PS-1219V
	Cover Plate DA	1	PS-1234V
20	Snap Ring SA	1	PS-1420V
21	Spring Retainer (Long)	1	PS-1421V
	Spring Guide DA	2	PS-1239V
22	Spring SA	1	PS-1422V
	Return Spring DA	1	PS-1238V

Item	Description	Qty	Muncie Number
23	Spring Retainer (Short) SA	1	PS-1423V
24	Snap Ring SA	1	PS-1424V
25	End Cap (Detent) SA	1	PS-1425V
	End Cap (Spring) SA	1	PS-1425VS
26	End Cap Bolts SA	2	PS-1426V
	Capscrew (Eye End) DA	2	PS-1240V
27	Detent Ball SA	1	PS-1227V
28	Detent Spring SA	1	PS-1228V
29	Lock Washer SA	1	PS-1229V
30	Detent Retainer SA	1	PS-1230V
	Stripper Bolt DA	1	PS-1237V
31	Relief Valve Assembly (Screw Adj.)***	1	PS-1231V
	Adj. Shim	As needed on old shim Adj.	
	.005		PS-1231-13V
	.015		PS-1231-14V
	.062		PS-1231-15V
	Spring (1000-2500 psi)	1	PS-1232-16V
	Spring (2500-3500 psi)	1	PS-1232-16VH
32	Assembly Bolts	4	
	6 GPM		PS-1028-6
	11 GPM		PS-1028-11
	15 GPM		PS-1028-15
33	Lock Washer	4	PS-1029
34	Conversion Sleeve	(Optional)	AA-1257
35	Pipe Plug	1	HHPP-12
	(Remove when sleeve is used)		
	5/8 O.D.T. Plug	1	HHBP-10
36	Check Assembly	1	PS-1010
37	Spacer (Direct Only)	1	PS-1002-D
38	Seal Retainer (Direct Only)	1	PS-1001-D
NS	Pull Out Cable Spring	1	PS-1233V
39	Back Cap DA	1	PS-1235V
NS	Down Side Relief	1	MESP-249A
*	Gears are sold only in sets. Cannot be serviced individually.		
**	Rear cover and valve spool are a matched set and cannot be serviced individually.		
***	See front for details.		

Kits	Direct	Remote	Both
Seal & O-Ring Kit	GSK-S2-1	GSK-S2-2	—
<i>Includes Items 2, 6, 10, and 14</i>			
Rebuild Kit	RBK-S2-1	RBK-S2-2	—
<i>Includes Items 2, 6, 7, 10, and 14</i>			
Bearing Kit	—	—	PS-1013K
Relief Valve Seal Kit (Shim Adj.)	—	—	GSK-S2RV
Relief Valve Seal Kit (Screw Adj.)	—	—	GSK-S2RVA
SA Spring Kit (N.S.)	—	—	SCK-S2
SA Air Shift Cyl. Kit (N.S.)	—	—	ACM-400
DA Air Shift Cyl. Kit (N.S.)	—	—	ACM-401