



# H SERIES PUMP SERVICE PARTS

(Includes Clutch Pumps)

NOTE: Torque assembly bolts to 125 lb.ft.  
Maximum vacuum is 5 In.Hg.  
Do not use Teflon Tape on pipe thread ports.

- Included in Seal Kit
- ★ Included in Rebuild Kit

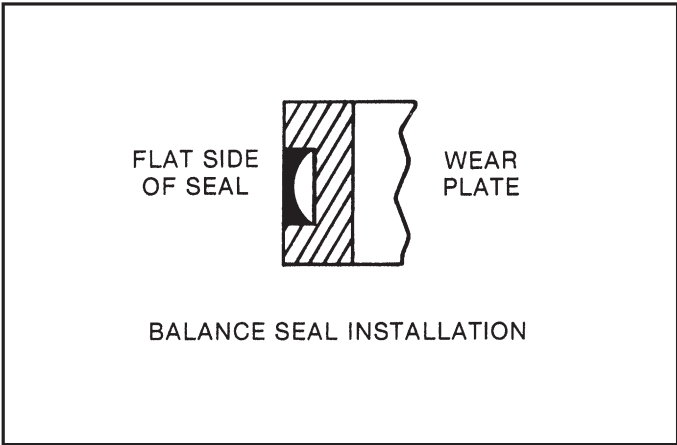
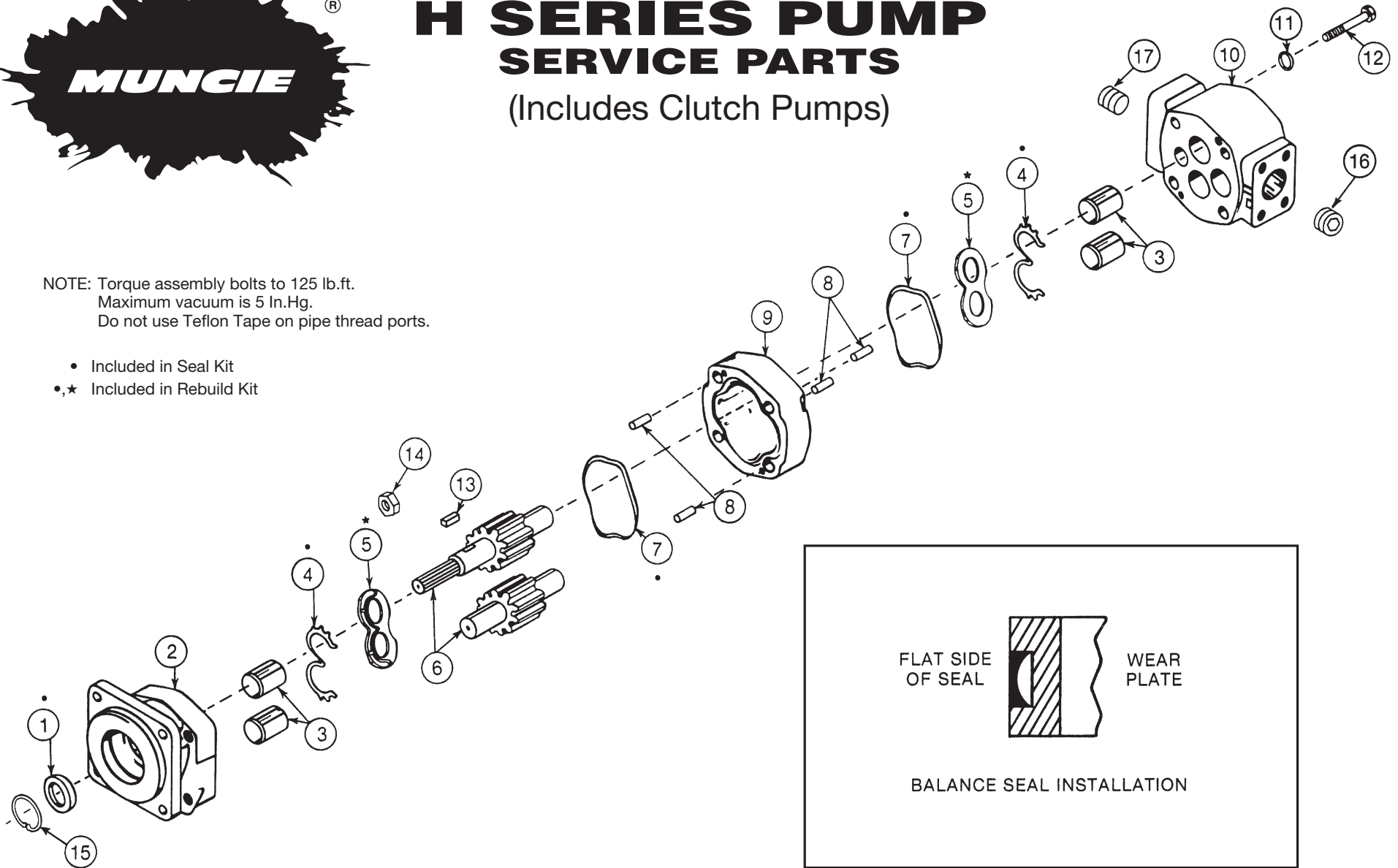

# H SERIES PUMP SERVICE PARTS

Item	Description	Qty	Muncie Number
1	Shaft Seal (Std.) . . . . .		PH-1005
	Shaft Seal (High Pressure) . . . . .		PH-1005M
2	Front Cover ** . . . . .	1	
	A Pilot . . . . .		PH-1007-A
	B Pilot . . . . .		PH-1007-D
	Pad Mount (Clutch Pump) . . . . .		PH-1007-C
3	Bushings. . . . .	4	PH-1013
4	Balance Seal . . . . .	2	PH-1008-B
NS	Back-Up Seal . . . . .	2	PH-1009
5	Wear Plate . . . . .	2	PH-1014
6	Gear Set * . . . . .	1	
	3 GPM Splined (13T) . . . . .		PH-1016S-3-2
	5 GPM Splined (13T) . . . . .		PH-1016S-5-2
	7 GPM Splined (13T) . . . . .		PH-1016S-7-2
	8 GPM Splined (13T) . . . . .		PH-1016S-8-2
	9 GPM Splined (13T) . . . . .		PH-1016S-9-2
	11 GPM Splined (13T) . . . . .		PH-1016S-11-2
	3 GPM Keyed (7/8 Rd.) . . . . .		PH-1016K-3-2
	5 GPM Keyed (7/8 Rd.) . . . . .		PH-1016K-5-2
	7 GPM Keyed (7/8 Rd.) . . . . .		PH-1016K-7-2
	8 GPM Keyed (7/8 Rd.) . . . . .		PH-1016K-8-2
	9 GPM Keyed (7/8 Rd.) . . . . .		PH-1016K-9-2
	11 GPM Keyed (7/8 Rd.) . . . . .		PH-1016K-11-2
	3 GPM Tapered . . . . .		PH-1016T-3-2
	5 GPM Tapered . . . . .		PH-1016T-5-2
	7 GPM Tapered . . . . .		PH-1016T-7-2
	9 GPM Tapered . . . . .		PH-1016T-9-2
	11 GPM Tapered . . . . .		PH-1016T-11-2
7	Body Seal . . . . .	2	PH-1015
8	Dowel Pins . . . . .	4	PH-1024

\* Gears are sold as sets only.  
 \*\* Covers are automatically shipped with bushings (PH-1013) installed.  
 \*\*\* Torque to 8-10 ft. lbs

Item	Description	Qty	Muncie Number
9	Pump Housing . . . . .	1	
	3 GPM . . . . .		PH-1025-3
	5 GPM . . . . .		PH-1025-5
	7 GPM . . . . .		PH-1025-7
	8 GPM . . . . .		PH-1025-8
	9 GPM . . . . .		PH-1025-9
	11 GPM . . . . .		PH-1025-11
10	Rear Cover ** . . . . .	1	
	(Rear Ports Pipe) . . . . .		PH-1026-R
	(Side Ports SAE) . . . . .		PH-1026-SS
	(One Side - One Rear) . . . . .		PH-1026-C
	(Both Side & Rear Ports Pipe) . . . . .		PH-1026-CP
	(Both Side & Rear Ports SAE) . . . . .		PH-1026-CS
11	Lockwasher . . . . .	4	PH-1029
12	Cap Screws . . . . .	4	
	3 GPM . . . . .		PH-1028-3
	5 GPM . . . . .		PH-1028-5
	7 GPM . . . . .		PH-1028-7
	8 GPM . . . . .		PH-1028-8
	9 GPM . . . . .		PH-1028-9
	11 GPM . . . . .		PH-1028-11
13	Key (Round) . . . . .	1	PH-1017
	#6 Woodruff Key (Tapered) . . . . .	1	PH-1017-W
14***	Nut (Tapered Only) 1/2-20 Nylock . . . . .	1	PH-1020
15	Snap Ring (Tapered Only) . . . . .	1	PH-1004
16	Port Plug . . . . .	1	
	-12(ODT) . . . . .		HHBP-12
	3/4inch (NPT) . . . . .		HHPP-12
17	Port Plug . . . . .	1	
	-20(ODT) . . . . .		HHBP-20
	1-1/4inch (NPT) . . . . .		HHPP-20

**Seal Kit** (Includes Items 1, 4, and 7)  
**GSK-H1**  
**Rebuild** (Includes Items 1, 4, 5, and 7)  
**RBK-H1**  
**Bearing Kit** (Bushings)  
**PH-1013K**