

# E/EH SERIES DUMP PUMP SERVICE PARTS

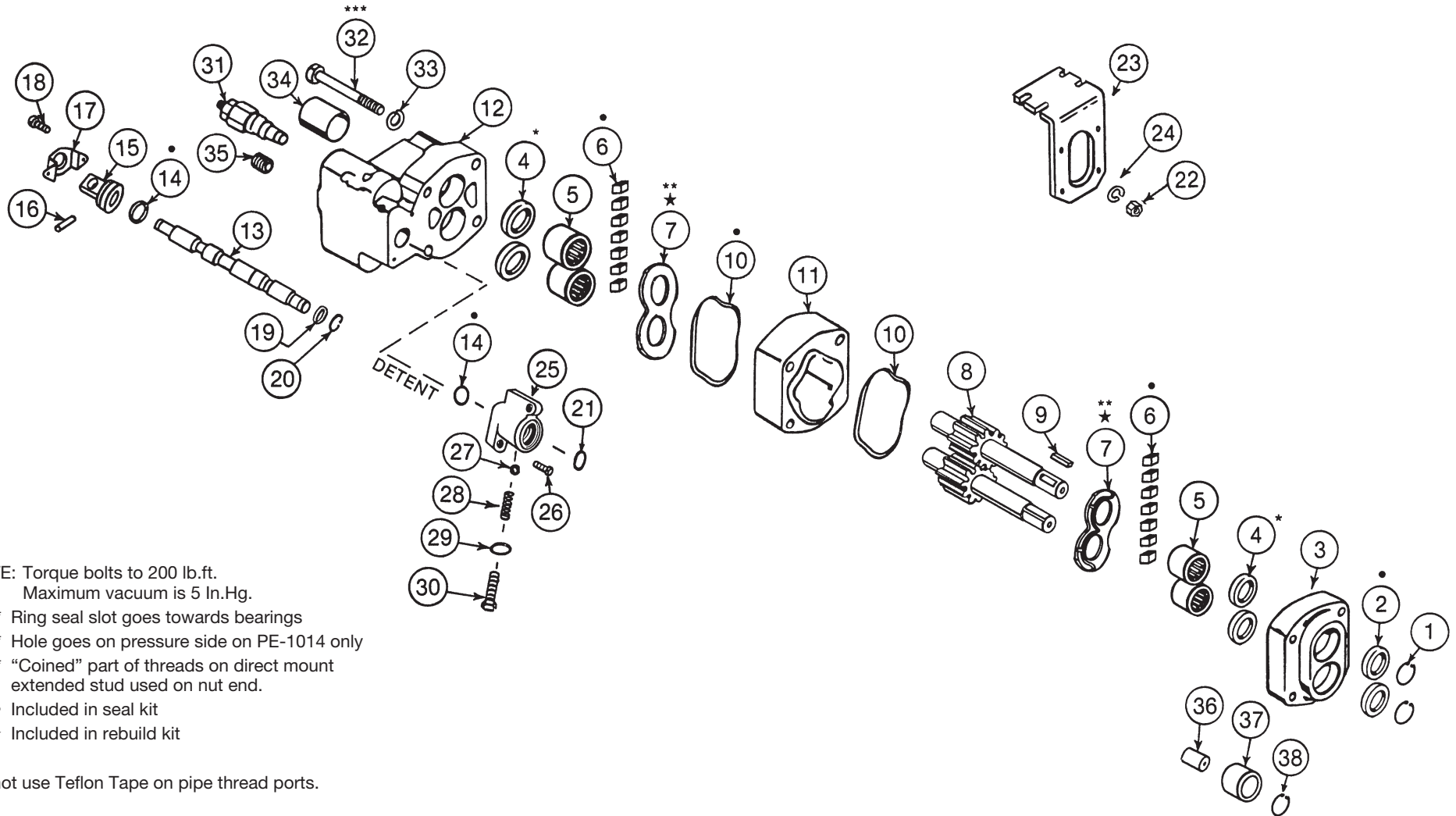

NOTE: Torque bolts to 200 lb.ft.  
Maximum vacuum is 5 In.Hg.

- \* Ring seal slot goes towards bearings
- \*\* Hole goes on pressure side on PE-1014 only
- \*\*\* "Coined" part of threads on direct mount extended stud used on nut end.
  - Included in seal kit
  - ★ Included in rebuild kit

Do not use Teflon Tape on pipe thread ports.



SP89-03 (Rev. 1-06) Printed in the U.S.A.  
© Muncie Power Products, Inc. 2006

**Muncie Power Products, Inc.** Member of the Interpump Hydraulics Group  
General Offices and Distribution Center • P.O. Box 548 • Muncie, IN 47308-0548  
(765) 284-7721 • FAX (765) 284-6991 • E-mail info@munciepower.com  
Web site <http://www.munciepower.com>  
Drive Products, Inc., Toronto, Exclusive Agents for Canada, ISO Certified by an Accredited Registrar

# E/EH SERIES DUMP PUMP SERVICE PARTS

Item	Description	Qty	Muncie Number
1	Snap Rings (Remote) . . . . .	2	PE-1004
2	Shaft Seal (Remote) . . . . .	2	PE-1005
	(Direct) . . . . .	1	PL-1005
3	Front Cover . . . . .	1	
	Remote . . . . .		PE-1007R
	Direct . . . . .		PE-1007D
4	Ring Seal . . . . .	4	PL-1008
5	Bearings . . . . .	4	PL-1013
6	Pocket Seals (12 pcs., 3 inch strip) . . . . .	1	PS-1009
7	Wear Plates (E/EH 23, 27 Remote) . . . . .	2	PE-1014*
	(E/EH 23, 27 Direct) . . . . .	2	PL-1014
	(EH 22, 28, 36) . . . . .	2	PEH-1014
8	Direct Mount Gear Set . . . . .	1	
	7/8 13T-23 GPM (E/EH Series) . . . . .		PE-1016S-23-2
	7/8 13T-27 GPM (E/EH Series) . . . . .		PE-1016S-27-2
	7/8 13T-22 GPM (EH Series) . . . . .		PEH-1016S-22-2
	7/8 13T-28 GPM (EH Series) . . . . .		PEH-1016S-28-2
	7/8 13T-36 GPM (EH Series) . . . . .		PEH-1016S-36-2
	1" 15T-27 GPM (E Series) . . . . .		PE-1016S17-27-2
	Remote Mount Gear Set . . . . .	1	
	1 in. Rnd.-23 GPM (E/EH Series) . . . . .		PE-1016K-23-2
	1 in. Rnd.-27 GPM (E/EH Series) . . . . .		PE-1016K-27-2
	1 in. Rnd.-22 GPM (EH Series) . . . . .		PEH-1016K-22-2
	1 in. Rnd.-28 GPM (EH Series) . . . . .		PEH-1016K-28-2
	1 in. Rnd.-36 GPM (EH Series) . . . . .		PEH-1016K-36-2
9	Key (Remote) . . . . .	2	PS-1017
10	Body Seal (E/EH 23,27; EH 22,28,36 Front 1 pc) . . . . .	2	PL-1012
	(EH 22,28,36 Rear) . . . . .	1	PEH-1012
11	Body . . . . .	1	
	23 GPM (E/EH Series) . . . . .		PE-1025-23
	27 GPM (E/EH Series) . . . . .		PE-1025-27
	22 GPM (EH Series) . . . . .		PEH-1025-22
	28 GPM (EH Series) . . . . .		PEH-1025-28
	36 GPM (EH Series) . . . . .		PEH-1025-36
12,13**	Rear Cover/Valve Ass'y (E 23,27 Remote) . . . . .	1	PE-1026-RK
	(E 23,27 Direct) . . . . .	1	PE-1026-DK
	Rear Cover/Valve Ass'y (EH 23,27 Remote) . . . . .	1	PEH-1126-RK
	(EH 23,27 Direct) . . . . .	1	PEH-1126-DK
	Rear Cover/Valve Ass'y (EH 22,28,36 Remote) . . . . .	1	PEH-1026-RK
	(EH 22,28,36 Direct) . . . . .	1	PEH-1026-DK
14	Spool O-Ring . . . . .	2	PE-1214V
15	End Stop Cap . . . . .	1	PE-1206V
16	Stop Pin . . . . .	1	PS-1216V
17	Stop Bracket . . . . .	1	PE-1207V
18	Bracket Bolts . . . . .	2	PS-1218V
19	Retainer Ring . . . . .	1	PE-1201V
20	Snap Rings . . . . .	1	PE-1202V
21	Retainer Wiper Seal-Ring . . . . .	1	PE-1204V
22	Nut . . . . .	4 or 6	PE-1020
23	Mounting Bracket . . . . .	1	B1235
24	Washer . . . . .	8	PL-1029
25	End Cap . . . . .	1	PE-1203V
26	End Cap Bolts . . . . .	4	PE-1205V
27	Detent Ball . . . . .	1	PS-1227V
28	Detent Spring . . . . .	1	PS-1228V

Item	Description	Qty	Muncie Number
29	Detent Lockwasher . . . . .	1	PS-1229V
NS	Pullout Cable (Opt) . . . . .	1	PS-1233V
30	Detent Retainer . . . . .	1	PS-1230V
31	Relief Valve Ass'y. (E/EH 23, 27) . . . . .	1	PE-1231V
	(EH 22, 28, 36) . . . . .	1	PEH-1231V
32	Assembly Bolts (Remote Mnt.) / Stud (Direct Mnt.) <sup>4</sup>		
	22 GPM Bolt . . . . .		PL-1028-112
	23 & 28 GPM Bolt . . . . .		PE-1028-23
	27 & 36 GPM Bolt . . . . .		PE-1028-27
	22 GPM Stud . . . . .		PL-1028-598S
	23 GPM Stud . . . . .		PE-1028-23S
	28 GPM Stud . . . . .		PL-1028-597S
	27 & 36 GPM Stud . . . . .		PE-1028-27S
33	Washer . . . . .	4	PE-1230
34	Conversion Sleeve (E Series) . . . . .	1	AA-1257
	(EH Series) . . . . .	1	AA-1257-2
35	Pipe Plug (1 inch) . . . . .	1	HHPP-16
36	Check Assembly (Direct) . . . . .	2	PS-1010
37	Spacer (Direct) . . . . .	1	PE-1002-D
38	Snap Rings (Direct) . . . . .	1	PL-1001

Kits	Direct	Remote	Both
Seal & O-Ring Kit (E/EH 23, 27) . . . . .	GSK-E2-1 . . . . .	GSK-E2-2 . . . . .	—
(EH 22, 28, 36) . . . . .	GSK-EH2-1 . . . . .	GSK-EH2-2 . . . . .	—
Rebuild Kit (E/EH 23, 27) . . . . .	RBK-E2-1 . . . . .	RBK-E2-2 . . . . .	—
(EH 22, 28, 36) . . . . .	RBK-EH2-1 . . . . .	RBK-EH2-2 . . . . .	—
Bearing Kit . . . . .	—	—	PL-1013K
Relief Valve Seal Kit (E/EH 23, 27) . . . . .	—	—	GSK-E2-RV
(EH 22, 28, 36) . . . . .	—	—	GSK-EH2-RV

\* Hole in wear plate goes on pressure side.

\*\* Rear cover and valve spool are a matched set and cannot be serviced individually. Assembly is easily identified by the holes that are drilled in both bearing bores of the remote cover.

(Includes items 4-5, 12-21, 25-31)

## AIR CYLINDER KIT: ACM302 (Fits both E/EH Series) Ports are 1/8" - 27 NPT

Item	Description	Qty	Muncie Number
1	Piston	Ass'y Only	PE-1400-AV
2	Quad Seal (PE-1401-AV)		
3	Spring Retainer		
4	Spring		
5	Wire Ring		
6	Spring Retainer . . . . .	1	PE-1402-AV
7	O-Ring . . . . .	1	PE-1403-AV
8	Clevis Pin . . . . .	1	PE-1404-AV
9	Snap Ring . . . . .	1	PE-1405-AV
10	O-Ring . . . . .	1	PE-1406-AV
11	Pressure Cap . . . . .	1	PE-1407-AV
12	Cap Screw . . . . .	4	PE-1408-AV

