



DUMP PUMP CONSOLE WITH AIR SHIFT PTO & PUMP

INSTALLATION INSTRUCTIONS AND SERVICE PARTS LIST

PART NUMBER: DPC-1-B

Warning: Leads to Fiber Optic Panel must be connected as shown or they will destroy the Back Lighting Panel!!

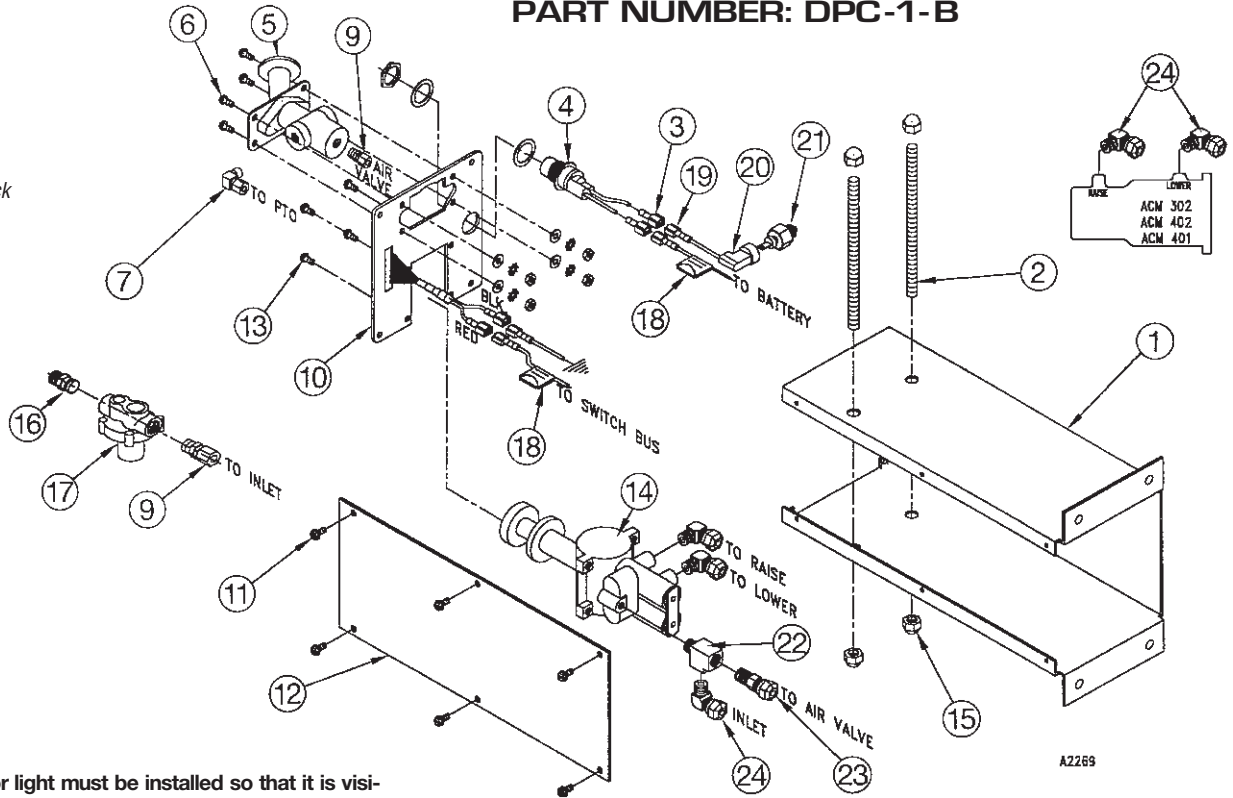

The PTO indicator light must be installed so that it is visible to the operator of the vehicle while seated in the driver's seat. Additional indicator lights may need to be purchased to comply with this requirement.

PARTS LIST AND DESCRIPTION

ITEM	QTY	PART NUMBER	DESCRIPTION
1	1	57T36653	Console Base
2	2	20M35844-7	Threaded Rod
3	2	PM-513A	Male Spade Connector
4*	1	32M12001	Indicator Light (12V)
5*	1	35M18653	PTO Air Shifter
6*	1	36MK1007	Shifter Bolt Kit
7*	2	44MB6942	90 Degree Tube Fitting
8*	2	45M44430	Air Tubing (30 ft)
9*	1	44MB6842	Tube Fitting
10	1	N/A	Console Face Plate
11	10	19T36355	Screw
12**	1	57T36654	Console Side Plate
13	4	19M52438	10-32 Allen Head Screw
14	1	1461-AM	Pump Air Shifter

ITEM	QTY	PART NUMBER	DESCRIPTION
15	4	22M35847	Acorn Nut
16*	1	44MB2164	Pipe Nipple
17*	1	31M15759	Pressure Valve
18*	2	33T36299	Fuse Assembly
19*	4	PM-514A	Female Spade Connector
20*	1	34MA1367	Booted Connector
21*	1	30M13003	PTO Indicator Switch (1&4)
		30M13004	PTO Indicator Switch (2&3)
22	1	44MB2252	Street Tee
23	1	44MB6842	1/8" NPT Straight Tube Adpt.
24	5	44MB6942	1/8" NPT 90° Tube Adpt.

NOTES: * These items are not included in this package (except for 1 Fuse Assy. Item 18). They are included with the Air Shift PTO.
** Item 12 should be assembled facing the dashboard.

N.S.	ACM-302	Air Cylinder Kit for E/EH Dump Pump
N.S.	ACM-402	Air Cylinder Kit for S2/S3 SA Hoist Pump
N.S.	ACM-401	Air Cylinder Kit for S4/S5 DA Hoist Pump
N.S.	60V-VAK	Air Cylinder Kit for 60/61V Series Valve
N.S.	90V-VAK	Air Cylinder Kit for 90/91V Series Valve

**ASSEMBLY
INSTRUCTIONS
ARE ON
REVERSE SIDE**

AIR SHIFT PTO INSTALLATION INSTRUCTIONS

- 1) We begin with the plumbing assembly [refer to the diagram above]. Tighten the 90° tube fitting (item 7) into the side of the PTO air shifter (item 5) and tighten the straight tube fitting (item 9) into the bottom of the PTO air shifter (item 5). Next, install the street tee adapter (item 22) into the supply port of the pump air shifter (item 14). On the pump air shifter (item 14) install the two 90° tube adapters (item 24) in the two output ports opposite the supply port as shown in drawing. Install the straight tube adapter (item 23) in the bottom of the street tee (item 22). Tighten the 90° tube adapter fitting (item 24) into the side on the street tee (item 22).
- 2) The PTO air shifter (item 5) will need to be installed in the console faceplate (item 10) from the top down. Use the bolts, washers, and nuts in the shifter bolt kit (item 6) to secure the PTO air shifter (item 5) to the console face plate (item 10). The pump air shifter (item 14) will need to be installed from the bottom up. Use the Allen head screws (item 13) to secure the pump air shifter (item 14) to the console face plate (item 10).
- 3) Cut a piece of air tubing (item 8) to fit between the straight tube adapter (item 23) on the PTO air shifter and the 90° tube adapter (item 24) on the street tee (item 22) installed on the pump air shifter (item 14). Cut the hose long enough for complete engagement on the fittings, but short enough to prevent a kink in the hose. Next, crimp on the 2 male spade connectors (item 3) to the 2 leads from the indicator light (item 4). Insert the indicator light (item 4) through the bottom of the face plate (item 10) and fasten tightly with a lock washer on each side as shown.
- 4) Align the mounting holes in the face plate (item 10) with the mounting holes in the top of the console base (item 1). The face plate (item 10) will only go on one way (fiber optic panel wires hanging closest to the opening). When aligned start the self threading screws (item 11) into the top of the console base (item 1). **Do not** tighten the face plate mounting screws (item 11) until all fasteners on the console have been tightened [*these (item 11) will be the last to be tightened*]. When the face plate (item 10) is located, slide the threaded rods (item 2) through the console base (item 1) and snug acorn nuts (item 15).
- 5) Route the plastic tubing from the pressure protection valve (item 17) to the 90° tube adapter (item 24) at the (supply) port of the pump air shifter (item 14). Route another length of tubing (item 8) from the PTO air shifter fitting (item 9) to the 90° tube adapter (item 23) on the PTO air shifter (item 5). Route a length of tubing (item 8) from each of the fittings on the pump air cylinder to the pump air shifter (item 14).
- 6) Now for the electrical assembly. Start by crimping on the four female spade connectors (item 19) to the wires leading up to the optical panel and to the indicator light (item 4). When attached, connect the indicator leads to the indicator light (item 4) and the back lighting leads to the optical panel.
- 7) Fasten the console side plate (item 12) to the console base (item 1) with the six mounting screws (item 11). Tighten firmly. Now, go back and tighten the four face plate mounting screws (item 11).



SP99-01 (Rev. 12-09) Printed in the U.S.A.
© Muncie Power Products, Inc. 2009

Muncie Power Products, Inc. Member of the Interpump Hydraulics Group
General Offices and Distribution Center • P.O. Box 548 • Muncie, IN 47308-0548
(765) 284-7721 • FAX (765) 284-6991 • E-mail info@munciepower.com
Web site <http://www.munciepower.com>

Drive Products, Exclusive Agents for Canada, ISO Certified by an Accredited Registrar

