

TITAN[®] MC1 SERIES

POWER TAKE-OFF



INCREASED LIFESPAN, UNCOMPROMISED RATING, GREATER ADVANTAGE

The first in the Titan[®] Class of power take-offs, the Titan MC1 Series is a medium-duty, 10-bolt mounting, clutch shift PTO. Designed to fit Allison 3000/4000 Series transmissions, the Titan MC1 showcases various product improvements including a robust clutch pack design, maximized gear design, internally pressure-lubricated tapered roller bearings for long life and an updated shift cover allowing 360-degree rotation for easier installation. Featuring a redesigned housing, the Titan MC1 Series allows for maximum clearance for installation on tight-fitting envelopes including Hino trucks.

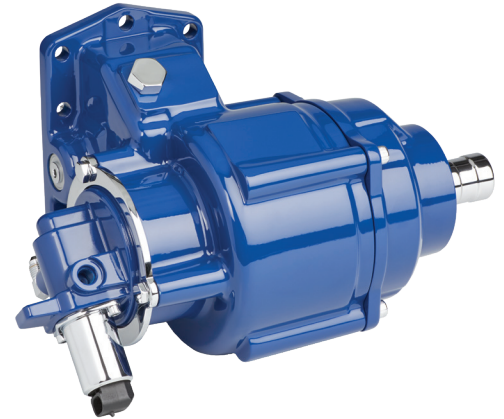

KEY FEATURES

- Increased clearance for easier access
- Unique shift cover allows 360-degree rotation
- Improved clutch pack design for increased life
- Improved tapered roller bearings increase life of PTO
- Increased input shaft diameter to increase life and durability
- Reduced leak paths
- Maximized gear design for improved life and noise reduction
- Pump flange rotation at 30-degree intervals
- Available with all options previously available on CS24/25 and HS24
- Self-adjusting shaft brake
- Single torque rating
- Compatible with Muncie Power's EX Drive shaft extension
- Available with **Muncie Start[®]** – an electronically controlled, modulated clutch engagement system that eliminates torque spikes upon start up for high inertia loads

PTO TORQUE & HORSEPOWER RATINGS

SPEED RATIO	INTERMITTENT/CONTINUOUS HP @ 1,000 RPM	INTERMITTENT/CONTINUOUS TORQUE LBS.FT.	INTERMITTENT (KW) @ 1,000 RPM	INTERMITTENT/CONTINUOUS TORQUE (NM)
05	77	400	(57)	(542)
06	77	400	(57)	(542)
07	79	415	(59)	(563)
08	69	360	(51)	(488)
09	65	340	(48)	(461)
10	59	310	(44)	(420)
11	52	275	(39)	(373)
12	50	265	(37)	(359)
15	39	205	(29)	(278)

Approximate Weight: 47.2 lbs. (21.4 Kg.)

DIMENSIONS

"3" Arrangement

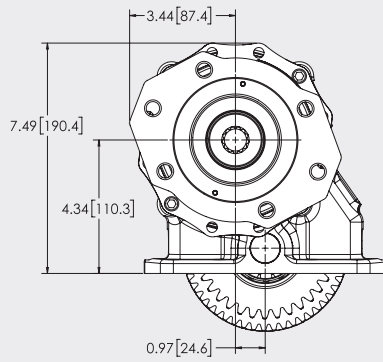

"5" Arrangement

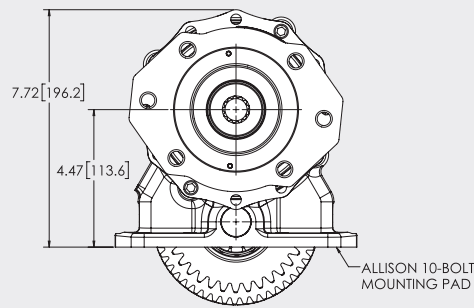

"1" Arrangement

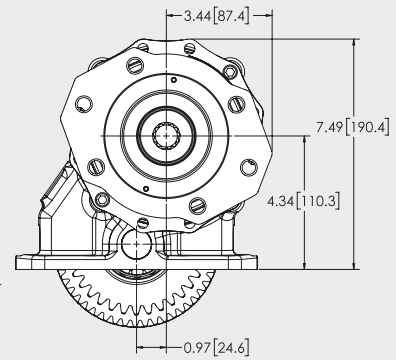

All Arrangements

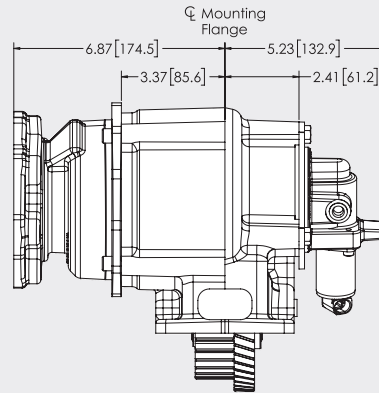

OUTPUT OPTIONS

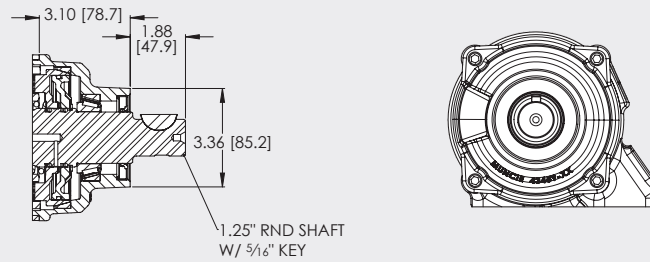

"1X" OUTPUT - 1/4" ROUND KEYED SHAFT

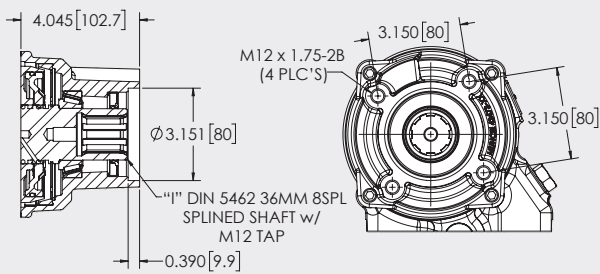

"2I" OUTPUT - DIN 5462 EURO WITH M12 TAP

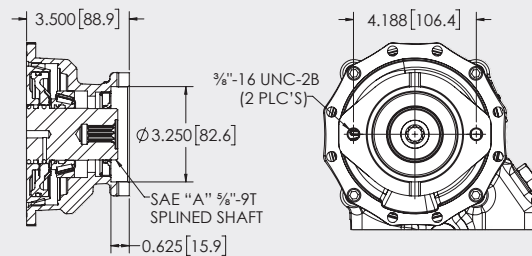

"AA" OUTPUT - SAE "A" 5/8" 9T SHAFT, 2-BOLT SAE-"A"

OUTPUT OPTIONS (CONT)

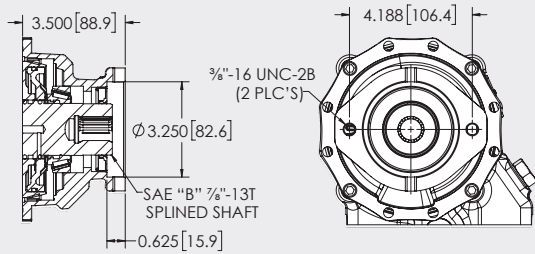

"BA" OUTPUT - SAE "B" 7/8" 13T, 2-BOLT FLANGE SAE-"A"

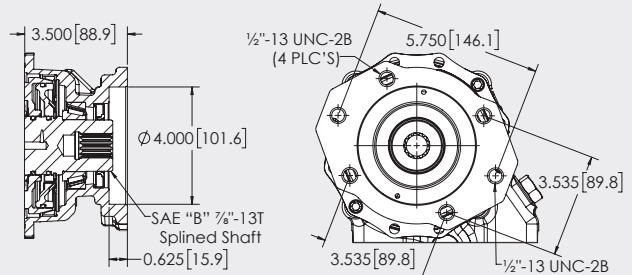

"BB" OUTPUT - SAE "B" 7/8" 13T, 2- & 4-BOLT SAE-"B"

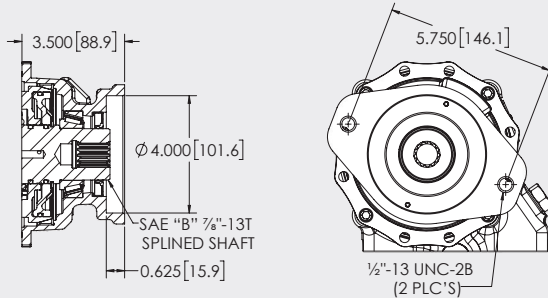

"BS" OUTPUT - SAE "B" 7/8"-13T SHAFT
 SAE "B" 2-BOLT

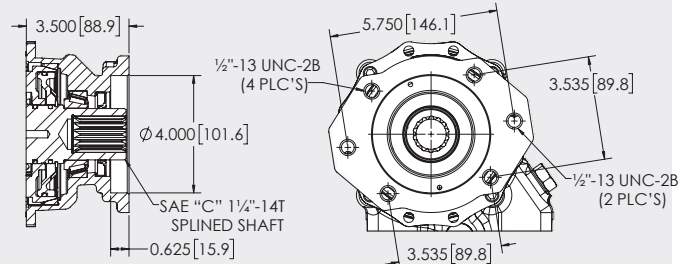

"CB" OUTPUT - SAE "C" 1 1/4"-14T, SAE "B"

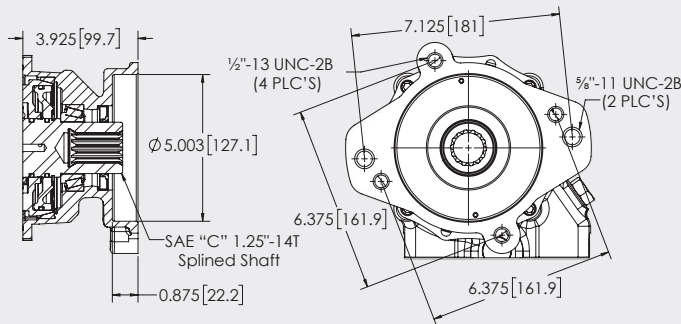

"CC" OUTPUT - SAE "C" 1 1/4"-14T, 2- & 4-BOLT SAE "C"

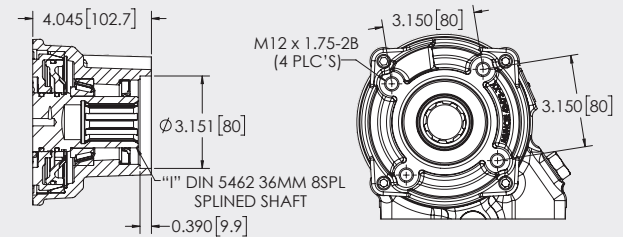

"II" OUTPUT - DIN 5462

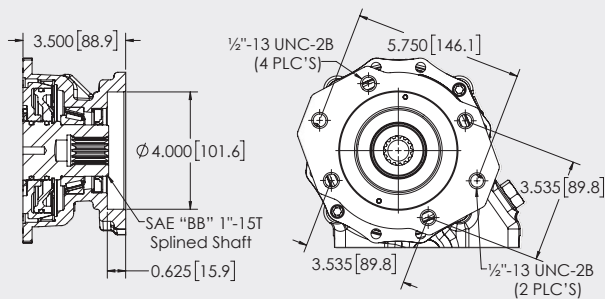

"PB" OUTPUT - SAE "BB" 1"-15T, 2- & 4-BOLT SAE "B"

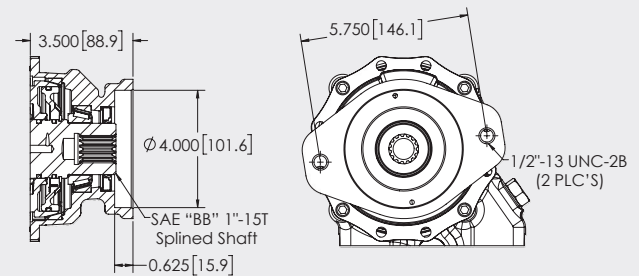

"PS" OUTPUT - SAE "BB" 1" 15T, 2-BOLT SAE-"B"

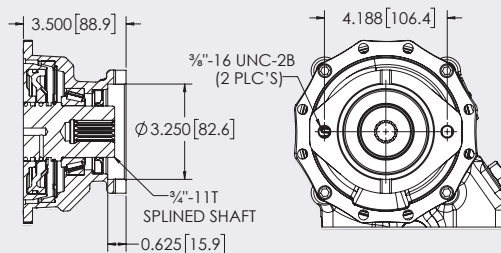

"TA" OUTPUT - SAE 3/4"-11T, 2-BOLT SAE "A"

OUTPUT OPTIONS (CONT)

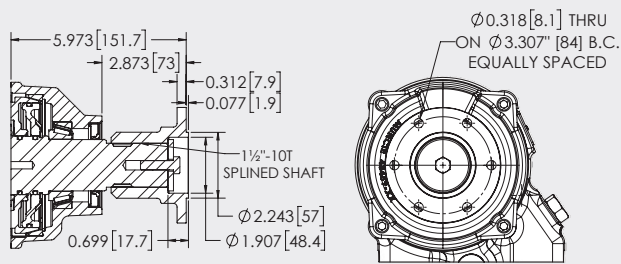

“X2” OUTPUT - 1½" 10T, DIN Companion Flange

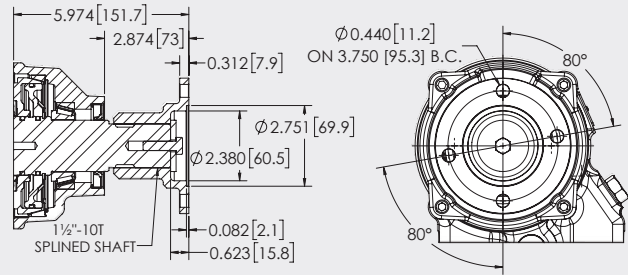

“X4” OUTPUT - 1½" 10T, 1410 Companion

MODEL NUMBER CONSTRUCTION

MC1-A10 07-HX 3 BB PX

Model

MC1 – Medium Duty Clutch Shift 10-Bolt

Transmission Gear

A10 – Allison 3000/4000 series

Ratio

05 – .54:1 Output Speed
 06 – .63:1
 07 – .73:1
 08 – .84:1
 09 – .90:1
 10 – .97:1
 11 – 1.11:1
 12 – 1.19:1
 15 – 1.48:1

Shift Type

HH – Elec/Hyd 12V Hino
 HX – Elec/Hyd 12V
 HR – Elec/Hyd 12V Remote Mount
 JX – Elec/Hyd 24V
 JR – Elec/Hyd 24V Remote Mount
 XP – Elec/Hyd Without Activation Components
 SX – Muncie Start® 12VDC Integral
 SR – Muncie Start® 12VDC Remote Mount

Assembly Arrangement

1 – Right Side Shaft Low
 3 – Left Side Shaft Low
 5 – Top/No Offset (Straight Out From Opening)

Special Features

PX – Standard Hose Kit
 BX – Hose Kit for Top Opening
 US – Pulse Generator & SPD-1001
 UX – Pulse Generator & Standard Hose Kit
 UB – Pulse Generator & Top Hose Kit
 XX – Hose Delete Kit
 PW – Wet Spline & Standard Hose Kit

Output Type

1X – 1¼" Round Shaft
 2I – DIN 5462 Euro
 AA – SAE "A" 5/8" 9T, 2-Bolt SAE-"A"
 BA – SAE "B" 7/8" 13T, 2-Bolt SAE-"A"
 BB – SAE "B" 7/8" 13T, 2- & 4-Bolt SAE-"B"
 BS – SAE "B" 7/8" 13T, 2-Bolt SAE-"B"
 CB – SAE "C" 1¼" 14T, SAE-"B"
 CC – SAE "C" 1¼" 14T, 2- & 4-Bolt SAE-"C"
 II – DIN 5462
 PB – SAE "BB" 1" 15T 2- & 4-Bolt SAE-"B"
 PS – SAE "BB" 1" 15T 2-Bolt SAE-"B"
 TA – SAE ¾" 11T, 2-Bolt SAE-"A"
 X2 – 1½" 10T, DIN Companion
 X4 – 1½" 10T Male, 1410 Companion